

Pensacola Beach Gulf Snorkeling Reef



PENSACOLA BEACH PARK EAST SNORKEL REEF



Legend
— STREET
■ GULF SNORKEL REEF

400 200 0 400 Feet

This map was prepared by the Escambia County GIS Division and is provided as an informational product only. It is not intended for professional or commercial use and is not a substitute for professional services. The information contained herein is provided "as is" without warranty of any kind, either expressed or implied. The user assumes all responsibility for any errors or omissions in this map. The data on this map is derived from the Escambia County GIS Division. The data on this map is derived from the Escambia County GIS Division. The data on this map is derived from the Escambia County GIS Division.



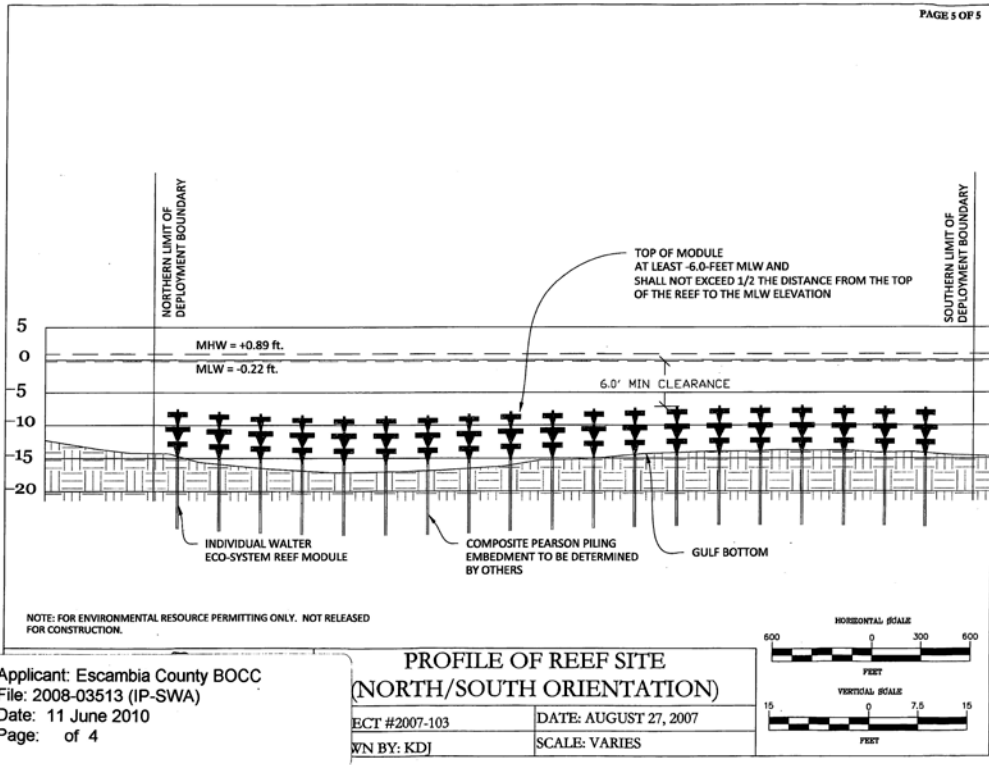

Applicant: Escambia County BOCC
 File: 2008-03513 (IP-SWA)
 Date: 11 June 2010
 Page: of 4

**PROFILE OF REEF SITE
 (NORTH/SOUTH ORIENTATION)**

PROJECT #2007-103	DATE: AUGUST 27, 2007
DRAWN BY: KDJ	SCALE: VARIES

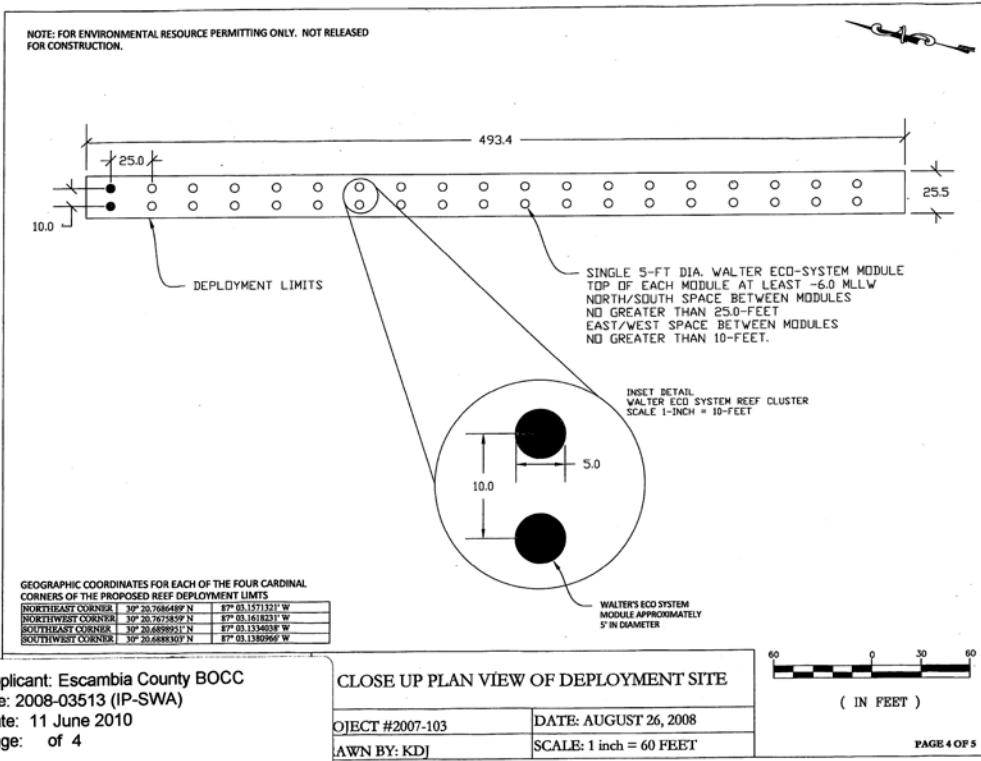

Applicant: Escambia County BOCC
 File: 2008-03513 (IP-SWA)
 Date: 11 June 2010
 Page: of 4

CLOSE UP PLAN VIEW OF DEPLOYMENT SITE

PROJECT #2007-103	DATE: AUGUST 26, 2008
DRAWN BY: KDJ	SCALE: 1 inch = 60 FEET

GEOGRAPHIC COORDINATES FOR EACH OF THE FOUR CARDINAL CORNERS OF THE PROPOSED REEF DEPLOYMENT LIMITS

NORTHEAST CORNER	30° 20.7686489' N	87° 03.1571321' W
NORTHWEST CORNER	30° 20.7678859' N	87° 03.1618631' W
SOUTHEAST CORNER	30° 20.6889951' N	87° 03.1340259' W
SOUTHWEST CORNER	30° 20.6888309' N	87° 03.1380960' W

To assist locating the Gulf Snorkeling Reefs, Escambia County has installed Range Markers.



To find reefs, line up Range Markers and swim offshore approximately 450 feet to a water depth of 14 feet. Top of reefs are approximately 9 feet below water surface.

