



BOARD OF COUNTY COMMISSIONERS
ESCAMBIA COUNTY, FLORIDA
ENGINEERING DEPARTMENT

SIGNING AND PAVEMENT MARKING PLANS
FOR WEST KINGSFIELD ROAD EXTENSION

INDEX OF SIGNING AND
PAVEMENT MARKING PLANS

SHEET NO.	SHEET DESCRIPTION
S-1	KEY SHEET
S-2 - S-4	TABULATION OF QUANTITIES
S-5 - S-20	SIGNING & PAVEMENT MARKING PLANS

ESCAMBIA COUNTY COMMISSIONERS

JEFF BERGOSH	DISTRICT 1
DOUG UNDERHILL	DISTRICT 2
LUMON MAY	DISTRICT 3
ROBERT BENDER, VICE CHAIRMAN	DISTRICT 4
STEVEN BARRY, CHAIRMAN	DISTRICT 5

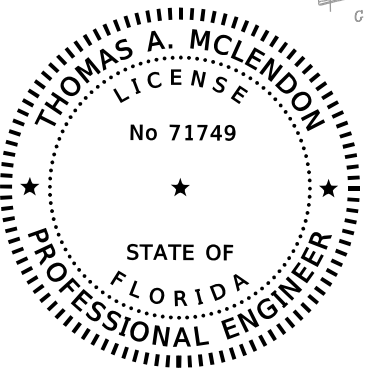
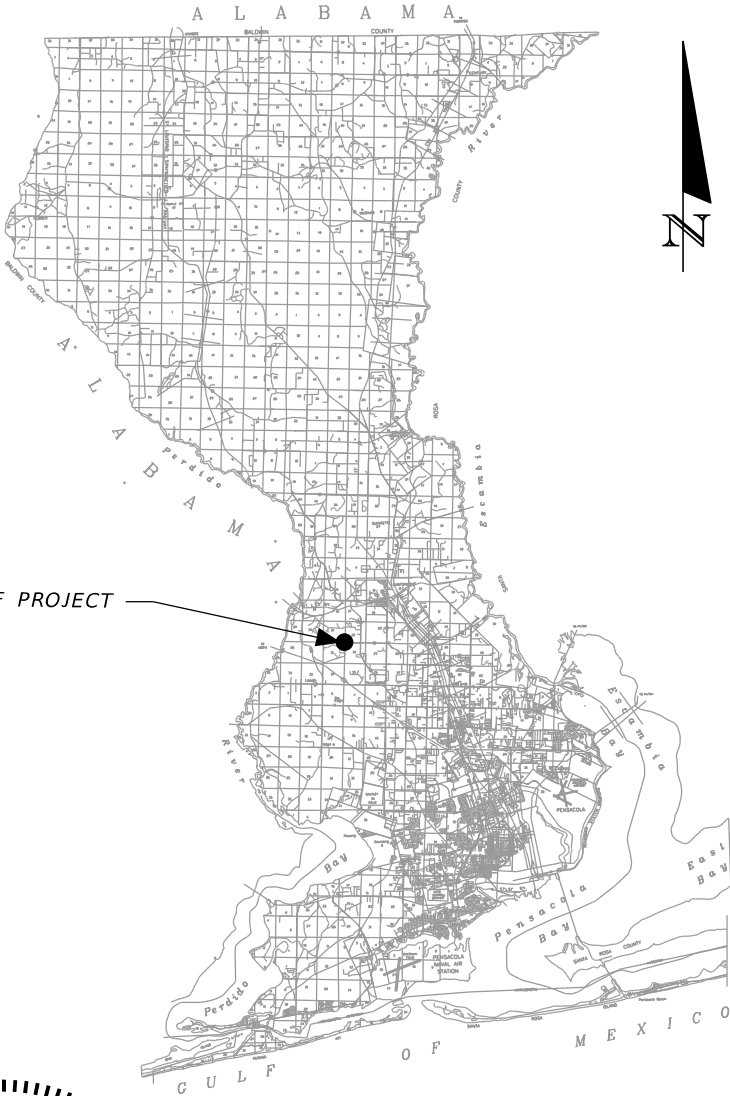

THIS ITEM HAS BEEN DIGITALLY
SIGNED AND SEALED BY:

ON THE DATE ADJACENT TO THE SEAL.

PRINTED COPIES OF THIS DOCUMENT ARE
NOT CONSIDERED SIGNED AND SEALED
AND THE SIGNATURE MUST BE VERIFIED
ON ANY ELECTRONIC COPIES.

SIGNING AND
PAVEMENT MARKING PLANS
ENGINEER OF RECORD:

THOMAS A. MCLENDON, P.E.
P.E. NO. 71749
MOTT MACDONALD
220 WEST GARDEN STREET, SUITE 700
PENSACOLA, FLORIDA 32502
(850) 484-6011
CERTIFICATE OF AUTHORIZATION NO. 0155

ESCAMBIA COUNTY PROJECT MANAGER:
ELIZABETH BUSH
(850) 595-3450

PRELIMINARY, SUBJECT TO CHANGE
INTERIM 60% PLANS, DEC. 6, 2019

SHEET
NO.

S-1

TABULATION OF QUANTITIES																					
PAY ITEM NO.	DESCRIPTION	UNIT	SHEET NUMBERS														TOTAL THIS SHEET				
			S - 5		S - 6		S - 7		S - 8		S - 9		S - 10		S - 11						
			PLAN	FINAL	PLAN	FINAL	PLAN	FINAL	PLAN	FINAL	PLAN	FINAL	PLAN	FINAL	PLAN	FINAL	PLAN	FINAL			
700-1-11	Single Post Sign, F&I Ground Mount, Up to 12 SF	AS																			
700-1-12	Single Post Sign, F&I Ground Mount, 12-20 SF	AS																			
700-1-50	Single Post Sign, Relocate	AS																			
700-1-60	Single Post Sign, Remove	AS																			
700-2-60	Multi-Post Sign, Remove	AS																			
700-3-501	Sign Panel, Relocate, Up to 12 SF	EA																			
705-10-4	Object Marker, Type 4	EA																			
710-90	Final Pavement Markings	LS																			
*	Retro-Reflective Pavement Markers (TOTAL)	EA																			
*	Retro-Reflective Pavement Markers (W/R)	EA																			
*	Retro-Reflective Pavement Markers (Y/Y)	EA																			
*	Painted Pavement Markings, Std., White, Solid, 6"	GM																			
*	Painted Pavement Markings, Std., White, Solid, Crosswalk And Roundabout, 12"	LF																			
*	Painted Pavement Markings, Std., White, Solid, Stop Lines, 24"	LF																			
*	Painted Pavement Markings, Std., White, 2-4 Dotted Guide Line, 6"	GM																			
*	Painted Pavement Markings, Std., Arrows	EA																			
*	Painted Pavement Markings, Std., Yellow, Solid, 6"	GM																			
711-11-123	Thermoplastic, Std., White, Solid, Crosswalk And Roundabout, 12"	LF																			
711-11-125	Thermoplastic, Std., White, Solid, Stop Line, 24"	LF																			
711-11-141	Thermoplastic, Std., White, 2-4 Dotted Guide Line, 6"	GM																			
711-11-170	Thermoplastic, Std., White, Arrows	EA																			
711-14-160	Thermoplastic, Preformed, White, Message (Bike)	EA																			
711-14-170	Thermoplastic, Preformed, White, Arrow (Bike Thru)	EA																			
711-16-101	Thermoplastic, Std. - Other Surfaces, White, Solid, 6"	GM																			
711-16-201	Thermoplastic, Std. - Other Surfaces, Yellow, Solid, 6"	GM																			

* THESE QUANTITIES ARE PAID FOR UNDER PAINTED PAVEMENT MARKINGS (FINAL SURFACE), LUMP SUM - ITEM NO. 710-90. THE QUANTITIES SHOWN ARE FOR ONE APPLICATION; SEE SPECIFICATION 710 FOR THE NUMBER OF APPLICATIONS REQUIRED

LEGEND

Y/Y RPMs = Bidirectional Yellow/Yellow RPMs
W/R RPMs = Bidirectional White/Red RPMs

REVISIONS				THOMAS A. MCLENDON, P.E. P.E. LICENSE NUMBER 71749 MOTT MACDONALD FLORIDA, LLC 220 WEST GARDEN STREET, SUITE 700 PENSACOLA, FL 32502 CERTIFICATE OF AUTHORIZATION 155	BOARD OF COUNTY COMMISSIONERS ESCAMBIA COUNTY, FLORIDA			TABULATION OF QUANTITIES		SHEET NO.
DATE	DESCRIPTION	DATE	DESCRIPTION		ROAD NO.	COUNTY	FINANCIAL PROJECT ID			
	PRELIMINARY, SUBJECT TO CHANGE INTERIM 60% PLANS, DEC. 6, 2019				KINGSFIELD	ESCAMBIA				
										S-2

TABULATION OF QUANTITIES																					
PAY ITEM NO.	DESCRIPTION	UNIT	SHEET NUMBERS														TOTAL THIS SHEET				
			S - 12		S - 13		S - 14		S - 15		S - 16		S - 17		S - 18						
			PLAN	FINAL	PLAN	FINAL	PLAN	FINAL	PLAN	FINAL	PLAN	FINAL	PLAN	FINAL	PLAN	FINAL	PLAN	FINAL			
700-1-11	Single Post Sign, F&I Ground Mount, Up to 12 SF	AS																			
700-1-12	Single Post Sign, F&I Ground Mount, 12-20 SF	AS																			
700-1-50	Single Post Sign, Relocate	AS																			
700-1-60	Single Post Sign, Remove	AS																			
700-2-60	Multi-Post Sign, Remove	AS																			
700-3-501	Sign Panel, Relocate, Up to 12 SF	EA																			
705-10-4	Object Marker, Type 4	EA																			
710-90	Final Pavement Markings	LS																			
*	Retro-Reflective Pavement Markers (TOTAL)	EA																			
*	Retro-Reflective Pavement Markers (W/R)	LS																			
*	Retro-Reflective Pavement Markers (Y/Y)	EA																			
*	Painted Pavement Markings, Std., White, Solid, 6"	GM																			
*	Painted Pavement Markings, Std., White, Solid, Crosswalk And Roundabout, 12"	LF																			
*	Painted Pavement Markings, Std., White, Solid, Stop Lines, 24"	LF																			
*	Painted Pavement Markings, Std., White, 2-4 Dotted Guide Line, 6"	GM																			
*	Painted Pavement Markings, Std., Arrows	EA																			
*	Painted Pavement Markings, Std., Yellow, Solid, 6"	GM																			
711-11-123	Thermoplastic, Std., White, Solid, Crosswalk And Roundabout, 12"	LF																			
711-11-125	Thermoplastic, Std., White, Solid, Stop Line, 24"	LF																			
711-11-141	Thermoplastic, Std., White, 2-4 Dotted Guide Line, 6"	GM																			
711-11-170	Thermoplastic, Std., White, Arrows	EA																			
711-14-160	Thermoplastic, Preformed, White, Message (Bike)	EA																			
711-14-170	Thermoplastic, Preformed, White, Arrow (Bike Thru)	EA																			
711-16-101	Thermoplastic, Std. - Other Surfaces, White, Solid, 6"	GM																			
711-16-201	Thermoplastic, Std. - Other Surfaces, Yellow, Solid, 6"	GM																			

* THESE QUANTITIES ARE PAID FOR UNDER PAINTED PAVEMENT MARKINGS (FINAL SURFACE), LUMP SUM - ITEM NO. 710-90. THE QUANTITIES SHOWN ARE FOR ONE APPLICATION; SEE SPECIFICATION 710 FOR THE NUMBER OF APPLICATIONS REQUIRED.

REVISIONS				THOMAS A. MCLENDON, P.E. P.E. LICENSE NUMBER 71749 MOTT MACDONALD FLORIDA, LLC 220 WEST GARDEN STREET, SUITE 700 PENSACOLA, FL 32502 CERTIFICATE OF AUTHORIZATION 155	BOARD OF COUNTY COMMISSIONERS ESCAMBIA COUNTY, FLORIDA			TABULATION OF QUANTITIES		SHEET NO.
DATE	DESCRIPTION	DATE	DESCRIPTION		ROAD NO.	COUNTY	FINANCIAL PROJECT ID			
	PRELIMINARY, SUBJECT TO CHANGE INTERIM 60% PLANS, DEC. 6, 2019				KINGSFIELD	ESCAMBIA				
										S-3

THE OFFICIAL RECORD OF THIS SHEET IS THE ELECTRONIC FILE DIGITALLY SIGNED AND SEALED UNDER RULE 61G15-23.004, F.A.C.

TABULATION OF QUANTITIES																					
PAY ITEM NO.	DESCRIPTION	UNIT	SHEET NUMBERS														TOTAL THIS SHEET		GRAND TOTAL		
			S - 19		S - 20																
			PLAN	FINAL	PLAN	FINAL	PLAN	FINAL	PLAN	FINAL	PLAN	FINAL	PLAN	FINAL	PLAN	FINAL	PLAN	FINAL	PLAN	FINAL	
700-1-11	Single Post Sign, F&I Ground Mount, Up to 12 SF	AS																			
700-1-12	Single Post Sign, F&I Ground Mount, 12-20 SF	AS																			
700-1-50	Single Post Sign, Relocate	AS																			
700-1-60	Single Post Sign, Remove	AS																			
700-2-60	Multi-Post Sign, Remove	AS																			
700-3-501	Sign Panel, Relocate, Up to 12 SF	EA																			
705-10-4	Object Marker, Type 4	EA																			
710-90	Final Pavement Markings	LS																			
*	Retro-Reflective Pavement Markers (TOTAL)	EA																			
*	Retro-Reflective Pavement Markers (W/R)	LS																			
*	Retro-Reflective Pavement Markers (Y/Y)	EA																			
*	Painted Pavement Markings, Std., White, Solid, 6"	GM																			
*	Painted Pavement Markings, Std., White, Solid, Crosswalk And Roundabout, 12"	LF																			
*	Painted Pavement Markings, Std., White, Solid, Stop Lines, 24"	LF																			
*	Painted Pavement Markings, Std., White, 2-4 Dotted Guide Line, 6"	GM																			
*	Painted Pavement Markings, Std., Arrows	EA																			
*	Painted Pavement Markings, Std., Yellow, Solid, 6"	GM																			
711-11-123	Thermoplastic, Std., White, Solid, Crosswalk And Roundabout, 12"	LF																			
711-11-125	Thermoplastic, Std., White, Solid, Stop Line, 24"	LF																			
711-11-141	Thermoplastic, Std., White, 2-4 Dotted Guide Line, 6"	GM																			
711-11-170	Thermoplastic, Std., White, Arrows	EA																			
711-14-160	Thermoplastic, Preformed, White, Message (Bike)	EA																			
711-14-170	Thermoplastic, Preformed, White, Arrow (Bike Thru)	EA																			
711-16-101	Thermoplastic, Std. - Other Surfaces, White, Solid, 6"	GM																			
711-16-201	Thermoplastic, Std. - Other Surfaces, Yellow, Solid, 6"	GM																			
* THESE QUANTITIES ARE PAID FOR UNDER PAINTED PAVEMENT MARKINGS (FINAL SURFACE), LUMP SUM - ITEM NO. 710-90. THE QUANTITIES SHOWN ARE FOR ONE APPLICATION; SEE SPECIFICATION 710 FOR THE NUMBER OF APPLICATIONS REQUIRED.																					
REVISIONS				THOMAS A. MCLENDON, P.E. P.E. LICENSE NUMBER 71749 MOTT MACDONALD FLORIDA, LLC 220 WEST GARDEN STREET, SUITE 700 PENSACOLA, FL 32502 CERTIFICATE OF AUTHORIZATION 155					BOARD OF COUNTY COMMISSIONERS ESCAMBIA COUNTY, FLORIDA			TABULATION OF QUANTITIES					SHEET NO.				
DATE	DESCRIPTION		DATE						DESCRIPTION		ROAD NO.						COUNTY	FINANCIAL PROJECT ID			
	PRELIMINARY, SUBJECT TO CHANGE INTERIM 60% PLANS, DEC. 6, 2019										KINGSFIELD						ESCAMBIA				

CURVE DATA ALT07_7
PI STA. = 751+11.91
Δ = 89° 10' 29" (LT)
D = 4° 59' 59"
T = 1,129.61
L = 1,783.62
R = 1,146.00
PC STA. = 739+82.31
PT STA. = 757+65.93

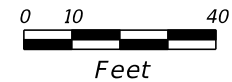

BEGIN SIGNING AND PAVEMENT MARKINGS
116+50.00

STA. 116+37.29 Q =
STA. 747+07.64 Q ALT07_7



R1-1
36"x36"
STA. 116+50
700-1-11

+50.00
+37.29

117

118

119

119+40.00

Q CONST.

DBL. 6" YELLOW W/ DBL.
Y/Y RPMs @ 40' SPACING

6" WHITE

PC STA. 116+37.29

R/W

LEGEND
Y/Y = YELLOW/YELLOW RPM
W/R = WHITE/RED RPM

REVISIONS				THOMAS A. MCLENDON, P.E. P.E. LICENSE NUMBER 71749 MOTT MACDONALD FLORIDA, LLC 220 WEST GARDEN STREET, SUITE 700 PENSACOLA, FL 32502 CERTIFICATE OF AUTHORIZATION 155	BOARD OF COUNTY COMMISSIONERS ESCAMBIA COUNTY, FLORIDA			SIGNING AND PAVEMENT MARKING PLANS		SHEET NO. S-5
DATE	DESCRIPTION	DATE	DESCRIPTION		ROAD NO.	COUNTY	FINANCIAL PROJECT ID			
	PRELIMINARY, SUBJECT TO CHANGE INTERIM 60% PLANS, DEC. 6, 2019				KINGSFIELD	ESCAMBIA				

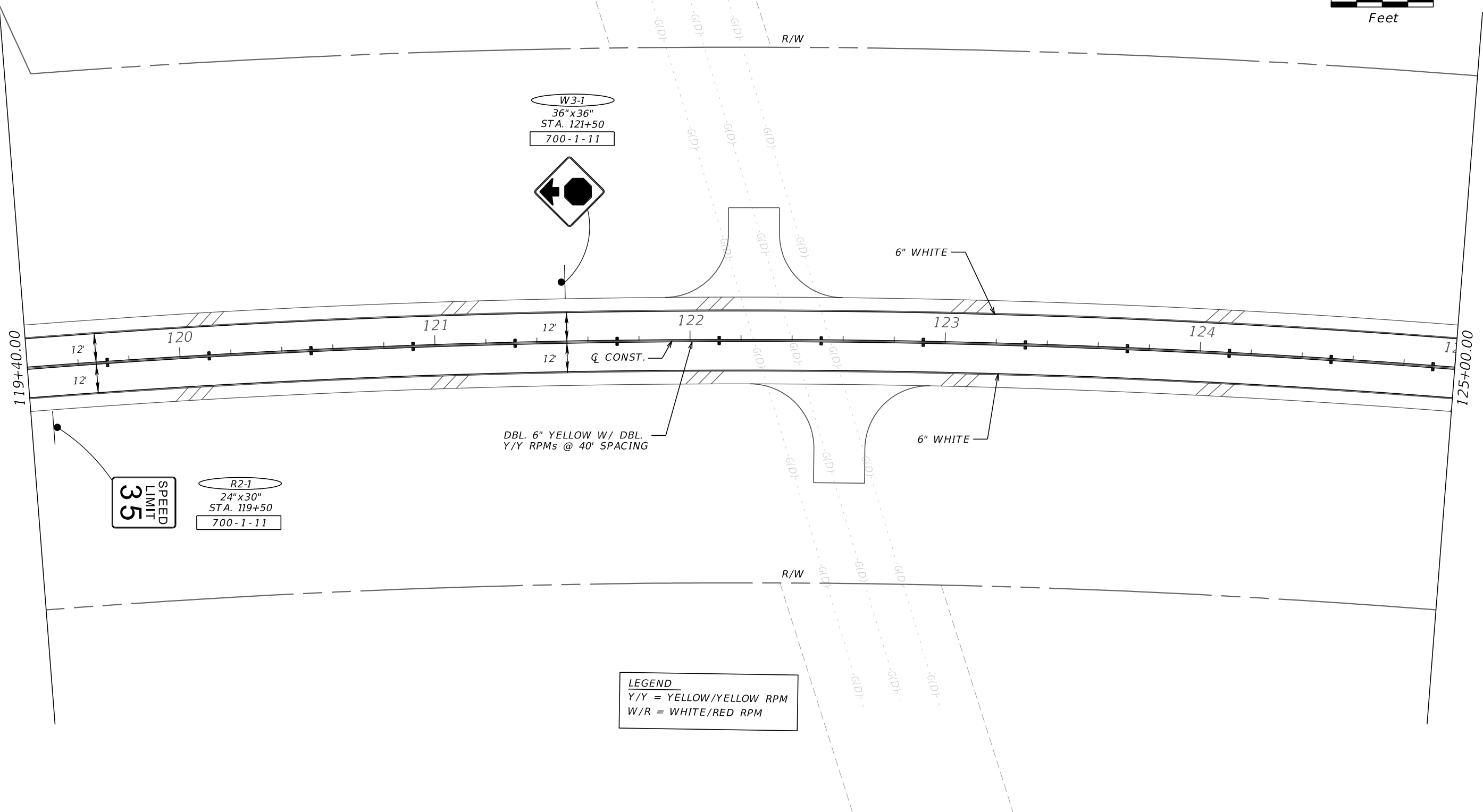
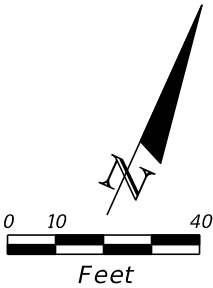

LEGEND
Y/Y = YELLOW/YELLOW RPM
W/R = WHITE/RED RPM

REVISIONS				THOMAS A. MCLENDON, P.E. P.E. LICENSE NUMBER 71749 MOTT MACDONALD FLORIDA, LLC 220 WEST GARDEN STREET, SUITE 700 PENSACOLA, FL 32502 CERTIFICATE OF AUTHORIZATION 155	BOARD OF COUNTY COMMISSIONERS ESCAMBIA COUNTY, FLORIDA			SIGNING AND PAVEMENT MARKING PLANS		SHEET NO. S-6
DATE	DESCRIPTION	DATE	DESCRIPTION		ROAD NO.	COUNTY	FINANCIAL PROJECT ID			
	PRELIMINARY, SUBJECT TO CHANGE INTERIM 60% PLANS, DEC. 6, 2019				KINGSFIELD	ESCAMBIA				

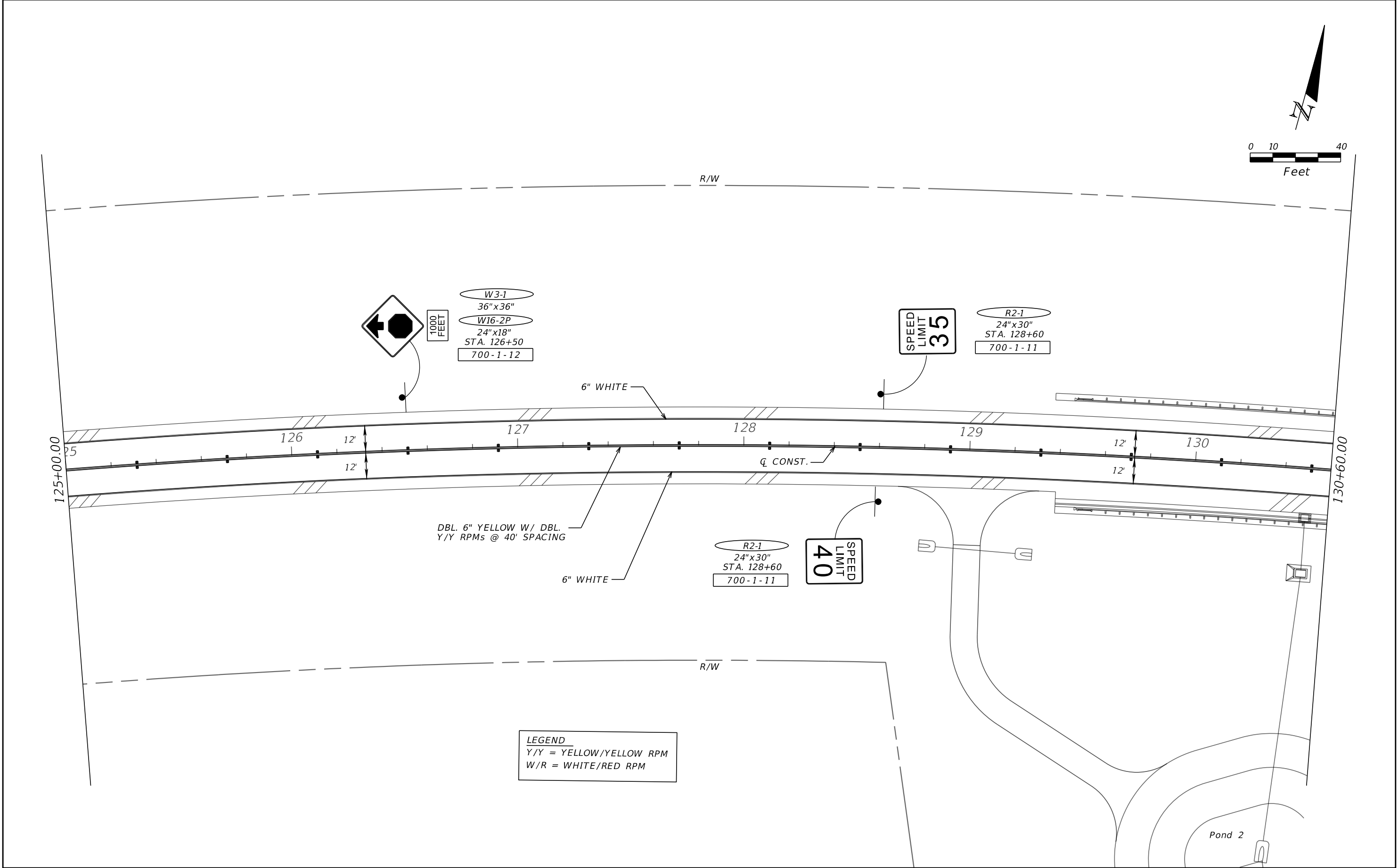

REVISIONS				THOMAS A. MCLENDON, P.E. P.E. LICENSE NUMBER 71749 MOTT MACDONALD FLORIDA, LLC 220 WEST GARDEN STREET, SUITE 700 PENSACOLA, FL 32502 CERTIFICATE OF AUTHORIZATION 155	BOARD OF COUNTY COMMISSIONERS ESCAMBIA COUNTY, FLORIDA			SIGNING AND PAVEMENT MARKING PLANS		SHEET NO. S-7
DATE	DESCRIPTION	DATE	DESCRIPTION		ROAD NO.	COUNTY	FINANCIAL PROJECT ID			
	PRELIMINARY, SUBJECT TO CHANGE INTERIM 60% PLANS, DEC. 6, 2019				KINGSFIELD	ESCAMBIA				

THE OFFICIAL RECORD OF THIS SHEET IS THE ELECTRONIC FILE DIGITALLY SIGNED AND SEALED UNDER RULE 61G15-23.004, F.A.C.

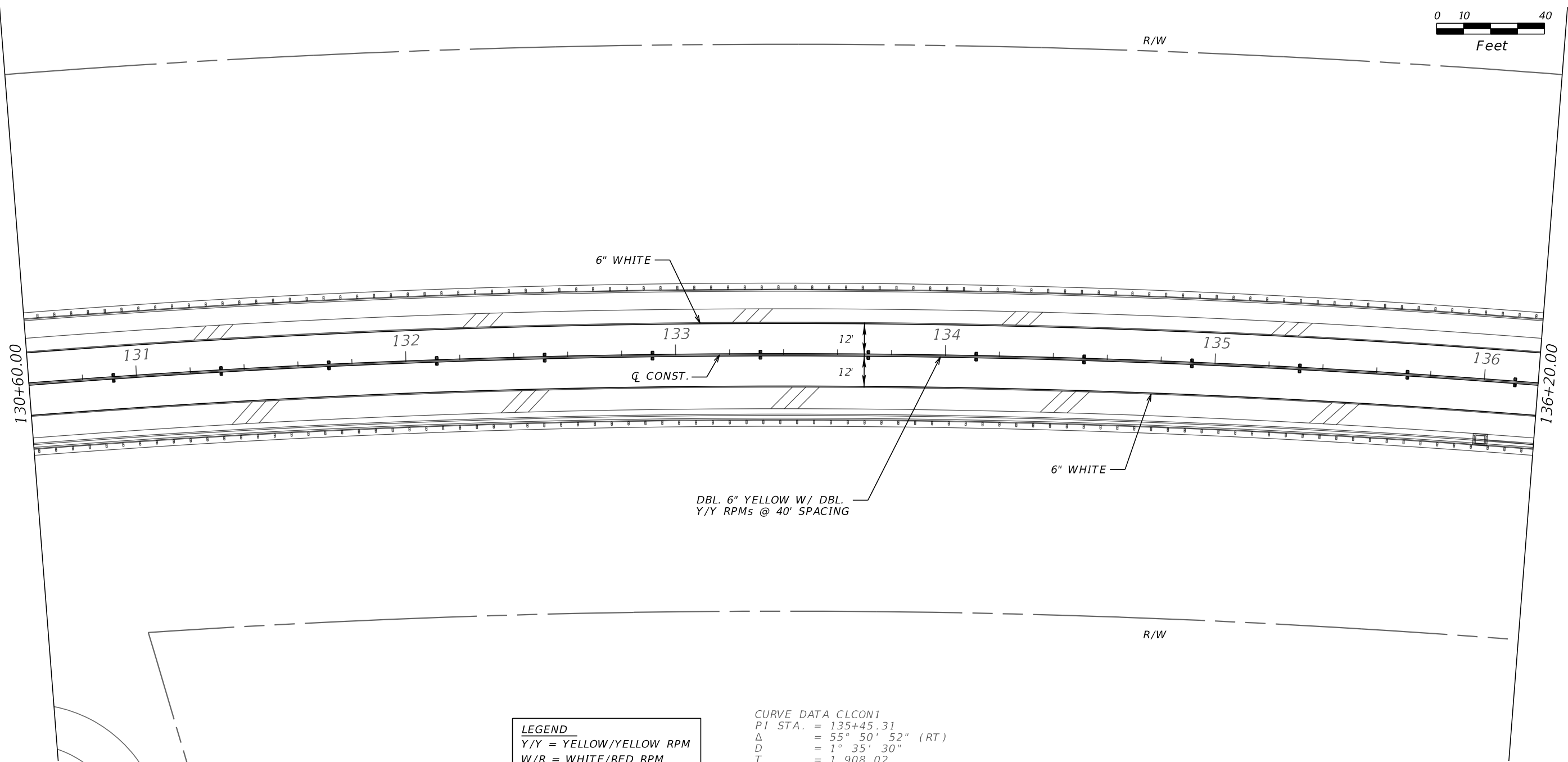
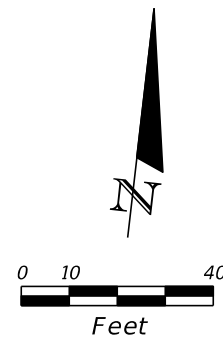

LEGEND
Y/Y = YELLOW/YELLOW RPM
W/R = WHITE/RED RPM

CURVE DATA CLCON1
PI STA. = 135+45.31
Δ = 55° 50' 52" (RT)
D = 1° 35' 30"
T = 1,908.02
L = 3,509.02
R = 3,600.00
PC STA. = 116+37.29
PT STA. = 151+46.31

REVISIONS				THOMAS A. MCLENDON, P.E. P.E. LICENSE NUMBER 71749 MOTT MACDONALD FLORIDA, LLC 220 WEST GARDEN STREET, SUITE 700 PENSACOLA, FL 32502 CERTIFICATE OF AUTHORIZATION 155	BOARD OF COUNTY COMMISSIONERS ESCAMBIA COUNTY, FLORIDA			SIGNING AND PAVEMENT MARKING PLANS	SHEET NO.
DATE	DESCRIPTION	DATE	DESCRIPTION		ROAD NO.	COUNTY	FINANCIAL PROJECT ID		S-8
	PRELIMINARY, SUBJECT TO CHANGE INTERIM 60% PLANS, DEC. 6, 2019				KINGSFIELD	ESCAMBIA			

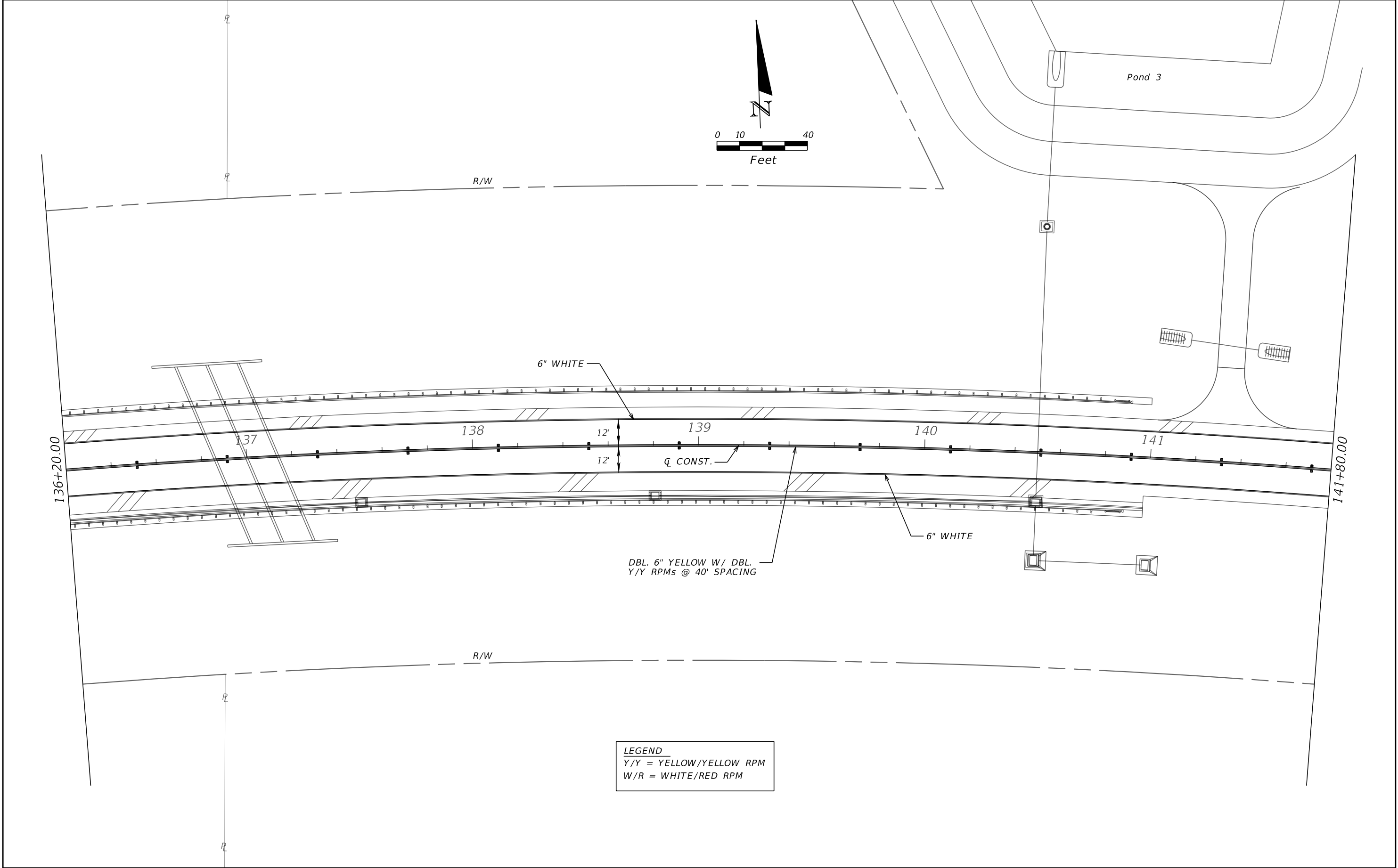

REVISIONS				THOMAS A. MCLENDON, P.E. P.E. LICENSE NUMBER 71749 MOTT MACDONALD FLORIDA, LLC 220 WEST GARDEN STREET, SUITE 700 PENSACOLA, FL 32502 CERTIFICATE OF AUTHORIZATION 155	BOARD OF COUNTY COMMISSIONERS ESCAMBIA COUNTY, FLORIDA			SIGNING AND PAVEMENT MARKING PLANS	SHEET NO.
DATE	DESCRIPTION	DATE	DESCRIPTION		ROAD NO.	COUNTY	FINANCIAL PROJECT ID		S-9
	PRELIMINARY, SUBJECT TO CHANGE INTERIM 60% PLANS, DEC. 6, 2019				KINGSFIELD	ESCAMBIA			

THE OFFICIAL RECORD OF THIS SHEET IS THE ELECTRONIC FILE DIGITALLY SIGNED AND SEALED UNDER RULE 61G15-23.004, F.A.C.

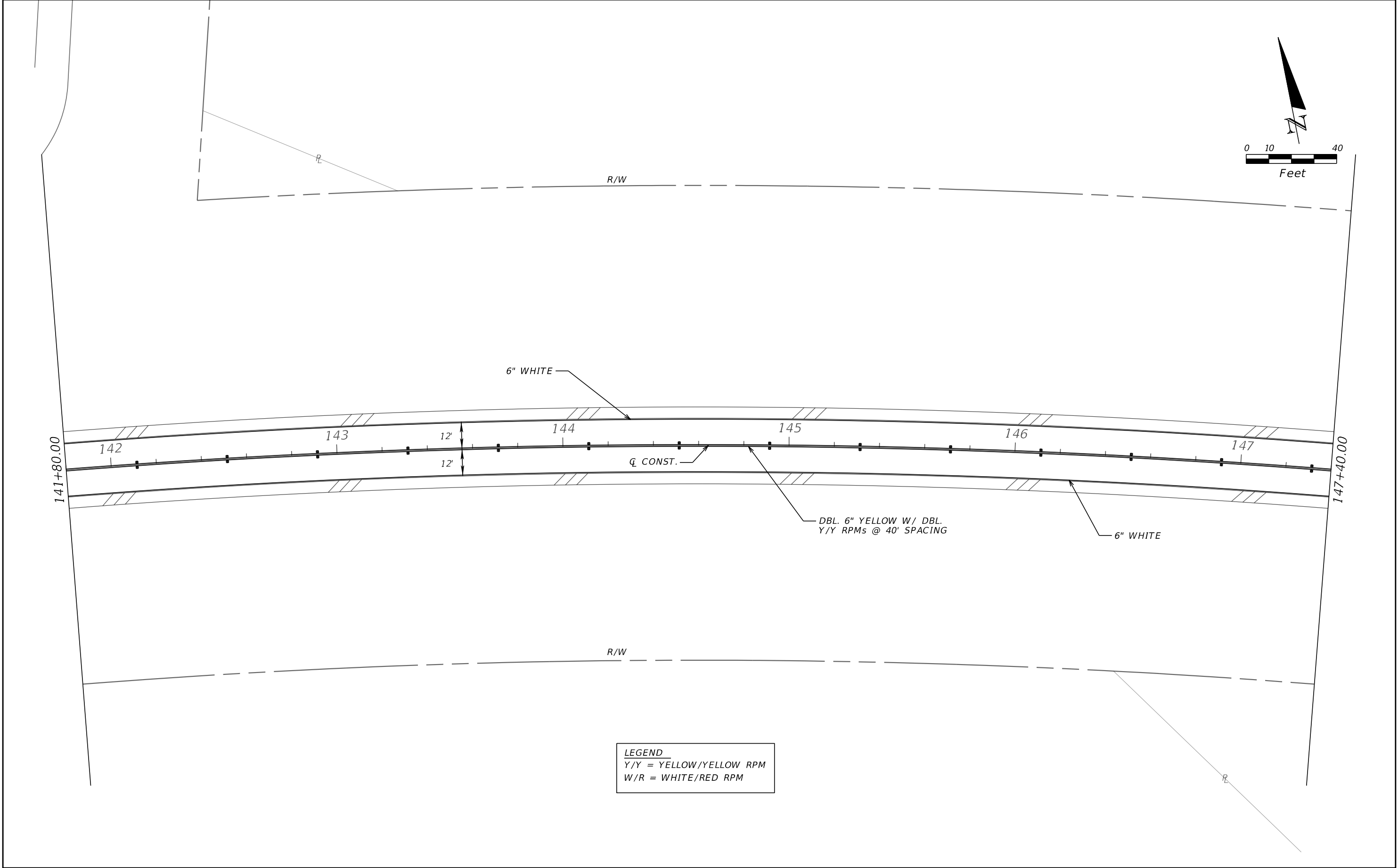

REVISIONS				THOMAS A. MCLENDON, P.E. P.E. LICENSE NUMBER 71749 MOTT MACDONALD FLORIDA, LLC 220 WEST GARDEN STREET, SUITE 700 PENSACOLA, FL 32502 CERTIFICATE OF AUTHORIZATION 155	BOARD OF COUNTY COMMISSIONERS ESCAMBIA COUNTY, FLORIDA			SIGNING AND PAVEMENT MARKING PLANS	SHEET NO.
DATE	DESCRIPTION	DATE	DESCRIPTION		ROAD NO.	COUNTY	FINANCIAL PROJECT ID		S-10
	PRELIMINARY, SUBJECT TO CHANGE INTERIM 60% PLANS, DEC. 6, 2019				KINGSFIELD	ESCAMBIA			

THE OFFICIAL RECORD OF THIS SHEET IS THE ELECTRONIC FILE DIGITALLY SIGNED AND SEALED UNDER RULE 61G15-23.004, F.A.C.

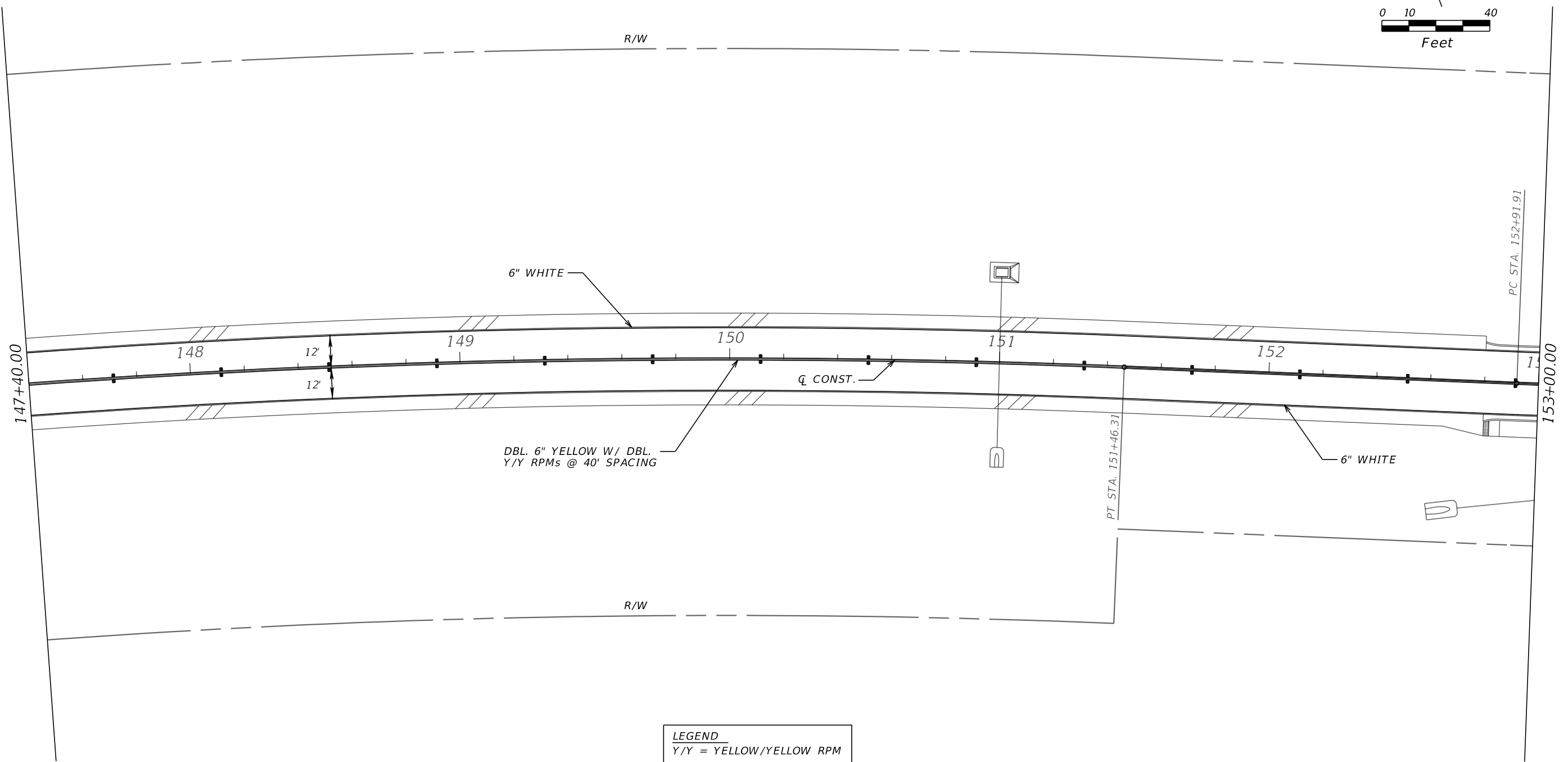
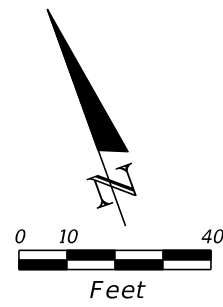

LEGEND
Y/Y = YELLOW/YELLOW RPM
W/R = WHITE/RED RPM

REVISIONS				THOMAS A. MCLENDON, P.E. P.E. LICENSE NUMBER 71749 MOTT MACDONALD FLORIDA, LLC 220 WEST GARDEN STREET, SUITE 700 PENSACOLA, FL 32502 CERTIFICATE OF AUTHORIZATION 155	BOARD OF COUNTY COMMISSIONERS ESCAMBIA COUNTY, FLORIDA			SIGNING AND PAVEMENT MARKING PLANS	SHEET NO.	
DATE	DESCRIPTION	DATE	DESCRIPTION						ROAD NO.	COUNTY
	PRELIMINARY, SUBJECT TO CHANGE INTERIM 60% PLANS, DEC. 6, 2019				KINGSFIELD	ESCAMBIA			S-11	

CURVE DATA CLCON2
PI STA. = 156+49.44
Δ = 19° 28' 43" (LT)
D = 2° 45' 02"
T = 357.52
L = 708.15
R = 2,083.00
PC STA. = 152+91.91
PT STA. = 160+00.06

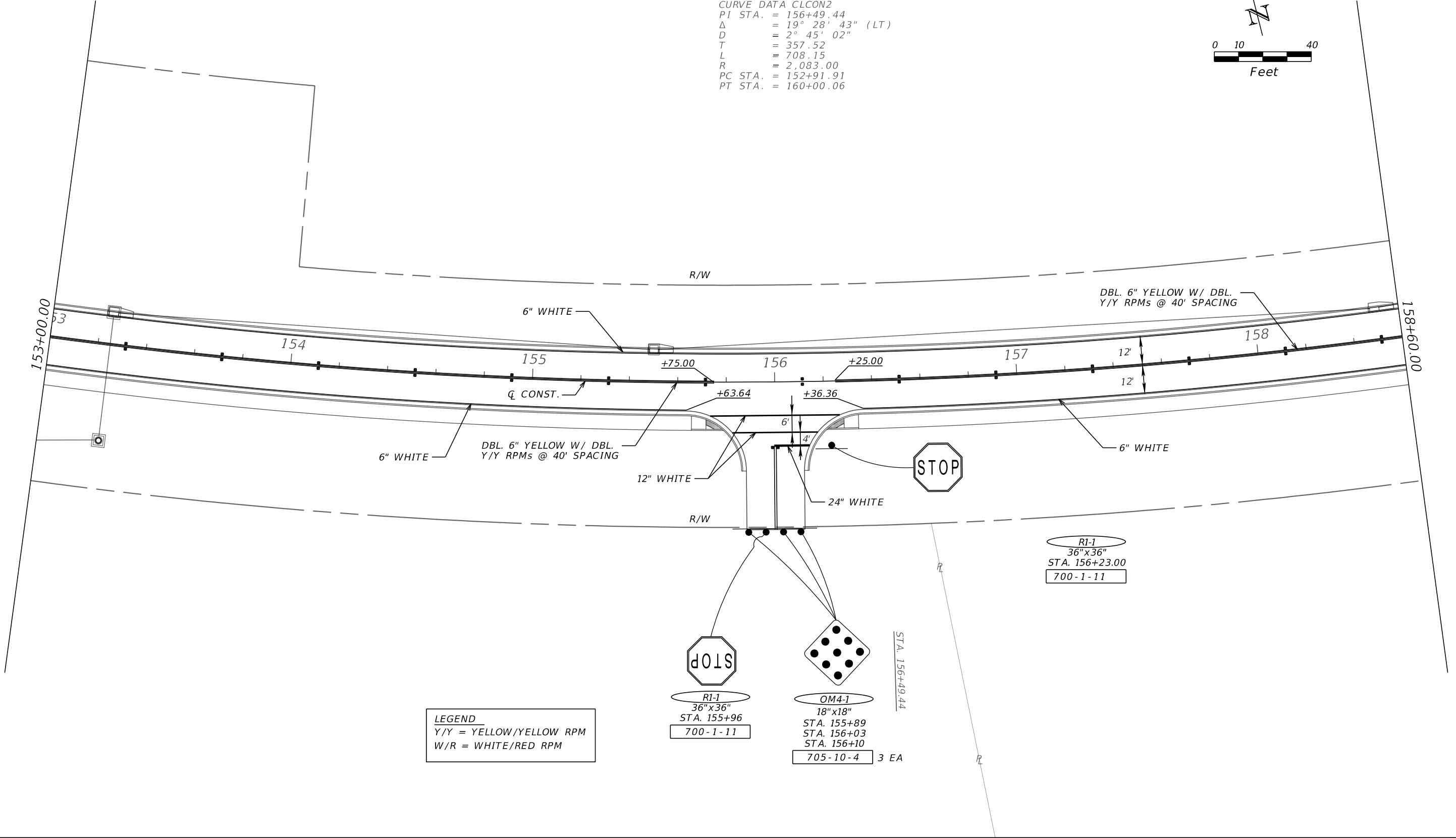
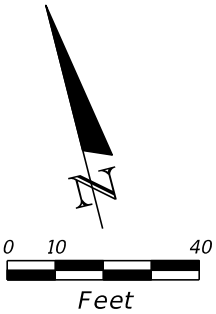

LEGEND
Y/Y = YELLOW/YELLOW RPM
W/R = WHITE/RED RPM

R1-1
36"x36"
STA. 155+96
700-1-11

OM4-1
18"x18"
STA. 155+89
STA. 156+03
STA. 156+10
705-10-4 3 EA

R1-1
36"x36"
STA. 156+23.00
700-1-11

REVISIONS				THOMAS A. MCLENDON, P.E. P.E. LICENSE NUMBER 71749 MOTT MACDONALD FLORIDA, LLC 220 WEST GARDEN STREET, SUITE 700 PENSACOLA, FL 32502 CERTIFICATE OF AUTHORIZATION 155	BOARD OF COUNTY COMMISSIONERS ESCAMBIA COUNTY, FLORIDA			SIGNING AND PAVEMENT MARKING PLANS		SHEET NO. S-12
DATE	DESCRIPTION	DATE	DESCRIPTION		ROAD NO.	COUNTY	FINANCIAL PROJECT ID			
	PRELIMINARY, SUBJECT TO CHANGE INTERIM 60% PLANS, DEC. 6, 2019				KINGSFIELD	ESCAMBIA				

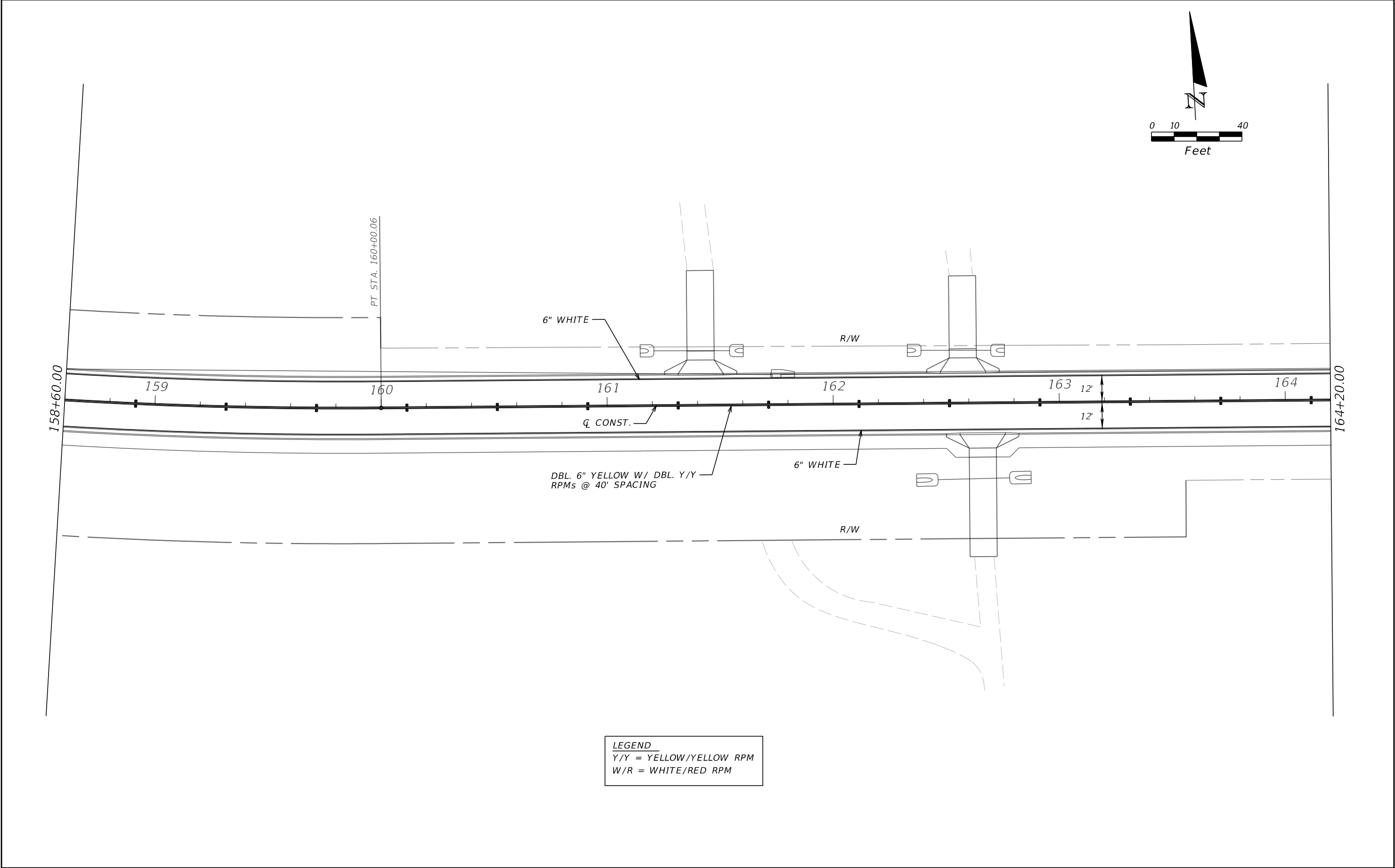

THE OFFICIAL RECORD OF THIS SHEET IS THE ELECTRONIC FILE DIGITALLY SIGNED AND SEALED UNDER RULE 61G15-23.004, F.A.C.

REVISIONS				THOMAS A. MCLENDON, P.E. P.E. LICENSE NUMBER 71749 MOTT MACDONALD FLORIDA, LLC 220 WEST GARDEN STREET, SUITE 700 PENSACOLA, FL 32502 CERTIFICATE OF AUTHORIZATION 155	BOARD OF COUNTY COMMISSIONERS ESCAMBIA COUNTY, FLORIDA			SIGNING AND PAVEMENT MARKING PLANS	SHEET NO.
DATE	DESCRIPTION	DATE	DESCRIPTION		ROAD NO.	COUNTY	FINANCIAL PROJECT ID		S-13
	PRELIMINARY, SUBJECT TO CHANGE INTERIM 60% PLANS, DEC. 6, 2019				KINGSFIELD	ESCAMBIA			

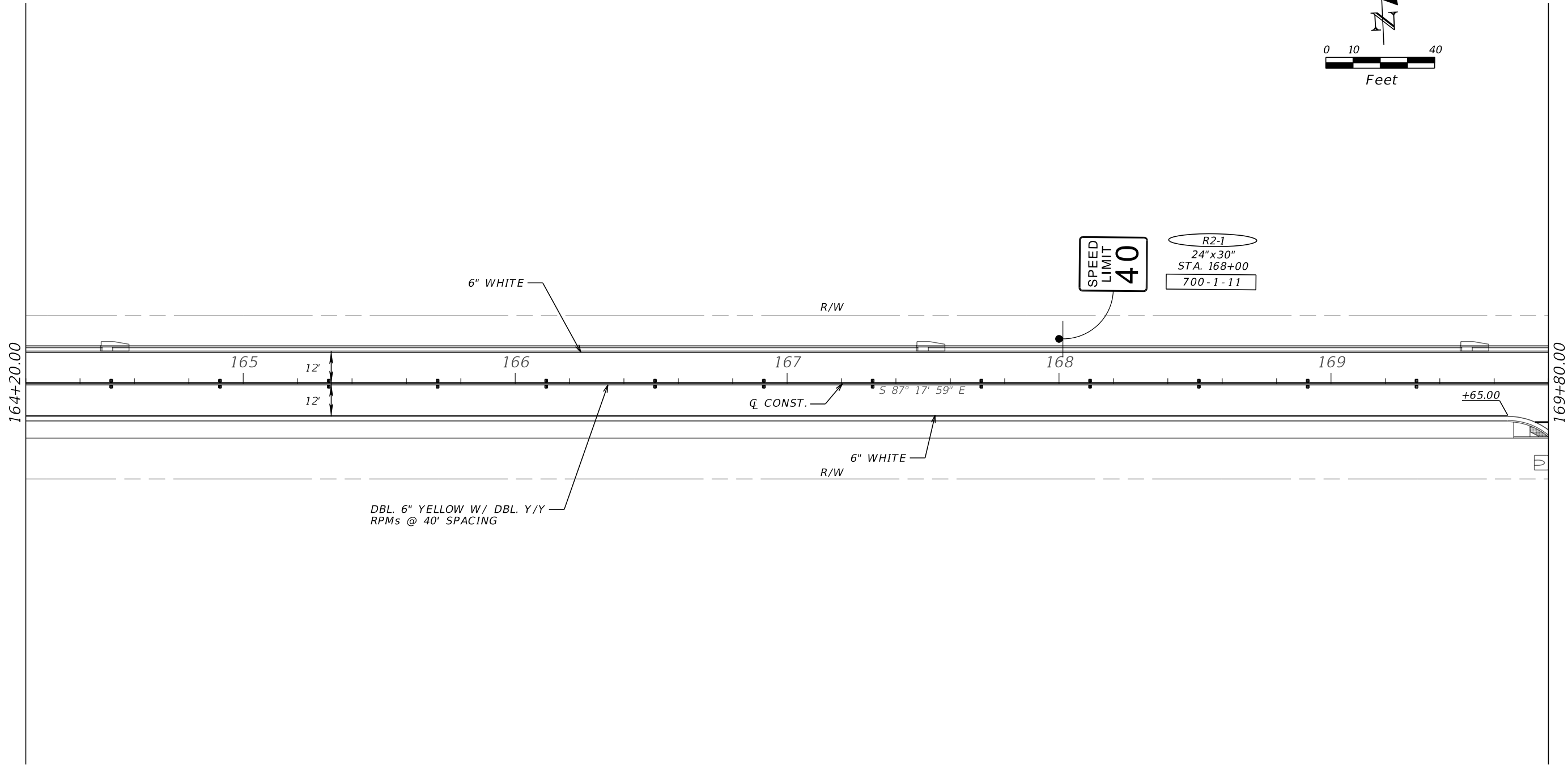
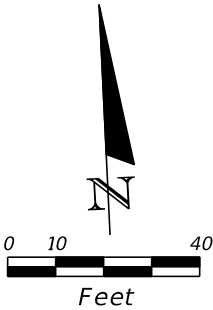

LEGEND
Y/Y = YELLOW/YELLOW RPM
W/R = WHITE/RED RPM

REVISIONS				THOMAS A. MCLENDON, P.E. P.E. LICENSE NUMBER 71749 MOTT MACDONALD FLORIDA, LLC 220 WEST GARDEN STREET, SUITE 700 PENSACOLA, FL 32502 CERTIFICATE OF AUTHORIZATION 155	BOARD OF COUNTY COMMISSIONERS ESCAMBIA COUNTY, FLORIDA			SIGNING AND PAVEMENT MARKING PLANS	SHEET NO.
DATE	DESCRIPTION	DATE	DESCRIPTION		ROAD NO.	COUNTY	FINANCIAL PROJECT ID		S-14
	PRELIMINARY, SUBJECT TO CHANGE INTERIM 60% PLANS, DEC. 6, 2019				KINGSFIELD	ESCAMBIA			

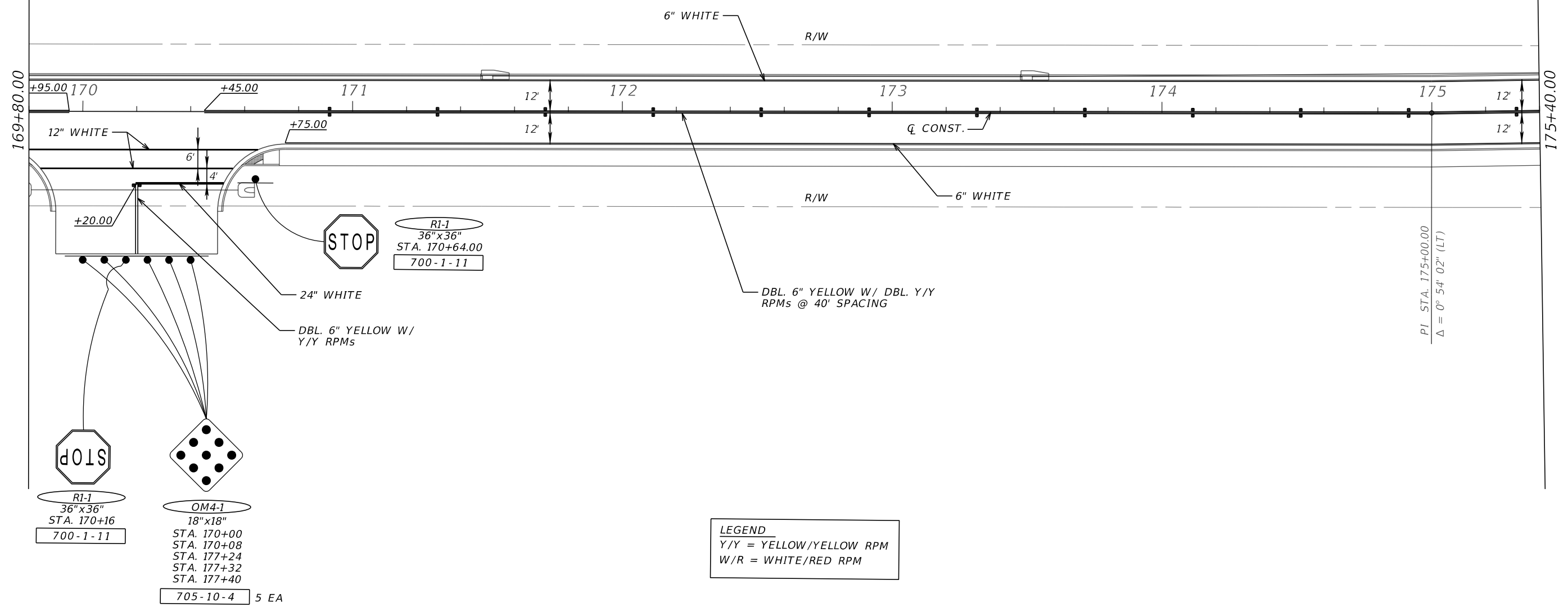
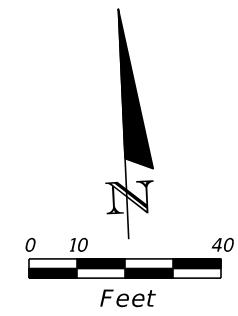

LEGEND
Y/Y = YELLOW/YELLOW RPM
W/R = WHITE/RED RPM

REVISIONS				THOMAS A. MCLENDON, P.E. P.E. LICENSE NUMBER 71749 MOTT MACDONALD FLORIDA, LLC 220 WEST GARDEN STREET, SUITE 700 PENSACOLA, FL 32502 CERTIFICATE OF AUTHORIZATION 155	BOARD OF COUNTY COMMISSIONERS ESCAMBIA COUNTY, FLORIDA			SIGNING AND PAVEMENT MARKING PLANS	SHEET NO.
DATE	DESCRIPTION	DATE	DESCRIPTION						
	PRELIMINARY, SUBJECT TO CHANGE INTERIM 60% PLANS, DEC. 6, 2019				ROAD NO.	COUNTY	FINANCIAL PROJECT ID		S-15
					KINGSFIELD	ESCAMBIA			

THE OFFICIAL RECORD OF THIS SHEET IS THE ELECTRONIC FILE DIGITALLY SIGNED AND SEALED UNDER RULE 61G15-23.004, F.A.C.

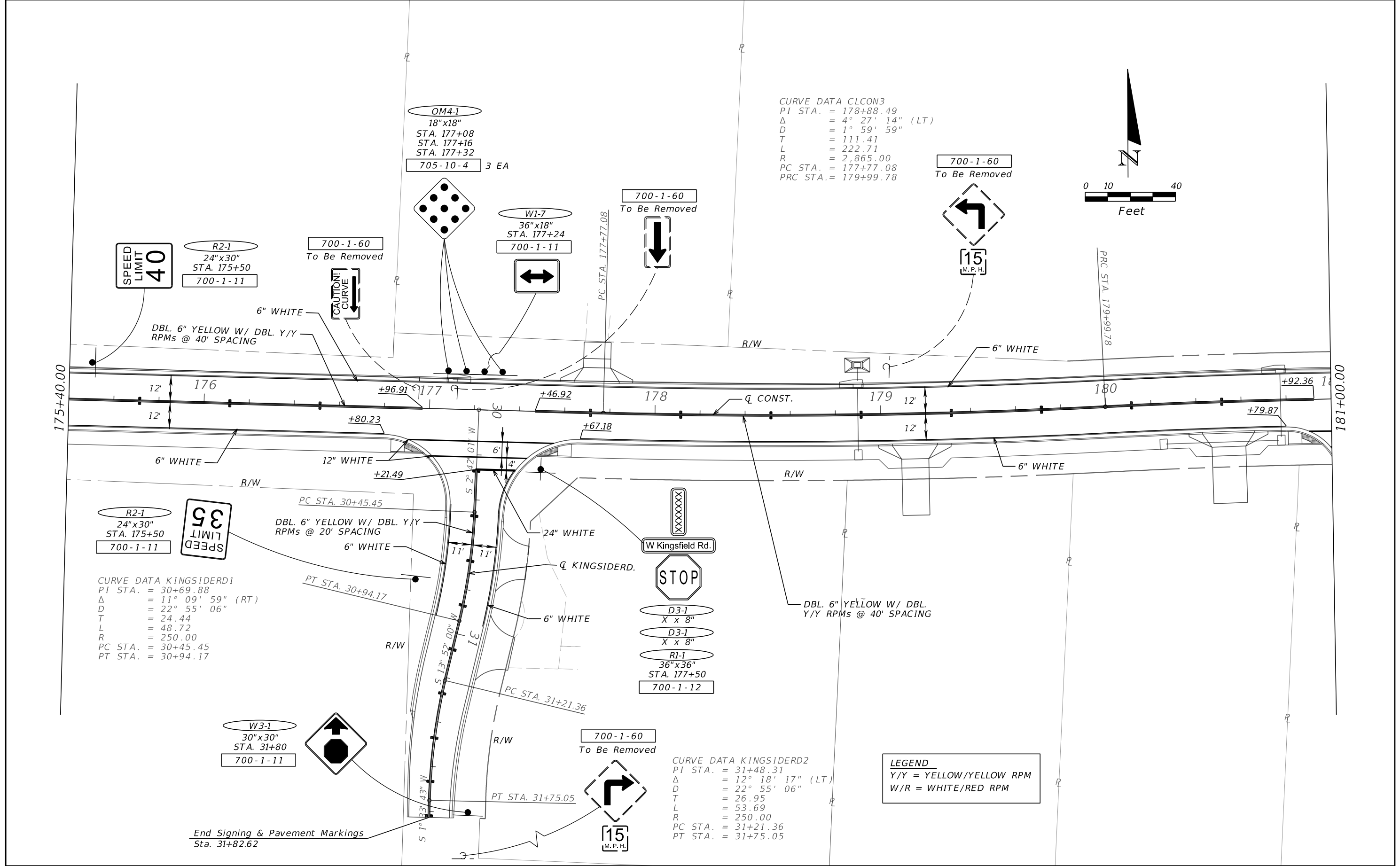

REVISIONS				THOMAS A. MCLENDON, P.E. P.E. LICENSE NUMBER 71749 MOTT MACDONALD FLORIDA, LLC 220 WEST GARDEN STREET, SUITE 700 PENSACOLA, FL 32502 CERTIFICATE OF AUTHORIZATION 155	BOARD OF COUNTY COMMISSIONERS ESCAMBIA COUNTY, FLORIDA			SIGNING AND PAVEMENT MARKING PLANS		SHEET NO. S-16
DATE	DESCRIPTION	DATE	DESCRIPTION		ROAD NO.	COUNTY	FINANCIAL PROJECT ID			
	PRELIMINARY, SUBJECT TO CHANGE INTERIM 60% PLANS, DEC. 6, 2019				KINGSFIELD	ESCAMBIA				

THE OFFICIAL RECORD OF THIS SHEET IS THE ELECTRONIC FILE DIGITALLY SIGNED AND SEALED UNDER RULE 61G15-23.004, F.A.C.

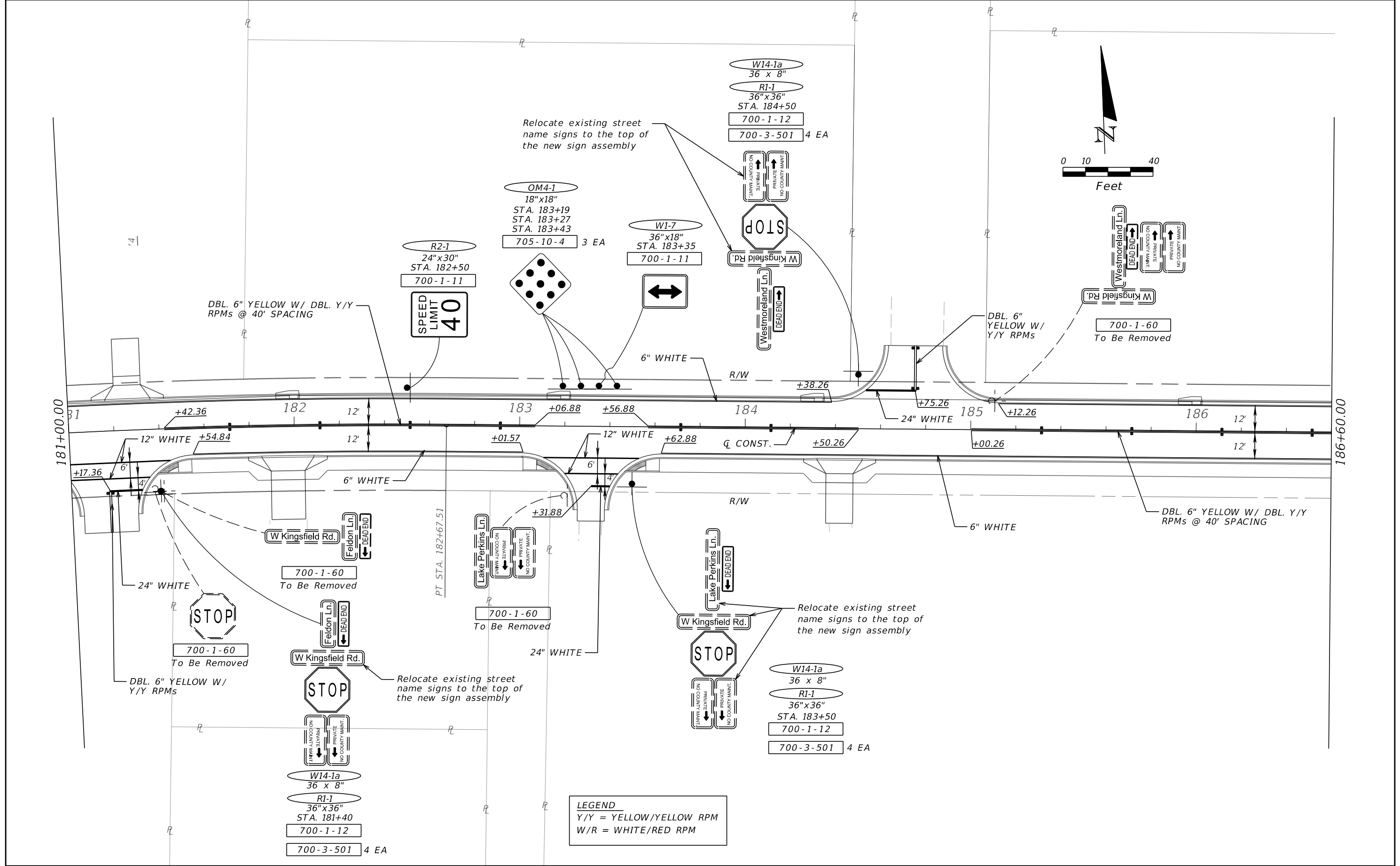

REVISIONS				THOMAS A. MCLENDON, P.E. P.E. LICENSE NUMBER 71749 MOTT MACDONALD FLORIDA, LLC 220 WEST GARDEN STREET, SUITE 700 PENSACOLA, FL 32502 CERTIFICATE OF AUTHORIZATION 155	BOARD OF COUNTY COMMISSIONERS ESCAMBIA COUNTY, FLORIDA			SIGNING AND PAVEMENT MARKING PLANS	SHEET NO. S-17
DATE	DESCRIPTION	DATE	DESCRIPTION		ROAD NO.	COUNTY	FINANCIAL PROJECT ID		
	PRELIMINARY, SUBJECT TO CHANGE INTERIM 60% PLANS, DEC. 6, 2019				KINGSFIELD	ESCAMBIA			

THE OFFICIAL RECORD OF THIS SHEET IS THE ELECTRONIC FILE DIGITALLY SIGNED AND SEALED UNDER RULE 61G15-23.004, F.A.C.

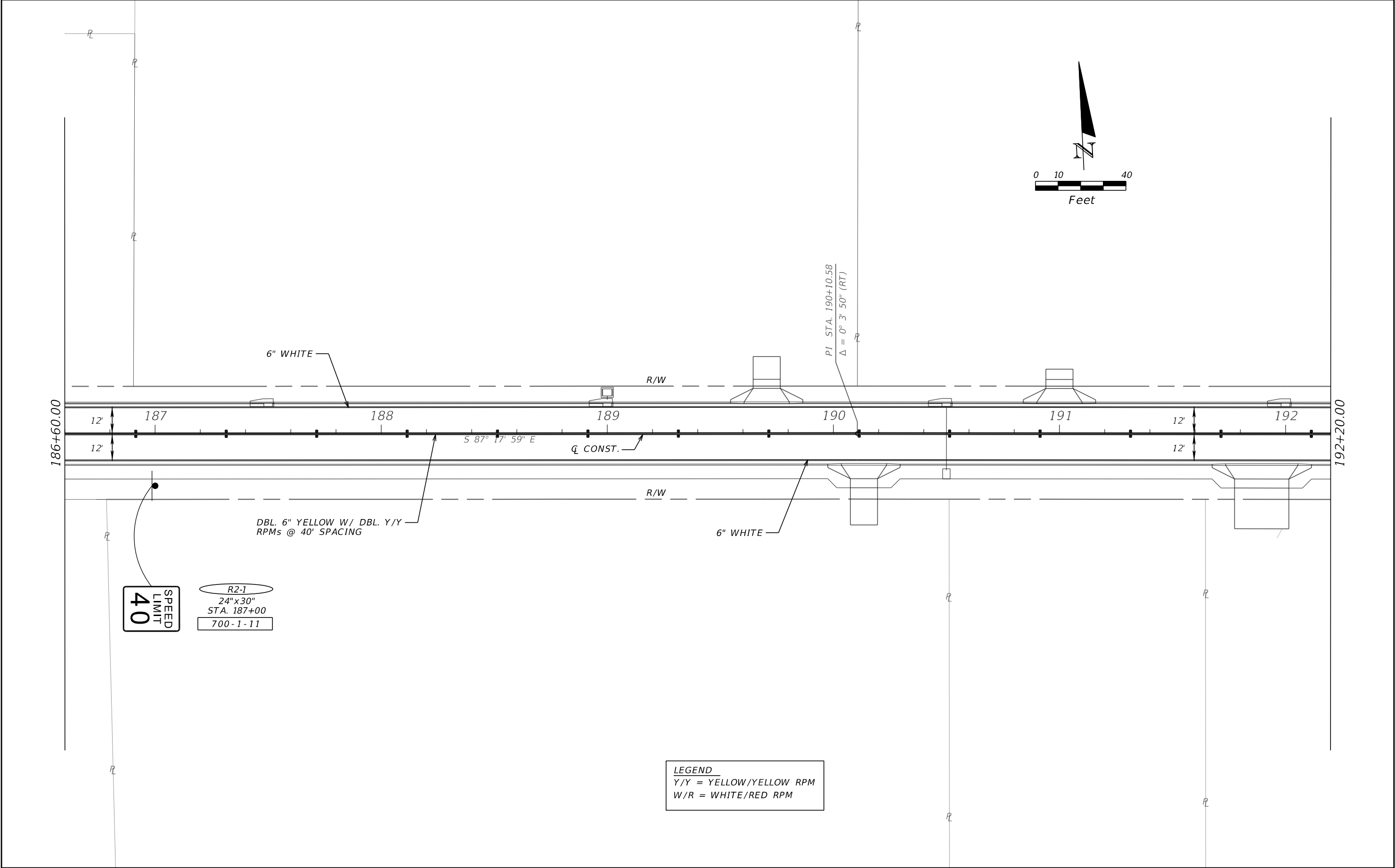

REVISIONS				THOMAS A. MCLENDON, P.E. P.E. LICENSE NUMBER 71749 MOTT MACDONALD FLORIDA, LLC 220 WEST GARDEN STREET, SUITE 700 PENSACOLA, FL 32502 CERTIFICATE OF AUTHORIZATION 155	BOARD OF COUNTY COMMISSIONERS ESCAMBIA COUNTY, FLORIDA			SIGNING AND PAVEMENT MARKING PLANS		SHEET NO.
DATE	DESCRIPTION	DATE	DESCRIPTION		ROAD NO.	COUNTY	FINANCIAL PROJECT ID			S-18
	PRELIMINARY, SUBJECT TO CHANGE INTERIM 60% PLANS, DEC. 6, 2019				KINGSFIELD	ESCAMBIA				

THE OFFICIAL RECORD OF THIS SHEET IS THE ELECTRONIC FILE DIGITALLY SIGNED AND SEALED UNDER RULE 61G15-23.004, F.A.C.

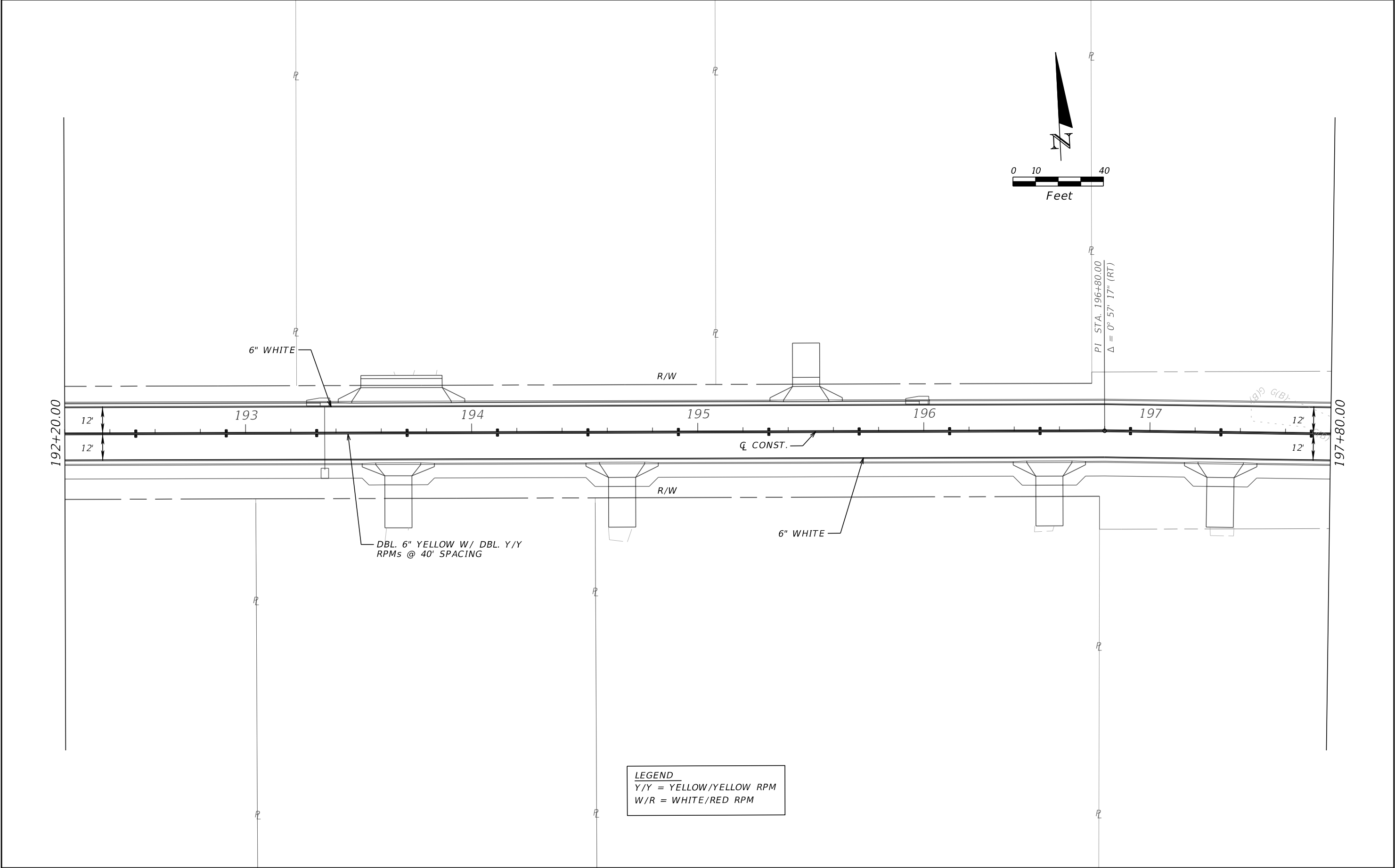

LEGEND
Y/Y = YELLOW/YELLOW RPM
W/R = WHITE/RED RPM

REVISIONS				THOMAS A. MCLENDON, P.E. P.E. LICENSE NUMBER 71749 MOTT MACDONALD FLORIDA, LLC 220 WEST GARDEN STREET, SUITE 700 PENSACOLA, FL 32502 CERTIFICATE OF AUTHORIZATION 155	BOARD OF COUNTY COMMISSIONERS ESCAMBIA COUNTY, FLORIDA			SIGNING AND PAVEMENT MARKING PLANS	SHEET NO.
DATE	DESCRIPTION	DATE	DESCRIPTION		ROAD NO.	COUNTY	FINANCIAL PROJECT ID		S-19
	PRELIMINARY, SUBJECT TO CHANGE INTERIM 60% PLANS, DEC. 6, 2019				KINGSFIELD	ESCAMBIA			

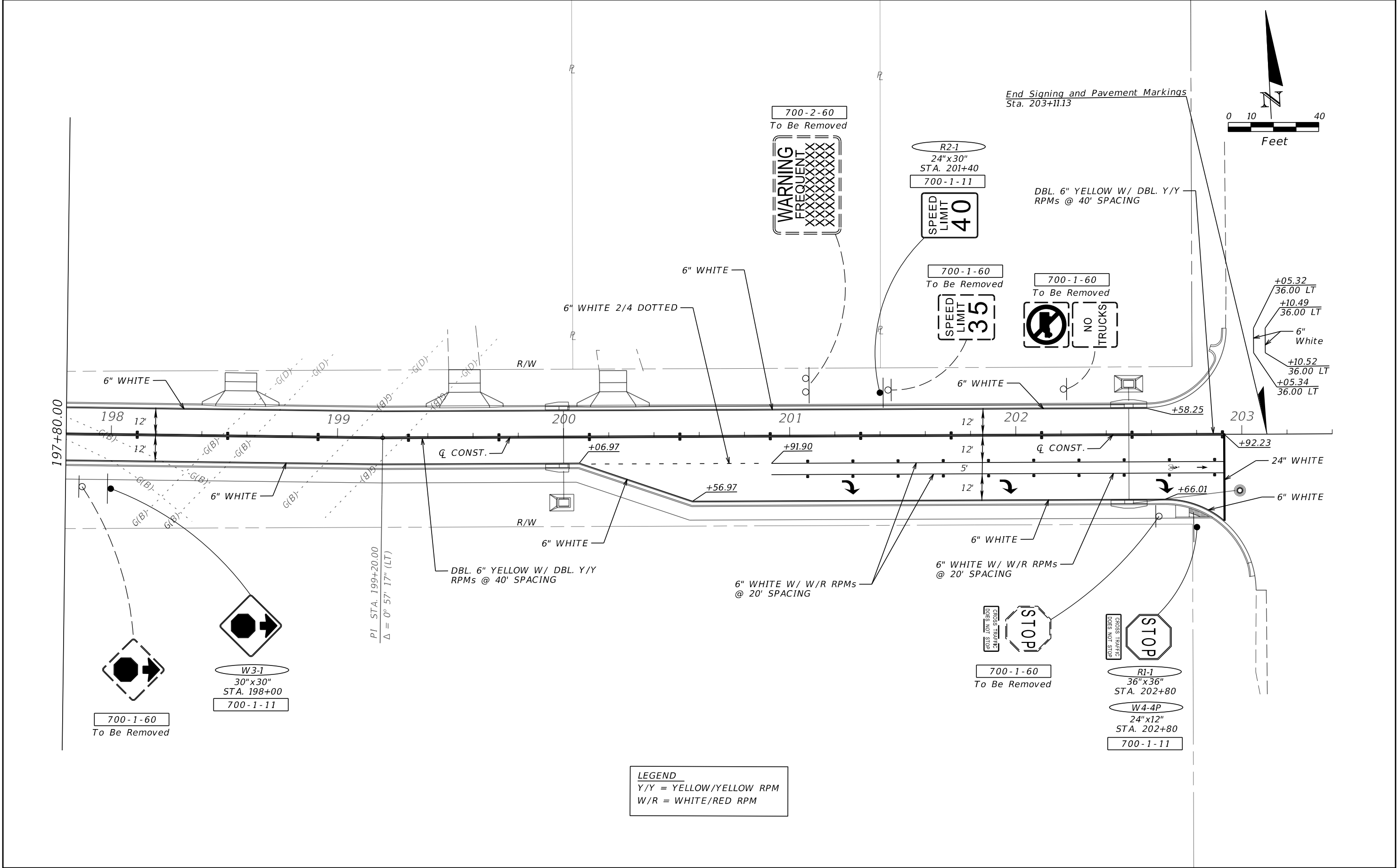

REVISIONS				THOMAS A. MCLENDON, P.E. P.E. LICENSE NUMBER 71749 MOTT MACDONALD FLORIDA, LLC 220 WEST GARDEN STREET, SUITE 700 PENSACOLA, FL 32502 CERTIFICATE OF AUTHORIZATION 155	BOARD OF COUNTY COMMISSIONERS ESCAMBIA COUNTY, FLORIDA			SIGNING AND PAVEMENT MARKING PLANS		SHEET NO. S-20
DATE	DESCRIPTION	DATE	DESCRIPTION		ROAD NO.	COUNTY	FINANCIAL PROJECT ID			
	PRELIMINARY, SUBJECT TO CHANGE INTERIM 60% PLANS, DEC. 6, 2019				KINGSFIELD	ESCAMBIA				

THE OFFICIAL RECORD OF THIS SHEET IS THE ELECTRONIC FILE DIGITALLY SIGNED AND SEALED UNDER RULE 61G15-23.004, F.A.C.