

Approved
ESCAMBIA COUNTY DRC PLAN REVIEW

DRC Chairman Signature [Signature] 1-25-17
 Development Services Director or Designee Date

This document has been reviewed in accordance with the requirements of applicable Escambia County Regulations and Ordinances, and does not in any way relieve the submitting Architect, Engineer, Surveyor or other signatory from responsibility of details as drawn. A Development Order must be obtained from the Development review Committee (DRC) prior to the commencement of construction. This approval by the DRC does not constitute approval by any other agency. All additional state/federal permits shall be provided to the county prior to approval of a final plat or the issuance of state/federal permits shall be provided to the county prior to approval of a final plat or the issuance of a building permit

TE CONSTRUCTION PLANS

FOR CORT BUSINESS SERVICES 503 WEST BURGESS ROAD PENSACOLA, FL 32505

DECEMBER 16, 2016

RBA PROJECT NO.: 2016.232

SITE INFORMATION	
OWNER:	TERHAAR & CRONLEY DEVELOPMENT COMPANY LLC 1401 E. BELMONT STREET PENSACOLA, FLORIDA 32501 850.433.7007
DEVELOPER:	TERHAAR & CRONLEY DEVELOPMENT COMPANY LLC 1401 E. BELMONT STREET PENSACOLA, FLORIDA 32501 850.433.7007
PROPERTY REFERENCE NO:	27-15-30-3101-003-009
PROPERTY ADDRESS:	405 W. BURGESS ROAD
PROPERTY AREA:	11.18 ACRES
PROJECT AREA:	0.79 ACRES
PROPERTY ZONING:	HC/LJ
FUTURE LAND USE:	COMMERCIAL
PROPOSED ACTIVITY:	MATTRESS WAREHOUSE
REQUIRED BUILDING SETBACKS C-1:	FRONT YARD - 15 FT. SIDE YARD - 10 FT. REAR YARD - 15 FT.

FEMA FLOOD INSURANCE RATE MAP INFORMATION					
THE PARCEL SHOWN FOR DEVELOPMENT IS LOCATED WITHIN THE FOLLOWING FLOOD ZONE(S) AS DETAILED BY FEMA FIRM (FLOOD INSURANCE RATE MAP) INFORMATION DESCRIBED BELOW:					
FLOOD ZONE(S)	COMMUNITY No.	MAP No.	PANEL No.	SUFFIX	MAP REVISION DATE
X	120080	12033C	0360	G	SEPT 29, 2006

CONTACTS	
GULF POWER 500 BAYFRONT PARKWAY PENSACOLA, FLORIDA 32520	CONTACT: DON SCHOFIELD PHONE: 850.444.6555 FAX: 850.444.6432
COX CABLE 2205 LOVISTA AVE. PENSACOLA, FLORIDA 32504	CONTACT: RICHARD EMMONS PHONE: 850.477.2695 FAX: 850.479.3912
ECUA P.O. BOX 15311 PENSACOLA, FLORIDA 32514	CONTACT: TONY JOHNSON PHONE: 850.969.6679
ENERGY SERVICES GAS 1625 ATWOOD DRIVE PENSACOLA, FLORIDA 32504	CONTACT: JOHN DeMARS PHONE: 850.474.5322 FAX: 850.474.5330
AT&T, INC. 605 W. GARDEN STREET PENSACOLA, FLORIDA 32501	CONTACT: SHARON BLACKMAN PHONE: 850.436.1662
ESCAMBIA COUNTY ENGINEER 1190 W. LEONARD STREET PENSACOLA, FLORIDA 32501	CONTACT: JOY BLACKMON PHONE: 850.595.3434
MCI	PHONE: 800.624.9675
SUNSHINE UTILITIES	PHONE: 800.432.4770

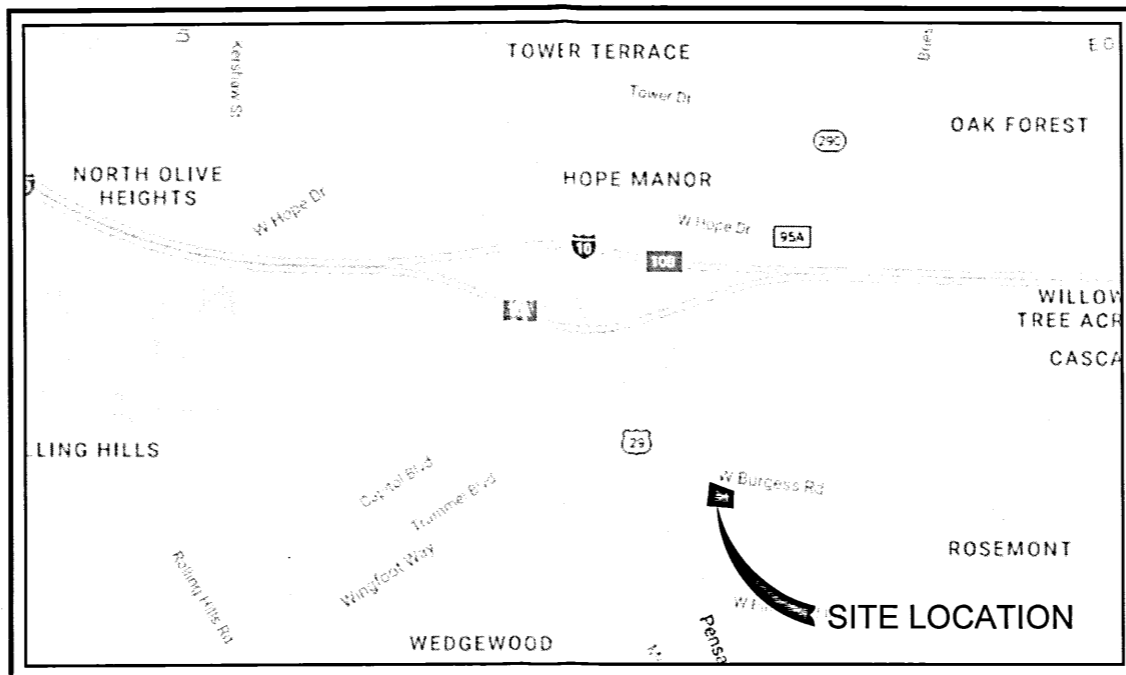

VICINITY MAP
 SCALE: 1"=1,000'



REBOL-BATTLE & ASSOCIATES

Civil and Environmental Engineers

2301 N. Ninth Avenue, Suite 300
 Pensacola, Florida 32503
 Telephone 850.438.0400
 Fax 850.438.0448
 EB 00009657 LB 7916

ECUA REQUIRED PLAN NOTES
 (NOTES SHALL BE INSERTED IN THE UPPER RIGHT CORNER OF TITLE SHEET)

A. ECUA ENGINEERING MANUAL INCORPORATED BY REFERENCE

THE ECUA ENGINEERING MANUAL, DATED DECEMBER 18, 2014, ALONG WITH ANY LISTED UPDATE #1 DATED SEPTEMBER 1, 2016 (HEREINAFTER "MANUAL"), LOCATED AT WWW.ECUA.FL.GOV, IS HEREBY INCORPORATED BY REFERENCE INTO THIS PROJECT'S OFFICIAL CONTRACT DOCUMENTS AS IF FULLY SET FORTH THEREIN. IT IS THE CONTRACTOR'S RESPONSIBILITY TO BE KNOWLEDGEABLE OF THE MANUAL'S CONTENTS AND TO CONSTRUCT THE PROJECT IN ACCORDANCE WITH THE MANUAL. THE CONTRACTOR SHALL PROVIDE ITS EMPLOYEES ACCESS TO THE MANUAL AT ALL TIMES, VIA PROJECT SITE OR OFFICE, VIA DIGITAL OR PAPER FORMAT. IN THE EVENT OF A CONFLICT BETWEEN THE MANUAL AND THE PLANS, CONTRACTOR SHALL CONSULT ENGINEER OF RECORD ON THE APPROPRIATE RESOLUTION.

B. ADDITIONAL DOCUMENTS (TO BE COMPLETED BY THE ENGINEER OF RECORD)

DOES THIS PROJECT HAVE ADDITIONAL TECHNICAL SPECIFICATIONS OR CONSTRUCTION DETAILS THAT SUPERSEDE THE MANUAL LISTED ABOVE?
 YES NO

IF YES, CONTRACTOR SHALL CONSTRUCT PROJECT IN ACCORDANCE WITH SAID DOCUMENTS AS LISTED AND LOCATED BELOW:

DOCUMENT NAME	DOCUMENT TYPE		LOCATION	
	SPECIFICATION	DETAIL	PLANS	PROJECT MANUAL*
SHEET C4.1-UTILITY DETAILS		X	X	

*PROJECT MANUALS USED ONLY WITH ECUA CIP PROJECTS

C. ENGINEER OF RECORD RESPONSIBILITIES

THE ENGINEERS OF RECORD (EORS) THAT HAVE AFFIXED THEIR SEALS AND SIGNATURES ON THESE PLANS WARRANT THEIR PORTION OF THE PLANS HAVE BEEN DESIGNED IN ACCORDANCE WITH THE MANUAL (UNLESS OTHERWISE DIRECTED BY THE ECUA PROJECT ENGINEER). THE EORS SHALL BE KNOWLEDGEABLE OF THE MANUAL'S CONTENTS AND SHALL ASSUME RESPONSIBILITY FOR ITS USE ON THIS PROJECT.

INDEX OF DRAWINGS

- C1.0 EXISTING SITE, DEMOLITION AND EROSION CONTROL PLAN
- C1.1 EROSION CONTROL DETAILS
- C1.2 NPDES-STORMWATER POLLUTION PREVENTION PLAN
- C2.0 SITE LAYOUT AND DIMENSION PLAN
- C2.1 SITE DETAILS
- C3.0 GRADING AND DRAINAGE PLAN
- C4.0 UTILITY PLAN
- C4.1 UTILITY DETAILS
- C5.0 LANDSCAPE, STRIPING & SIGNAGE PLAN
- C6.0 MAINTENANCE OF TRAFFIC DETAILS

LEGAL DESCRIPTION

BEG AT INTER OF S R/W LJ BURGESS RD (66 FT R/W) AND WLY R/W LJ OLD PALAFOX HWY (SR-95-A) (66 FT R/W) TH N 83 DEG 58 MIN 00 SEC W ALG S R/W LJ OF SD RD 1361 22/100 FT TO POB CONT N 83 DEG 58 MIN 00 SEC W ALG SD S R/W LJ 795 23/100 FT S 06 DEG 04 MIN 00 SEC W ALG E R/W LJ OF BURGESS RD 468 49/100 FT S 84 DEG 00 MIN 00 SEC E 215 FT S 06 DEG 04 MIN 00 SEC W 160 FT S 84 DEG 00 MIN 00 SEC E 445 16/100 FT S 06 DEG 04 MIN 00 SEC W 160 FT S 84 DEG 00 MIN 00 SEC E 135 06/100 FT N 06 DEG 04 MIN 00 SEC E 787 73/100 FT TO POB OR 7011 P 1257

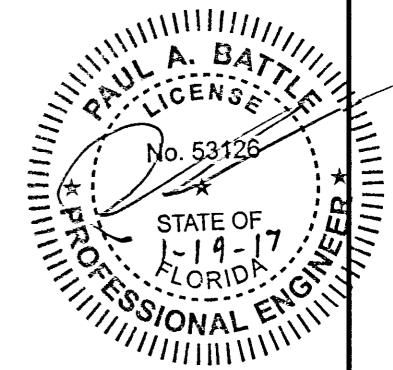

THE CONTRACTOR IS RESPONSIBLE FOR OBTAINING "RELEASED FOR CONSTRUCTION" DRAWINGS FROM REBOL-BATTLE & ASSOCIATES BEFORE BEGINNING CONSTRUCTION. REBOL-BATTLE & ASSOCIATES WILL NOT BE RESPONSIBLE FOR ANY CONSTRUCTION BASED ON PLANS THAT HAVE NOT BEEN RELEASED FOR CONSTRUCTION.

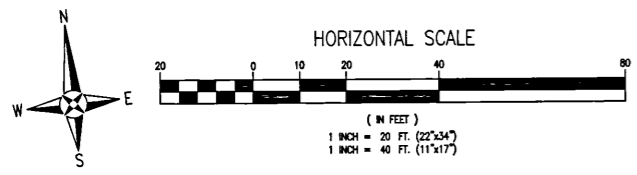

LEGEND	
	EXISTING ASPHALT
	EXISTING CONCRETE
	EXISTING GRAVEL
	EXISTING CHAIN LINK FENCE
	EXISTING WOODEN FENCE
	BOUNDARY LINE
	EASEMENT LINE
	LOT LINE
	RIGHT-OF-WAY LINE
	WATER LINE
	SEWER LINE (GRAVITY)
	OVERHEAD UTILITIES
	GAS LINE
	EXISTING CONTOUR
	STRAW BALE
	SILT FENCE
	UTILITY POLE
	LIGHT POLE
	TELEPHONE BOX
	GAS VALVE
	STREET SIGN
	SIGN
	BENCHMARK
	FIRE HYDRANT
	WATER METER
	WATER VALVE
	CLEANOUT
	SEWER MANHOLE
	STORMWATER MANHOLE
	GUY ANCHOR
	EXISTING TREE

- GENERAL NOTES:**
- ALL WORK SHALL BE PERFORMED IN ACCORDANCE WITH THESE PLANS AND SPECIFICATIONS AND THE REQUIREMENTS AND STANDARDS OF ALL GOVERNING AUTHORITIES.
 - PRIOR TO STARTING CONSTRUCTION, THE CONTRACTOR SHALL BE RESPONSIBLE FOR CONFIRMING THAT ALL REQUIRED PERMITS AND APPROVALS HAVE BEEN OBTAINED. NO CONSTRUCTION OR FABRICATION SHALL BEGIN UNTIL THE CONTRACTOR HAS RECEIVED AND THOROUGHLY REVIEWED ALL PLANS AND OTHER DOCUMENTS APPROVED BY ALL OF THE PERMITTING AGENCIES.
 - THE LOCATION OF UNDERGROUND FACILITIES SHOWN ON THESE PLANS IS BASED ON INFORMATION PROVIDED BY THE UTILITIES AND SHALL BE CONSIDERED APPROXIMATE. IT SHALL BE THE CONTRACTOR'S FULL RESPONSIBILITY TO CONTACT THE VARIOUS UTILITY COMPANIES TO LOCATE THEIR FACILITIES PRIOR TO STARTING CONSTRUCTION. NO ADDITIONAL COMPENSATION SHALL BE PAID TO THE CONTRACTOR FOR DAMAGE AND REPAIR TO THESE FACILITIES CAUSED BY HIS WORK FORCE.
 - THE CONTRACTOR SHALL NOTIFY THE SUPERINTENDENTS OF THE WATER, SANITARY SEWER, GAS, TELEPHONE, CABLE TELEVISION, AND POWER COMPANIES 10 DAYS IN ADVANCE THAT HE INTENDS TO START WORK IN A SPECIFIED AREA. THE OWNER DISCLAIMS ANY RESPONSIBILITY FOR THE SUPPORT AND PROTECTION OF SEWERS, DRAINS, WATER PIPES, GAS PIPES, CONDUITS OF ANY KIND, UTILITIES OR OTHER STRUCTURES OWNED BY THE CITY, COUNTY, STATE OR BY PRIVATE OR PUBLIC UTILITIES LEGALLY OCCUPYING ANY STREET, ALLEY, PUBLIC PLACE OR RIGHT-OF-WAY.
 - ALL SITE CLEARING SHALL INCLUDE THE LOCATION AND REMOVAL OF ALL UNDERGROUND STRUCTURES, WHICH ARE NOT IN SERVICE AS NECESSARY FOR THE INSTALLATION OF PROPOSED IMPROVEMENTS. THESE INCLUDE PIPES, VALVES, DRAINAGE STRUCTURES, ETC., AS INDICATED ON THE CONTRACT PLANS. CONTRACTOR SHALL NOTIFY THE PROJECT OWNER AND ENGINEER OF ALL DISCOVERED UNDERGROUND STRUCTURES WHICH ARE IN CONFLICT WITH THE INSTALLATION OF THE PROPOSED IMPROVEMENTS AND ARE NOT INDICATED ON THE CONTRACT PLANS OR LOCATED IN THE FIELD BY UTILITIES IN ACCORDANCE WITH GENERAL NOTES.
 - THE RELOCATION OF OBSTRUCTIONS OWNED BY PRIVATE PROPERTY OWNERS, SUCH AS MAIL BOXES, SHALL BE THE RESPONSIBILITY OF THE CONTRACTOR WHO MUST COORDINATE WITH THE PROPERTY OWNER.
 - THE CONTRACTOR SHALL PLACE AND MAINTAIN ADEQUATE BARRICADES, CONSTRUCTION SIGNS, FLASHING LIGHTS, TORCHES, RED LANTERNS AND GUARDS DURING ALL PHASES OF CONSTRUCTION, IN ACCORDANCE WITH APPLICABLE FDOT INDEX.
 - ALL AREAS NOT PAVED OR DISTURBED DURING CONSTRUCTION SHALL BE STABILIZED BY SEEDING AND MULCHING OR SODDING. SEED AND MULCH OR SOD SHALL BE PLACED, WATERED, FERTILIZED WITH APPROPRIATE SOIL AMENDMENTS IN ACCORDANCE WITH THE FDOT STANDARD SPECIFICATIONS AND THESE CONSTRUCTION DOCUMENTS.
 - ALL EXCESS MATERIAL SHALL BE HAULED AWAY AND DISPOSED OF APPROPRIATELY AT THE CONTRACTOR'S EXPENSE.
 - ALL CONSTRUCTION AROUND TREES SHALL BE DONE IN A MANNER TO MINIMIZE DAMAGE TO THE TREE AND ITS ROOT SYSTEM.
 - THE CONTRACTOR SHALL VISIT THE SITE TO FAMILIARIZE HIMSELF WITH EXISTING CONDITIONS AND THE EXTENT OF CLEARING AND GRUBBING REQUIRED.
 - ALL DIMENSIONS AND GRADES SHOWN ON THE PLANS SHALL BE FIELD VERIFIED BY THE CONTRACTOR PRIOR TO CONSTRUCTION. THE CONTRACTOR SHALL NOTIFY THE ENGINEER IF ANY DISCREPANCIES EXIST PRIOR TO PROCEEDING WITH CONSTRUCTION FOR NECESSARY PLAN OR GRADE CHANGES. NO EXTRA COMPENSATION SHALL BE PAID TO THE CONTRACTOR FOR WORK HAVING TO BE REDONE DUE TO DIMENSIONS OR GRADES SHOWN INCORRECTLY ON THESE PLANS IF SUCH NOTIFICATION HAS NOT BEEN GIVEN.
 - THE CONTRACTOR IS TO COORDINATE WITH THE RESPONSIBLE UTILITY PROVIDER FOR PROTECTION/HOLDING OF UTILITY POLES, GUY WIRES, AND GUY ANCHORS IN AREAS OF CONSTRUCTION. THE CONTRACTOR SHALL INCLUDE THE COST OF PROTECTING UTILITY POLES IN THEIR OVERALL PRICE TO THE OWNER.
 - ANY DAMAGE TO EXISTING ROADS DURING CONSTRUCTION SHALL BE REPAIRED BY THE CONTRACTOR PRIOR TO FINAL "AS-BUILT" SIGN-OFF FROM THE COUNTY.
 - THE OPERATION AND MAINTENANCE OF THE FACILITY WILL BE THE RESPONSIBILITY OF THE OWNER, AS IN ACCORDANCE WITH THE APPROVED PERMIT.
 - THE CONTRACTOR SHALL NOTIFY FDOT 48 HOURS IN ADVANCE PRIOR TO INITIATING ANY WORK IN THE STATE RIGHTS-OF-WAY.

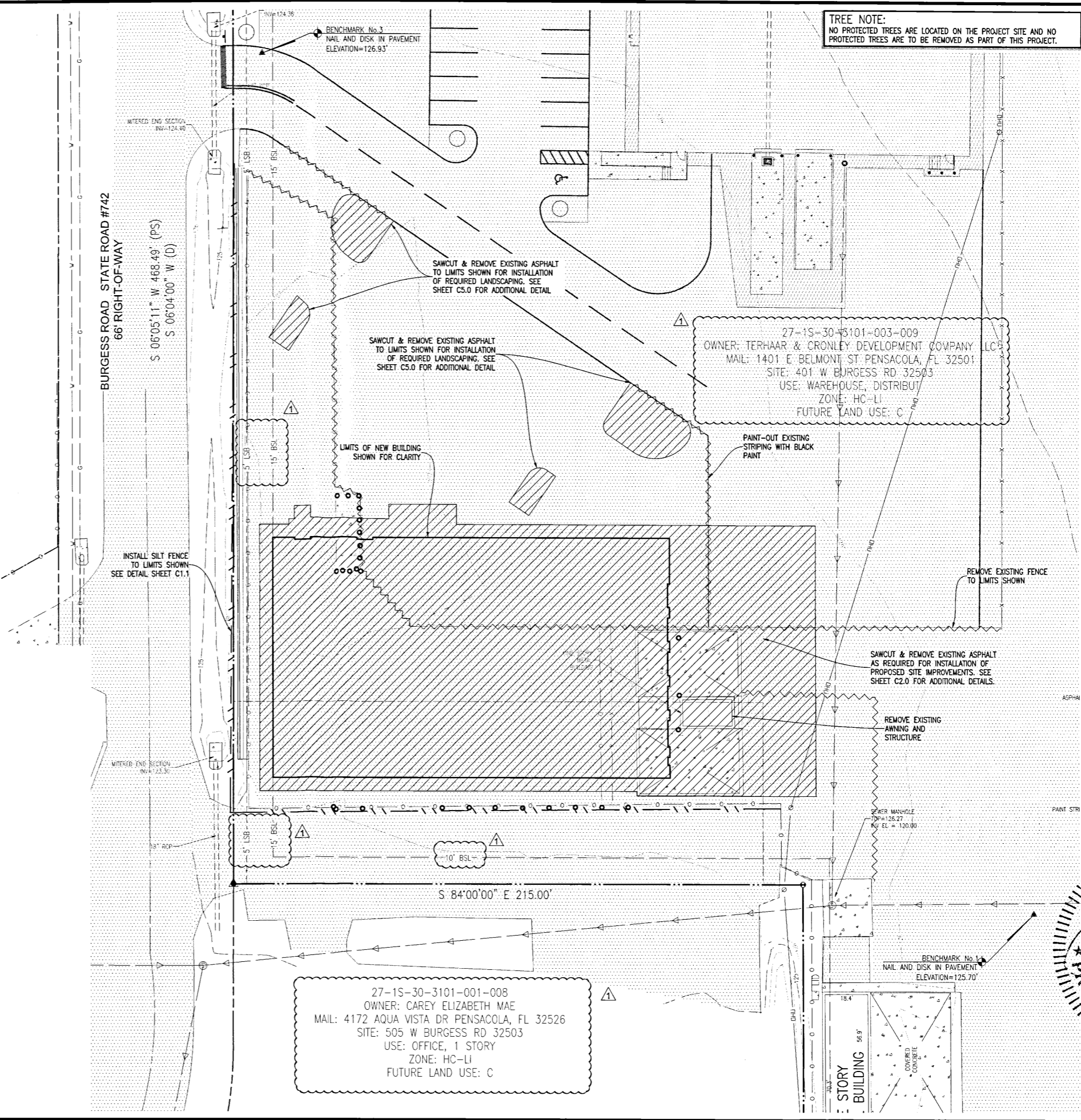

TREE NOTE:
 NO PROTECTED TREES ARE LOCATED ON THE PROJECT SITE AND NO PROTECTED TREES ARE TO BE REMOVED AS PART OF THIS PROJECT.

RBA
REBOL-BATTLE & ASSOCIATES
 Civil Engineers and Surveyors
 2301 N. Ninth Avenue, Suite 300
 Pensacola, Florida 32503
 Telephone 850.438.0400 Fax 850.438.0448
 EB 0000867 LB7916

EXISTING SITE, DEMOLITION & EROSION CONTROL PLAN

CORT BUSINESS SERVICES
 503 WEST BURGESS ROAD
 ESCAMBIA, FLORIDA

NO.	DATE	REVISION
1	12-16-2017	ESCO COMMENTS

NOT FOR CONSTRUCTION
 No. 53126
 STATE OF FLORIDA
 Paul A. Battle, P.E.
 No. 53126
 GTP
 MEER
 Job No. 2019234
 Date: 12-16-2016

DRAWING No.
C1.0
 SHEET 2 OF 11

This drawing is the property of Rebol-Battle & Associates, and may not be reproduced without written permission.

GENERAL NOTES FOR SOIL EROSION AND SEDIMENT CONTROL:

1. ALL EROSION AND SEDIMENT CONTROL PRACTICES TO BE INSTALLED PRIOR TO ANY MAJOR SOIL DISTURBANCE, OR IN THEIR PROPER SEQUENCE, AND MAINTAINED UNTIL PERMANENT PROTECTION IS ESTABLISHED.
2. ANY DISTURBED AREAS THAT WILL BE LEFT EXPOSED MORE THAN 30 DAYS, AND NOT SUBJECT TO CONSTRUCTION TRAFFIC, WILL IMMEDIATELY RECEIVE A TEMPORARY SEEDING. IF THE SEASON PREVENTS THE ESTABLISHMENT OF A TEMPORARY COVER, THE DISTURBED AREAS WILL BE MULCHED WITH STRAW, OR EQUIVALENT MATERIAL, AT A RATE OF TWO (2) TONS PER ACRE, ACCORDING TO STATE STANDARDS.
3. PERMANENT VEGETATION TO BE SEEDING OR SODDED ON ALL EXPOSED AREAS WITHIN TEN (10) DAYS AFTER GRADING. MULCH TO BE USED AS NECESSARY FOR PROTECTION UNTIL SEEDING IS ESTABLISHED.
4. ALL WORK AND MATERIALS TO BE IN ACCORDANCE WITH THE FDOT "STANDARD SPECIFICATIONS FOR ROAD AND BRIDGE CONSTRUCTION", LATEST EDITION, SECTIONS 104, 570, 575 AND 980 TO 986.
5. A BITUMINOUS CONCRETE BASE COURSE WILL BE APPLIED IMMEDIATELY FOLLOWING ROUGH GRADING AND INSTALLATION OF IMPROVEMENTS IN ORDER TO STABILIZE STREETS, ROADS, DRIVEWAYS AND PARKING AREAS, IN AREAS WHERE NO UTILITIES ARE PRESENT, THE BITUMINOUS CONCRETE BASE SHALL BE INSTALLED WITHIN 15 DAYS OF THE PRELIMINARY GRADING.
6. IMMEDIATELY FOLLOWING INITIAL DISTURBANCE OR ROUGH GRADING, ALL CRITICAL AREAS SUBJECT TO EROSION (I.E. STEEP SLOPES AND ROADWAY EMBANKMENTS) WILL RECEIVE A TEMPORARY SEEDING IN COMBINATION WITH STRAW MULCH OR A SUITABLE EQUIVALENT, AT A THICKNESS OF TWO (2) TO FOUR (4) INCHES MIXED WITH THE TOP TWO (2) INCHES OF SOIL, ACCORDING TO STATE STANDARDS.
7. ANY STEEP SLOPES RECEIVING PIPELINE INSTALLATION WILL BE BACKFILLED AND STABILIZED DAILY, AS THE INSTALLATION PROCEEDS (I.E. SLOPE GREATER THAN 3:1).
8. A CRUSHED LIMESTONE, VEHICLE WHEEL-CLEANING BLANKET SHALL BE INSTALLED AT THE CONTRACTOR'S STAGING YARD AND/OR STOCKPILE AREAS TO PREVENT OFF-SITE TRACKING OF SEDIMENT BY CONSTRUCTION VEHICLES ONTO PUBLIC ROADS. BLANKET SHALL BE 15FT. X 50FT. X 6IN. (MINIMUM), CRUSHED LIMESTONE 2 1/2 INCHES IN DIAMETER. SAND BLANKET SHALL BE UNDERLAIN WITH A FDOT CLASS 3 SYNTHETIC FILTER FABRIC AND MAINTAINED IN GOOD ORDER.
9. AT THE TIME WHEN THE SITE PREPARATION FOR PERMANENT VEGETATIVE STABILIZATION IS GOING TO BE ACCOMPLISHED, ANY SOIL THAT WILL NOT PROVIDE A SUITABLE ENVIRONMENT TO SUPPORT ADEQUATE VEGETATIVE GROUND COVER, SHALL BE REMOVED OR TREATED IN SUCH A WAY THAT WILL PERMANENTLY ADJUST THE SOIL CONDITIONS AND RENDER IT SUITABLE FOR VEGETATIVE GROUND COVER. IF THE REMOVAL OR TREATMENT OF THE SOIL WILL NOT PROVIDE SUITABLE CONDITIONS, NON-VEGETATIVE MEANS OF PERMANENT GROUND STABILIZATION WILL HAVE TO BE EMPLOYED.
10. CONDUIT OUTLET PROTECTION MUST BE INSTALLED AT ALL REQUIRED OUTFALLS PRIOR TO THE DRAINAGE SYSTEM BECOMING OPERATIONAL.
11. UNFILTERED DEWATERING IS NOT PERMITTED. THE CONTRACTOR SHALL TAKE ALL NECESSARY PRECAUTIONS DURING ALL DEWATERING OPERATIONS TO MINIMIZE SEDIMENT TRANSFER.
12. SHOULD THE CONTROL OF DUST AT THE SITE BE NECESSARY, THE SITE WILL BE SPRINKLED UNTIL THE SURFACE IS WET, TEMPORARY VEGETATION COVER SHALL BE ESTABLISHED OR MULCH SHALL BE APPLIED IN ACCORDANCE WITH STATE STANDARDS FOR EROSION CONTROL.
13. ALL SOIL WASHED, DROPPED, SPILLED OR TRACKED OUTSIDE THE LIMIT OF DISTURBANCE OR ONTO PUBLIC RIGHTS-OF-WAY WILL BE REMOVED IMMEDIATELY.
14. THE CONTRACTOR SHALL BE RESPONSIBLE FOR ANY EROSION OR SEDIMENTATION THAT MAY OCCUR BELOW STORMWATER OUTFALLS OR OFFSITE AS A RESULT OF CONSTRUCTION OF THE PROJECT.
15. ALL SOIL STOCKPILES ARE TO BE TEMPORARILY STABILIZED IN ACCORDANCE WITH SOIL EROSION AND SEDIMENT CONTROL NOTE NUMBER 2 (ABOVE).
16. THE SITE SHALL AT ALL TIMES BE GRADED AND MAINTAINED SUCH THAT ALL STORM WATER RUNOFF IS DIVERTED TO SOIL EROSION AND SEDIMENT CONTROL FACILITIES.
17. ALL SEDIMENTATION STRUCTURES SHALL BE INSPECTED AND MAINTAINED REGULARLY.
18. ALL CATCH BASIN INLETS SHALL BE PROTECTED WITH HAY BALES AS SHOWN ON DETAIL.
19. THE CONTRACTOR SHALL PREPARE A PLAN FOR THE PROPER DEWATERING AND DOWNSTREAM SILTATION PROTECTION OF EACH STREAM CROSSING PRIOR TO EXCAVATING THE STREAM BED. PLAN SHALL BE FORWARDED TO THE ENGINEER FOR APPROVAL. THE ENGINEER SHALL BE NOTIFIED FOR INSPECTION PRIOR TO EACH STREAM CROSSING CONSTRUCTION.
20. ANY AREAS USED FOR THE CONTRACTOR'S STAGING, INCLUDING BUT NOT LIMITED TO, TEMPORARY STORAGE OF STOCKPILED MATERIALS (E.G. CRUSHED STONE, QUARRY PROCESS STONE, SELECT FILL, EXCAVATED MATERIALS, ETC.), SHALL BE ENTIRELY PROTECTED BY A SILT FENCE ALONG THE LOW ELEVATION SIDE TO CONTROL SEDIMENT RUNOFF.

* WHERE APPLICABLE

TEMPORARY SEEDING DETAILS:

SEED BED PREPARATION:
SOIL TO BE THOROUGHLY PULVERIZED BY DISK-HARROWING AND BE LOOSE AND REASONABLY SMOOTH. APPLY FERTILIZER AT A RATE OF 260 LBS./ACRE OF 16-16-16 OR EQUIVALENT. APPLY DOLOMITIC LIMESTONE AT A RATE OF 800 TO 1000 LBS./ACRE TO PROVIDE A SOIL pH OF 6.5 TO 6.8. LIME & FERTILIZER TO BE WORKED INTO THE TOPSOIL TO A DEPTH OF 4". ADD SANDY LOAM TOPSOIL TO A MINIMUM OF TWO (2) INCHES WHERE REQUIRED.

SEED MIXTURE
CONSISTING OF ANNUAL RYE (LOLIUM MULTIFLORUM) AT A RATE OF 174 LBS./ACRE.

PERMANENT SEEDING DETAILS:

SEED BED PREPARATION:
SOIL TO BE THOROUGHLY PULVERIZED BY DISK-HARROWING AND BE LOOSE AND REASONABLY SMOOTH. APPLY FERTILIZER AT A RATE OF 260 LBS./ACRE OF 16-16-16 OR EQUIVALENT, APPLY DOLOMITIC LIMESTONE AT A RATE OF 800 TO 1000 LBS./ACRE TO PROVIDE A SOIL pH OF 6.5 TO 6.8. LIME & FERTILIZER TO BE WORKED INTO THE TOPSOIL TO A DEPTH OF 4". ADD SANDY LOAM TOPSOIL TO A MINIMUM OF TWO (2) INCHES WHERE REQUIRED.

SEED MIXTURE CONSISTING OF	RATE	PURITY	GERMINATION
ARGENTINE BAHIA	260 LBS./AC.	95%	80%
PENSACOLA BAHIA	260 LBS./AC.	95%	40%(MIN)-80%(TOTAL)

SODDING:
SOD SHALL BE WELL ROOT MATTED CENTIPEDE OR BAHIA GRASS COMMERCIALY CUT TO A MINIMUM DIMENSION OF 12" x 24" A MAXIMUM OF 72 HOURS PRIOR TO PLACEMENT. SOD SHALL BE LIVE, FRESH AND UNINJURED. REASONABLY FREE OF WEEDS AND OTHER GRASSES, WITH A HEAVY SOIL MAT ADHERING TO THE ROOT SYSTEM. SOD SHALL BE GROWN, CUT, AND SUPPLIED BY A STATE CERTIFIED GROWER.

TRAFFIC CONTROL STANDARDS:
1. CONSTRUCTION TRAFFIC SHALL BE RESTRICTED TO ON-SITE ACCESS BY MEANS SO DESIGNATED BY THE ENGINEER, POLICE/SHERIFF DEPARTMENT, ESCAMBIA COUNTY HIGHWAY DEPARTMENT, AND/OR THE FLORIDA DEPARTMENT OF TRANSPORTATION.
2. TRAFFIC DURING WET WEATHER SHALL BE MINIMIZED AND APPROPRIATE ROADWAY AND SITE CLEAN-UP SHALL BE PROVIDED BY THE CONTRACTOR AS SOON AS WEATHER CONDITIONS PERMIT.

TREE PROTECTION:
1. DAMAGED TRUNKS OR EXPOSED ROOTS WILL BE PAINTED IMMEDIATELY WITH A GOOD GRADE OF TREE PAINT.
2. TREE LIMB REMOVAL, WHERE NECESSARY, WILL BE DONE FLUSH TO TRUNK OR MAIN BRANCH AND THAT AREA PAINTED IMMEDIATELY WITH A GOOD GRADE OF TREE PAINT.

DUST CONTROL:

1. ALL AREAS OF CLEARING AND EMBANKMENT AS WELL AS CONSTRUCTION HAUL ROADS SHALL BE TREATED AND MAINTAINED IN SUCH A MANNER AS TO MINIMIZE ANY DUST GENERATION.
2. DISTURBED AREAS SHALL BE MAINTAINED IN A ROUGH GRADED CONDITION AND TEMPORARILY SEEDING AND/OR MULCHED UNTIL PROPER WEATHER CONDITIONS EXIST FOR THE ESTABLISHMENT OF PERMANENT VEGETATION COVER.
3. IN EVENT OF EMERGENCY CONDITIONS, TILLAGE WILL BE SATISFACTORY FREE BEFORE SOIL BLOWING STARTS.
4. CALCIUM CHLORIDE MAY BE APPLIED TO UNPAVED ROADWAY AREAS, ONLY, SUBJECT TO THE ENGINEER'S APPROVAL AND CONFORMANCE WITH FDOT STANDARD SPECIFICATIONS, SECTION 102-5, LATEST EDITION.

PROPOSED SEQUENCE OF CONSTRUCTION:

1. THE INSTALLATION OF ALL SEDIMENT AND EROSION CONTROL DEVICES THAT CAN BE PLACED PRIOR TO ANY MAJOR SOIL DISTURBANCES.
2. CLEAR AND REMOVE ALL EXISTING VEGETATION IN THOSE AREAS WHERE NECESSARY. ALL REMAINING VEGETATION IS TO BE PROPERLY PROTECTED AND IS TO REMAIN IN ITS NATURAL STATE. TOPSOIL IN AREAS TO BE DISTURBED IS TO BE STRIPPED TO A MINIMUM DEPTH OF SIX (6) INCHES AND STOCKPILED SEPARATELY FROM OTHER EXCAVATED SOIL(S).
3. THE IMMEDIATE INSTALLATION OF ALL REMAINING SEDIMENT AND EROSION CONTROL DEVICES.
4. PERFORM ALL DEMOLITION WORK.
5. CONSTRUCT ALL UNDERGROUND UTILITIES AND STORM DRAIN SYSTEMS.
6. CONSTRUCT ROADS (SUBGRADE, CURB & GUTTER, BASE, PAVEMENT, SIDEWALKS AND LANDSCAPING).
7. COMPLETE STORMWATER PONDS.
8. UPON THE COMPLETION OF THE CONSTRUCTION ACTIVITIES, PROVIDE RESTORATION, FINE GRADE REMAINDER OF SITE, RESPREAD STOCKPILED TOPSOIL AND STABILIZE WITH PERMANENT VEGETATIVE COVER AND LANDSCAPING.
9. THE REMOVAL OF APPROPRIATE TEMPORARY SEDIMENT AND EROSION CONTROL DEVICES.

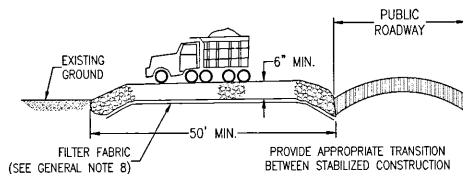

STABILIZED CONSTRUCTION ENTRANCE DETAIL
N.T.S.



TREE BARRICADE DETAIL
N.T.S.

DESCRIPTION:
FILTER BAGS WILL BE USED AS AN EFFECTIVE FILTER MEDIUM TO CONTAIN SAND, SILT AND FINES WHEN TRENCH DEWATERING. THE WETLAND FILTER BAG CONTAINS THESE MATERIALS WHILE ALLOWING THE WATER TO FLOW THROUGH THE FABRIC.

INSTALLATION:
WETLAND FILTER BAGS MAY REPLACE HAY BALE CORRALS DURING TRENCH DEWATERING, AT THE DISCRETION OF THE ENGINEER INSPECTOR. TO INSURE PROPER INSTALLATION, FILTER BAGS WILL BE PLACED ON RELATIVELY FLAT TERRAIN FREE OF BRUSH AND STUMPS TO AVOID RUPTURES AND PUNCTURES. PROPER INSTALLATION REQUIRES CUTTING A SMALL HOLE IN THE CORNER OF THE BAG, INSERTING THE PUMP DISCHARGE HOSE, AND THEN SECURING THE DISCHARGE HOSE TO THE BAG WITH A HOSE CLAMP. FILTER BAGS WILL BE PLACED AS FAR AWAY FROM FLOWING STREAMS AND WETLANDS AS POSSIBLE.

MAINTENANCE:
PRIOR TO REMOVING A BAG FROM THE HOSE, THE BAG WILL BE TIED OFF BELOW THE END OF THE HOSE ALLOWING THE BAG TO DRAIN. DRAINAGE WILL NOT BE ALLOWED THROUGH THE INLET HOLE. TO AVOID RUPTURE, THE BAGS WILL BE ATTENDED AND PUMPING RATES MONITORED. ONCE THE BAG IS INFLATED TO A HEIGHT OF 4 FEET, PUMPING WILL STOP TO AVOID RUPTURE. FILTER BAGS USED DURING CONSTRUCTION WILL BE BUNDLED AND REMOVED FOR PROPER DISPOSAL.

SELECTION:
FILTER BAGS ARE CONSTRUCTED OF NON-WOVEN GEOTEXTILE FABRIC. A MAXIMUM OF ONE SIX INCH DISCHARGE HOSE WILL BE ALLOWED PER FILTER BAG. BAG CAPACITY WILL BE EXCEEDED BEYOND 2,000 GALLONS PER MINUTE. TYPICAL BAG DIMENSIONS ARE 15 FEET BY 13.25 FEET. TO HELP PREVENT PUNCTURES, GEOTEXTILE FABRIC WILL BE PLACED BENEATH THE FILTER BAG WHEN USED IN WOODED LOCATIONS. UNATTENDED FILTER BAGS WILL BE ENCIRCLED WITH A HAY BALE OR SILT FENCE CORRAL. HOSE CLAMPS WILL BE USED TO SECURE THE DISCHARGE HOSE. WIRE OR STRING WILL NOT BE USED.

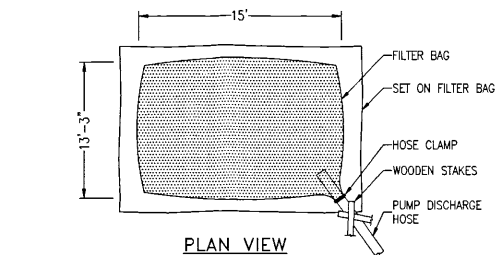

FILTER BAG DETAIL FOR TRENCH DEWATERING OPERATIONS
N.T.S.

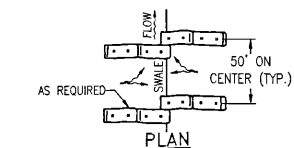

BARRIERS FOR FILL SLOPES
N.T.S.

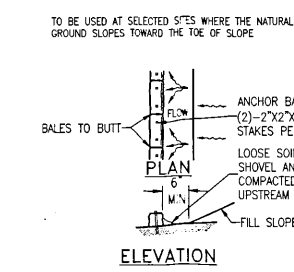

BARRIER FOR UNPAVED DITCH
N.T.S.

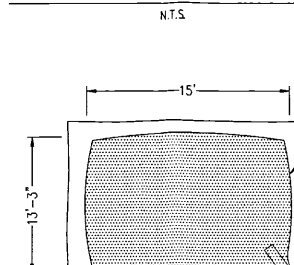

BARRIER FOR PAVED DITCH
N.T.S.

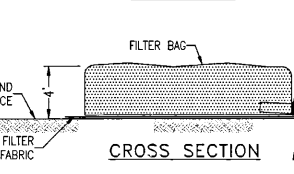

PROTECTION AROUND INLETS OR SIMILAR STRUCTURES
N.T.S.

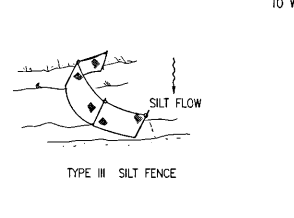
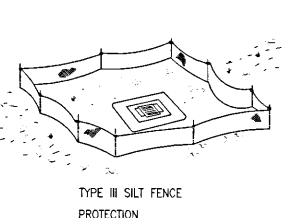
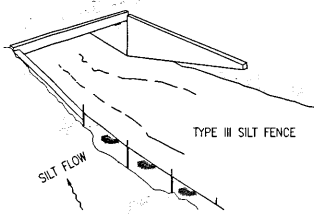

SILT FENCE APPLICATIONS
N.T.S.

DO NOT DEPLOY IN A MANNER THAT SILT FENCES WILL ACT AS A DAM ACROSS PERMANENT FLOWING WATERCOURSES. SILT FENCES ARE TO BE USED AT UPLAND LOCATIONS AND TURBIDITY BARRIERS USED AT PERMANENT BODIES OF WATER.

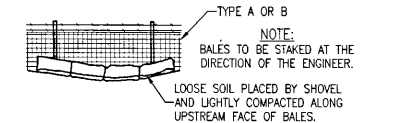

STRAW BALES BACKED BY FENCE
N.T.S.

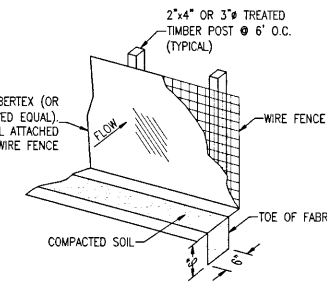

SILT FENCE DETAIL
N.T.S.

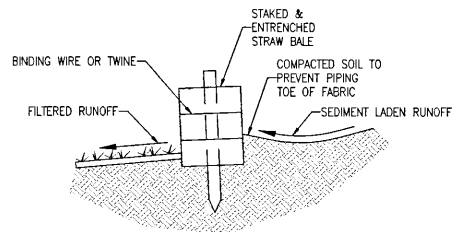

STRAW BALE DETAIL
N.T.S.

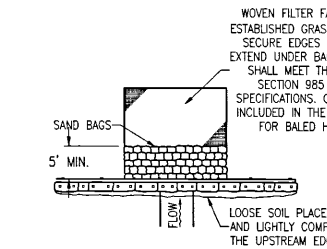

MATERIAL STOCKPILE DETAIL
N.T.S.

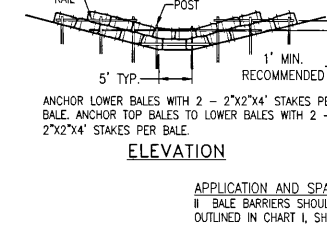

PARTIAL INLET

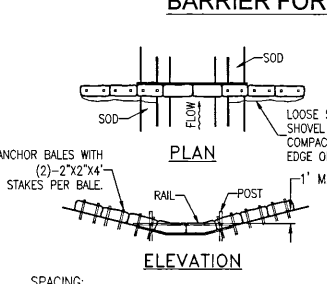

COMPLETED INLET

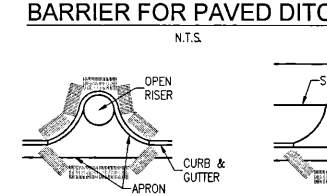

DITCH BOTTOM INLET

RBA
REBOL-BATTLE & ASSOCIATES
Civil Engineers and Surveyors
2301 N. North Avenue, Suite 300
Pensacola, Florida 32503
Telephone 850.088.0400 Fax 850.435.0448
E8 00006857 12/19/16

EROSION CONTROL DETAILS

CORT BUSINESS SERVICES
503 WEST BURGESS ROAD
ESCAMBIA, FLORIDA

REVISION	DATE	ESCO COMMENTS
1	01/04/2017	

SEAL
No. 53126
STATE OF FLORIDA
Paul A. Battle, P.E.
No. 53126
DATE: 12-16-2016

DRAWING No.
C1.1
SHEET 3 OF 11

This drawing is the property of Rebol-Battle & Associates, and shall not be reproduced without written permission.

STORM WATER POLLUTION PREVENTION PLAN

1.0 BACKGROUND & REQUIREMENTS:

1.1 INTRODUCTION:

THE REFERENCED SUPPORT DOCUMENTATION FOR THIS STORM WATER POLLUTION PREVENTION PLAN (SWPPP) IS THE UNITED STATES ENVIRONMENTAL PROTECTION AGENCY'S (EPA) STORM WATER MANAGEMENT FOR CONSTRUCTION ACTIVITIES, DEVELOPING POLLUTION PREVENTION PLANS AND BEST MANAGEMENT PRACTICES SUMMARY GUIDANCE (EPA 833-R-92-001) AND STORM WATER MANAGEMENT FOR CONSTRUCTION ACTIVITIES, DEVELOPING POLLUTION PREVENTION PLANS AND BEST MANAGEMENT PRACTICES (EPA 832-R-92-005). THIS SWPPP IS DESIGNED TO PROTECT ONSITE AND ADJACENT NATURAL RESOURCES, INCLUDING BUT NOT LIMITED TO, WETLANDS, MARSHES, BAYOUS AND BAYS, WHILE PRESERVING WILDLIFE AND ARCHEOLOGICAL RESOURCES.

AN ENVIRONMENTAL RESOURCE PERMIT APPLICATION HAS BEEN SUBMITTED TO THE NWFWD DECEMBER 2016

1.2 NOTICE OF INTENT (NOI):

RULE 62-621.300(4), FAC REQUIRES THE CONSTRUCTION OPERATOR OF A SITE THAT DISTURBS ONE OR MORE ACRES TO OBTAIN COVERAGE FROM THE GENERIC PERMIT FOR STORMWATER DISCHARGE FROM LARGE AND SMALL CONSTRUCTION ACTIVITIES. THE CONTRACTOR IS REQUIRED TO SUBMIT A NOTICE OF INTENT TO USE GENERIC PERMIT FOR STORMWATER DISCHARGE FROM LARGE AND SMALL CONSTRUCTION ACTIVITIES (FDEP FORM 62-621.300(4)(B)) ALONG WITH THE APPROPRIATE APPLICATION FEE TO THE FOLLOWING ADDRESS 48 HOURS PRIOR TO COMMENCING CONSTRUCTION:

NPDES STORMWATER NOTICES CENTER, MS # 2510
FLORIDA DEPARTMENT OF ENVIRONMENTAL PROTECTION
2600 BLAIR STONE ROAD
TALLAHASSEE, FLORIDA 32399-2400

THIS FORM CAN BE OBTAINED FROM FDEP'S WEBSITE (WWW.DEP.STATE.FL.US) OR BY CONTACTING FDEP. PLEASE NOTE THAT THE CURRENT APPLICATION FEE IS \$300; HOWEVER, THIS FEE IS SUBJECT TO CHANGE WITHOUT NOTICE. ALWAYS REFER TO THE MOST CURRENT VERSION OF RULE 62-4.050(4)(D), FAC TO CONFIRM THE AMOUNT BEFORE SUBMITTING PAYMENT. IF CONSTRUCTION ACTIVITY EXCEEDS FIVE YEARS, THE CONTRACTOR MUST RE-APPLY FOR COVERAGE.

1.3 STORMWATER POLLUTION PREVENTION PLAN (SWPPP):

THE CONTRACTOR IS REQUIRED TO CERTIFY THIS STORMWATER POLLUTION PREVENTION PLAN (SWPPP) BELOW PRIOR TO SUBMITTING THE NOI. THIS SWPPP IS NOT REQUIRED TO BE SUBMITTED WITH THE NOI, BUT IS REQUIRED TO BE KEPT ON SITE DURING ALL PHASES OF CONSTRUCTION. BECAUSE EROSION AND SEDIMENT CONTROLS AND CONSTRUCTION METHODS VARY SIGNIFICANTLY FROM CONTRACTOR TO CONTRACTOR, THE CONTRACTOR CAN PROPOSE ALTERNATIVE METHODS TO THIS SWPPP THAT ARE EQUAL OR BETTER AT CONTROLLING EROSION AND SEDIMENTATION. AT A MINIMUM, THE CONTRACTOR MUST FOLLOW THE EROSION CONTROL PLAN SPECIFIED IN THE CONSTRUCTION PLANS AND DOCUMENTS. ANY MODIFICATIONS TO THIS SWPPP MUST BE DOCUMENTED AND KEPT WITH THE PLAN AS PART OF THE RECORDS KEEPING PROCESS TO BE IN FULL COMPLIANCE WITH THE CGP.

1.4 CONTRACTOR'S / SUBCONTRACTOR CERTIFICATION:

I CERTIFY UNDER PENALTY OF LAW THAT I UNDERSTAND AND SHALL COMPLY WITH, THE TERMS AND CONDITIONS OF THE STATE OF FLORIDA GENERIC PERMIT FOR STORMWATER DISCHARGE FROM LARGE AND SMALL CONSTRUCTION ACTIVITIES AND THIS STORMWATER POLLUTION PREVENTION PLAN PREPARED THEREUNDER.

<u>PRINT & SIGN NAME</u>	<u>COMPANY & ADDRESS</u>
_____	_____
_____	_____

NAME & TITLE (PRINT)

SIGNATURE _____ DATE _____

1.5 RESPONSIBLE AUTHORITY CERTIFICATION:

I CERTIFY UNDER PENALTY OF LAW THAT THIS DOCUMENT AND ALL ATTACHMENTS WERE PREPARED UNDER MY DIRECTION OR SUPERVISION IN ACCORDANCE WITH A SYSTEM DESIGNED TO ASSURE THAT QUALIFIED PERSONNEL GATHERED AND EVALUATED THE INFORMATION SUBMITTED. BASED ON MY INQUIRY OF THE PERSON OR PERSONS WHO MANAGE THE SYSTEM, OR THOSE PERSONS DIRECTLY RESPONSIBLE FOR GATHERING THE INFORMATION, THE INFORMATION SUBMITTED IS, TO THE BEST OF MY KNOWLEDGE AND BELIEF, TRUE, ACCURATE, AND COMPLETE. I AM AWARE THAT THERE ARE SIGNIFICANT PENALTIES FOR SUBMITTING FALSE INFORMATION, INCLUDING THE POSSIBILITY OF FINE AND IMPRISONMENT FOR KNOWING VIOLATIONS.

<u>PRINT & SIGN NAME</u>	<u>COMPANY & ADDRESS</u>
_____	_____
_____	_____

NAME & TITLE (PRINT)

SIGNATURE _____ DATE _____

1.6 NOTICE OF TERMINATION (NOT):

THE CONTRACTOR IS REQUIRED TO SUBMIT A NOTICE OF TERMINATION OF GENERIC PERMIT COVERAGE (FDEP FORM 62-621.300(6)) UPON CONSTRUCTION COMPLETION TO DISCONTINUE PERMIT COVERAGE. THE NOT IS TO BE SUBMITTED TO THE FOLLOWING ADDRESS:

NPDES STORMWATER NOTICES CENTER, MS # 2510
FLORIDA DEPARTMENT OF ENVIRONMENTAL PROTECTION
2600 BLAIR STONE ROAD
TALLAHASSEE, FLORIDA 32399-2400

THIS FORM CAN BE OBTAINED FROM FDEP'S WEBSITE (WWW.DEP.STATE.FL.US) OR BY CONTACTING FDEP. THE NOT CAN NOT BE SUBMITTED UNTIL ALL DISTURBED SOILS AT THE CONSTRUCTION SITE HAVE BEEN FINALLY STABILIZED AND TEMPORARY EROSION AND SEDIMENT CONTROL MEASURES HAVE BEEN REMOVED OR WILL BE REMOVED AT AN APPROPRIATE TIME. FINAL STABILIZATION MEANS THAT ALL SOIL DISTURBING ACTIVITIES AT THE SITE HAVE BEEN COMPLETED AND THAT A UNIFORM PERENNIAL VEGETATIVE COVER WITH A DENSITY OF 70 PERCENT OF THE COVER FOR UNPAVED AREAS AND AREAS NOT COVERED BY PERMANENT STRUCTURES HAS BEEN ESTABLISHED, OR EQUIVALENT STABILIZATION MEASURES HAVE BEEN EMPLOYED. IF CONSTRUCTION ACTIVITY EXCEEDS FIVE YEARS, THE CONTRACTOR MUST RE-APPLY FOR COVERAGE.

1.7 APPLICATION INFORMATION:

PROJECT ADDRESS: 401 W. BURGESS ROAD
PENSACOLA, FL 32503

LATITUDE: N 30°29'49.55"
LONGITUDE: W 87°15'42.58"

WATER MANAGEMENT DISTRICT: NORTHWEST FLORIDA (NWFWD)

MS4 OPERATOR NAME: FDOT

RECEIVING WATER NAME: FDOT MS4

2.0 SITE DESCRIPTION:

2.1 NATURE OF CONSTRUCTION ACTIVITIES:

THIS PROJECT INVOLVES THE CONSTRUCTION OF A 15,000 SF. COMMERCIAL BUILDING. CONSTRUCTION INCLUDES PARKING, UTILITIES AND STORMWATER COLLECTION SYSTEM.

2.2 SEQUENCE OF MAJOR SOIL DISTURBING ACTIVITIES:

THE FOLLOWING SEQUENCE OF MAJOR ACTIVITIES SHALL BE FOLLOWED UNLESS THE CONTRACTOR CAN PROPOSE AN ALTERNATIVE THAT IS EQUAL TO OR BETTER AT CONTROLLING EROSION AND SEDIMENTATION. THE DETAILED SEQUENCE FOR THE ENTIRE PROJECT CAN VARY SIGNIFICANTLY FROM CONTRACTOR TO CONTRACTOR. THE CONTRACTOR IS RESPONSIBLE FOR DOCUMENTING ANY CHANGES.

1. CLEAR, GRUB AND PERFORM ALL DEMOLITION WORK.
2. COMPLETE ROUGH GRADING OF THE POND AND DIRECT ALL STORMWATER RUNOFF TO THE POND(S).
3. CONSTRUCT ALL UNDERGROUND UTILITIES AND STORM DRAIN SYSTEM.
4. CONSTRUCT ROADS (SUBGRADE, CURB & GUTTER, BASE, PAVEMENT, SIDEWALKS, AND LANDSCAPING).
5. COMPLETE STORMWATER PONDS.

2.3 AREA ESTIMATES:

ONSITE AREA: 0.93 ACRES
OFFSITE AREA: 0.93 ACRES
TOTAL AREA: 0.93 ACRES
AREA TO BE DISTURBED: 0.93 ACRES

2.4 RUNOFF DATA:

RUNOFF COEFFICIENTS (C):

BEFORE: TOTAL COMPOSITE C = 0.95

DURING: VARIES BETWEEN = 0.20 AND 0.95

AFTER: VARIES BETWEEN = 0.20 AND 0.95

TOTAL COMPOSITE C = 0.95

SOILS DATA:
THE SOILS LOCATED AT THE SITE ARE PREDOMINATELY VERY LOOSE TO LOOSE SLIGHTLY SILTY SANDS. GROUNDWATER WAS NOT ENCOUNTERED IN THE 15 FT TO 20 FT DEEP TEST BORING. FOR MORE DETAILED SOILS INFORMATION, REFER TO THE GEOTECHNICAL SERVICES REPORT PREPARED BY UNIVERSAL ENGINEERING SERVICES.

DRAINAGE AREAS FOR EACH OUTFALL:

<u>OUTFALL LOCATION</u>	<u>TOTAL AREA FLOWING TO POND</u>	<u>'C' COEFFICIENT</u>
EXISTING CONVEYANCE	0.70	2.00
FDOT MS4		

2.5 SITE MAP:

THE CONSTRUCTION PLANS ARE TO BE USED AS THE SITE MAPS. THE LOCATION OF THE REQUIRED INFORMATION IS DESCRIBED BELOW. THE SHEET NUMBERS FOR ALL THE ITEMS DISCUSSED BELOW ARE IDENTIFIED ON THE KEY SHEET OF THE CONSTRUCTION PLANS.

• **DRAINAGE PATTERNS:** ALL DRAINAGE PATTERNS ARE SHOWN ON THE GRADING & DRAINAGE PLANS.

• **APPROXIMATE SLOPES:** APPROXIMATE SLOPES ARE SHOWN ON THE GRADING & DRAINAGE POND SIDE SLOPES ARE SHOWN ON THE POND CROSS-SECTIONS.

• **AREAS OF SOIL DISTURBANCE:** ALL DEMOLITION IS SHOWN ON THE EXISTING SITE CONDITIONS AND DEMOLITION AND EROSION CONTROL PLAN SHEET. ALL PROPOSED CONSTRUCTION IS SHOWN ON THE REMAINING PLANS. ANY AREAS WHERE DEMOLITION WORK OR PERMANENT FEATURES ARE SHOWN ABOVE OR BELOW GROUND WILL BE DISTURBED.

• **AREAS NOT TO BE DISTURBED:** ANY AREAS NOT SHOWING DEMOLITION WORK OR PERMANENT FEATURES ARE ASSUMED NOT TO BE DISTURBED. IT WILL BE THE CONTRACTOR'S RESPONSIBILITY TO INDICATE ON THE PLANS ANY OF THESE AREAS THAT DO GET DISTURBED AS WELL AS ANY AREAS USED FOR STAGING AND MATERIALS STORAGE.

• **LOCATIONS OF CONTROLS:** ALL PROPOSED TEMPORARY CONTROLS AND EXISTING PERMANENT CONTROLS ARE SHOWN ON THE EXISTING SITE, DEMOLITION AND EROSION CONTROL PLAN. ALL PROPOSED PERMANENT CONTROLS ARE SHOWN ON THE REMAINING PLANS. IT WILL BE THE CONTRACTOR'S RESPONSIBILITY TO INDICATE THE LOCATION OF ANY OTHER CONTROLS ON THE PLANS THAT ARE USED DURING CONSTRUCTION.

• **PERMANENT STABILIZATION IS SHOWN ON THE PLANS. IT WILL BE THE CONTRACTOR'S RESPONSIBILITY TO INDICATE THE LOCATION ON THE PLANS OF ALL TEMPORARY STABILIZATION PRACTICES USED DURING CONSTRUCTION.**

• **SURFACE WATERS:** N/A

DISCHARGE POINTS: FDOT MS4

2.6 RECEIVING WATERS:

FDOT MS4

3.0 CONTROLS:

3.1 EROSION AND SEDIMENT CONTROLS:

ALL EROSION AND SEDIMENT CONTROLS SPECIFIED ON THE DEMOLITION AND EROSION CONTROL PLAN SHEETS, AND THE EROSION CONTROL DETAILS SHALL BE INSTALLED PRIOR TO ANY CONSTRUCTION OR DEMOLITION. SILT FENCING AND STAKED HAY BALES SHALL BE INSTALLED ALONG DOWN-GRADE LIMITS.

TEMPORARY SEEDING AND MULCHING SHALL BE APPLIED AFTER 14-DAY INTERVALS OF CEASED DISTURBANCE ACTIVITIES THAT WILL EXCEED 20-DAY PERIODS. GRADED AREAS SHALL BE STABILIZED WITH PERMANENT SEEDING, MULCHING, AND FERTILIZING, OR SODDING WITHIN FIVE DAYS OF FINAL GRADING. LANDSCAPING, INCLUDING SODDING, SHALL BE INSTALLED BY AN EXPERIENCED LANDSCAPE CONTRACTOR. PROPOSED DISTURBED AREAS WILL NOT EXCEED 8 ACRES IN ANY DRAINAGE AREA.

3.2 STORMWATER MANAGEMENT:

PROPOSED STORMWATER MANAGEMENT FACILITIES FOR THIS SITE INCLUDE: A DRY RETENTION POND AND SWALE FOR THE ENTIRE PROPERTY.

THE PROPOSED STORMWATER MANAGEMENT FACILITIES MEET ALL STORMWATER TREATMENT REQUIREMENTS AND ALL RATE CONTROL REQUIREMENTS SET FORTH BY THE LOCAL AND STATE REGULATORY AGENCIES.

3.3 OTHER CONTROLS:

WASTE DISPOSAL: THE CONTRACTOR IS RESPONSIBLE FOR ALL WASTE DISPOSAL FROM THE SITE. THE CONTRACTOR SHALL EMPLOY WASTE DISPOSAL PRACTICES THAT MEET ALL LOCAL, STATE, AND FEDERAL GUIDELINES AND PREVENT DISCHARGE OF SOLID MATERIALS TO WATERS OF THE UNITED STATES. THE CONTRACTOR IS RESPONSIBLE FOR DOCUMENTING THIS PORTION OF THE SWPPP.

OFFSITE VEHICLE TRACKING: IF OFF SITE TRACKING OF SEDIMENTS BY CONSTRUCTION VEHICLES OCCURS, THE CONTRACTOR IS REQUIRED TO INSTALL A SOIL TRACKING PREVENTION DEVICE (STPD) AS PER FDOT STANDARD INDEX 106 AT ALL EXITS TO THE SITE WHERE SEDIMENT TRACKING IS OCCURRING. THE CONTRACTOR IS ALSO RESPONSIBLE FOR DOCUMENTING THIS PORTION OF THE SWPPP.

HAZARDOUS MATERIALS: ALL POLLUTANTS AND HAZARDOUS MATERIALS INCLUDING BUT NOT LIMITED TO FERTILIZERS, HERBICIDES, PESTICIDES, SOLVENTS, OILS AND OIL FILTERS, PETROLEUM PRODUCTS, PAINT, AND EQUIPMENT MAINTENANCE FLUIDS, SHALL BE STORED INDOORS OR UNDER COVER IN AREAS WITH SECONDARY CONTAINMENT. SECONDARY CONTAINMENT PREVENTS A SPILL FROM SPREADING ACROSS THE SITE AND INCLUDES DIKES, BERMS, CURBING, OR OTHER CONTAINMENT METHODS. HAZARDOUS MATERIAL STORAGE AREAS SHALL BE INSPECTED WEEKLY AND AFTER STORM EVENTS. STORAGE AREAS SHALL BE KEPT CLEAN, WELL ORGANIZED, AND EQUIPPED WITH AMPLE CLEANUP SUPPLIES/SPILL KITS AS APPROPRIATE FOR THE MATERIALS BEING STORED. MATERIAL SAFETY DATA SHEETS, MATERIAL INVENTORY, AND EMERGENCY CONTACT INFORMATION SHALL BE MAINTAINED ON-SITE. ALL PERSONNEL SHALL RECEIVE INSTRUCTION REGARDING PROPER PROCEDURES FOR HAZARDOUS MATERIAL HANDLING AND DISPOSAL. HAZARDOUS MATERIALS SHALL NOT BE DISPOSED OF INTO ON-SITE DUMPSTERS; HAZARDOUS MATERIALS SHALL BE DISPOSED OF IN ACCORDANCE WITH FEDERAL, STATE, AND MUNICIPAL REGULATIONS. VEHICLES AND EQUIPMENT WILL BE MAINTAINED OFF-SITE. ALL VEHICLES AND EQUIPMENT INCLUDING SUBCONTRACTOR VEHICLES WILL BE CHECKED FOR LEAKING OIL AND FLUIDS. VEHICLES LEAKING FLUIDS WILL NOT BE ALLOWED ON-SITE. DRIP PANS SHALL BE PLACED UNDER ALL VEHICLES AND EQUIPMENT THAT ARE PARKED OVERNIGHT.

APPLICATION OF FERTILIZERS, HERBICIDES, AND PESTICIDES: FERTILIZERS,

HERBICIDES, AND PESTICIDES SHALL BE DELIVERED TO THE SITE IN ORIGINAL, UNOPENED CONTAINERS BEARING MANUFACTURER'S CHEMICAL ANALYSIS, NAME, TRADE NAME, TRADEMARK, AND INDICATION OF CONFORMANCE TO STATE AND FEDERAL LAWS. FERTILIZERS, HERBICIDES, AND PESTICIDES SHALL BE IN APPLIED IN ACCORDANCE WITH THE MANUFACTURER'S SUGGESTED RATE.

5.0 INSPECTIONS:

QUALIFIED PERSONNEL SHALL INSPECT THE FOLLOWING ITEMS, BUT NOT LIMITED TO, AT LEAST ONCE EVERY SEVEN CALENDAR DAYS AND WITHIN 24 HOURS OF THE END OF A STORM THAT IS 0.25 INCHES OR GREATER. WHERE SITES HAVE BEEN FINALLY STABILIZED, INSPECTIONS SHALL BE CONDUCTED AT LEAST ONCE EVERY MONTH.

- POINTS OF DISCHARGE TO WATERS OF THE UNITED STATES.
- POINTS OF DISCHARGE TO MUNICIPAL SEPARATE STORM SEWER SYSTEMS.
- DISTURBED AREAS OF THE SITE THAT HAVE NOT BEEN FINALLY STABILIZED.
- AREAS USED FOR STORAGE OF MATERIALS THAT ARE EXPOSED TO PRECIPITATION.
- STRUCTURAL CONTROLS.
- STORMWATER MANAGEMENT SYSTEMS.
- LOCATIONS WHERE VEHICLES ENTER OR EXIT THE SITE.

6.0 NON-STORMWATER DISCHARGES:

THE CONTRACTOR SHALL BE RESPONSIBLE FOR REPORTING ANY HAZARDOUS SUBSTANCE SPILLS THAT MAY EQUAL OR EXCEED A REPORTABLE QUANTITY (RQ). REFER TO EPA'S LIST OF HAZARDOUS SUBSTANCES AND REPORTABLE QUANTITIES (EPA 40 CFR 302.4 & 117). V THIS LIST CAN BE OBTAINED FROM EPA'S WEBSITE (WWW.EPA.GOV) OR BY CONTACTING EPA. IF AN RQ RELEASE DOES OCCUR THE CONTRACTOR SHALL PERFORM THE FOLLOWING PROCEDURES:

- NOTIFY THE NATIONAL RESPONSE CENTER IMMEDIATELY AT 800-424-8802.
- PROVIDE WRITTEN DESCRIPTION OF THE RELEASE WITHIN 14 DAYS PROVIDING DATES, CAUSE AND PREVENTION METHODS TO THE REGIONAL EPA OFFICE.
- MODIFY THE SWPPP AS NECESSARY TO ADDRESS ADDED PREVENTION METHODS.

7.0 IMPLEMENTATION CHECKLIST:

7.1 RECORDS:

THE CONTRACTOR SHALL MAINTAIN RECORDS OF CONSTRUCTION ACTIVITIES INCLUDING, BUT NOT LIMITED TO:

- DATES WHEN MAJOR GRADING ACTIVITIES OCCUR.
- DATES WHEN CONSTRUCTION ACTIVITIES TEMPORARILY CEASE ON A PORTION OF THE SITE.
- DATES WHEN CONSTRUCTION ACTIVITIES PERMANENTLY CEASE ON A PORTION OF THE SITE.
- DATES WHEN STABILIZATION MEASURES ARE INITIATED ON THE SITE.

7.2 INSPECTION REPORTS:

THE CONTRACTOR SHALL PREPARE INSPECTION REPORTS SUMMARIZING THE FOLLOWING, BUT NOT LIMITED TO:

- NAME OF INSPECTOR.
- QUALIFICATIONS OF INSPECTOR.
- MEASURES/AREAS INSPECTED.
- OBSERVED CONDITIONS.
- CHANGES NECESSARY TO THE SWPPP.

7.3 RELEASES OF REPORTABLE QUANTITIES OF OIL OR HAZARDOUS MATERIALS:

THE CONTRACTOR SHALL REPORT ANY RELEASES OF REPORTABLE QUANTITIES OF OIL OR HAZARDOUS MATERIALS IF THEY OCCUR AS PER THE MEASURES OUTLINED IN SECTION 6.0 OF THE SWPPP.

7.4 SWPPP MODIFICATION:

THE CONTRACTOR SHALL MODIFY THE SWPPP AS NECESSARY TO:

- COMPLY WITH MINIMUM PERMIT REQUIREMENTS WHEN NOTIFIED BY FDEP THAT THE PLAN DOES NOT COMPLY.
- ADDRESS ANY CHANGES IN DESIGN, CONSTRUCTION OPERATIONS OR MAINTENANCE, WHICH HAS AN EFFECT ON THE POTENTIAL FOR DISCHARGE OF POLLUTANTS.
- PREVENT REOCCURRENCE OF REPORTABLE QUANTITY RELEASES OF HAZARDOUS MATERIAL OR OIL.

8.0 TERMINATION CHECKLIST:

THE FOLLOWING ITEMS SHALL BE COMPLETE BEFORE SUBMITTING THE NOT:

- ALL SOIL DISTURBING ACTIVITIES ARE COMPLETE.
- TEMPORARY EROSION AND SEDIMENT CONTROL MEASURES HAVE BEEN REMOVED OR WILL BE REMOVED AT AN APPROPRIATE TIME.
- ALL AREAS OF THE CONSTRUCTION SITE NOT OTHERWISE COVERED BY PERMANENT PAVEMENT OR STRUCTURE HAVE BEEN STABILIZED WITH UNIFORM PERENNIAL VEGETATIVE COVER WITH A DENSITY OF 70% OR EQUIVALENT MEASURES HAVE BEEN EMPLOYED.

RBA
REBOL-BATTLE & ASSOCIATES
Civil Engineers and Surveyors
2301 N. Ninth Avenue, Suite 300
Escambia, Florida 32116
Telephone: 850.438.0400 Fax: 850.438.0448
E-mail: 850.0009857 LB1916

NPDES - STORMWATER POLLUTION PREVENTION PLAN

CORT BUSINESS SERVICES
503 WEST BURGESS ROAD
ESCAMBIA, FLORIDA

REVISION	DATE	ESCO COMMENTS

NOI FOR CONSTRUCTION
No. 53126
12-16-2016
STATE OF FLORIDA
Paul A. Battle, P.E.
53126
DR BY GTP
Ch By MET
Job No. 12-16-2016-233
Date: 12-16-2016
DRAWING No.
C1.2
SHEET 4 OF 11

This drawing is the property of Rebol-Battle & Associates, and may not be reproduced without written permission.

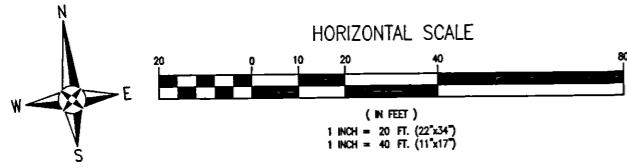

LEGEND	
	EXISTING ASPHALT
	EXISTING CONCRETE
	PROPOSED ASPHALT
	PROPOSED CONCRETE
	PROPOSED CHAIN LINK FENCE
	EXISTING FENCE
	BENCHMARK

- GENERAL NOTES:**
- NO LANE CLOSURES WILL BE ALLOWED ON HOLIDAYS INCLUDING THE DAY PRECEDING AND THE DAY FOLLOWING. NO LANE CLOSURES WILL BE ALLOWED DURING THE HOURS OF 6:00 AM TO 9:00 AM AND 3:00 PM TO 6:00 PM.
 - ALL PAVEMENT MARKINGS AND STRIPING SHALL BE THERMOPLASTIC AND INSTALLED ACCORDING TO FDOT STANDARD INDEX 17346.
 - ALL CONSTRUCTION IN RIGHTS-OF-WAY SHALL BE IN ACCORDANCE WITH FDOT SPECIFICATIONS.
 - ALL DISTURBED AREAS IN THE RIGHT-OF-WAY SHALL BE REGRADED AND SODDED AND/OR SEED AND MULCHED PER FDOT STANDARD INDEX 105.
 - ALL NEEDED STRIPING DESTROYED DURING CONSTRUCTION SHALL BE RE-STRIPED ACCORDING TO FDOT STANDARD INDEX 17346.
 - ALL LANES MUST BE OPEN FOR TRAFFIC DURING AN EVACUATION NOTICE OF A HURRICANE OR OTHER CATASTROPHIC EVENT AND SHALL REMAIN OPEN FOR THE DURATION OF THE EVACUATION OR EVENT AS DIRECTED BY THE LOCAL MAINTENANCE ENGINEER OR HIS DESIGNEE.
 - ALL SIGNS SHALL BE INSTALLED PER FDOT STANDARD INDEX 11865, WIND ZONE No.1.
 - ANY DAMAGE TO EXISTING ROADS DURING CONSTRUCTION WILL BE REPAIRED BY DEVELOPER PRIOR TO FINAL "AS-BUILT" SIGN OFF FROM THE COUNTY.

PARKING REQUIREMENTS:
 TOTAL REQUIRED PARKING SPACES (WAREHOUSE)
 (0.5 SPACE PER 1000 SF : 13,150 SF/1000*0.5=6.575 (7 SPACES)
 TOTAL PARKING SPACES REQUIRED = 7
 TOTAL PARKING SPACES PROVIDED = 22
 STANDARD PARKING SPACES = 20
 H.C. PARKING SPACES = 2
 (1 H.C. / 25 SPACES)

AREA CALCULATIONS (PROJECT AREA)
 PROJECT AREA = 40,677 SF

EXISTING BUILDING AREA = 2,482 SF
 EXISTING IMPERVIOUS AREA = 40,677 SF
 EXISTING PERVIOUS AREA = 0 SF

PROPOSED BUILDING AREA = 13,145 SF
 PROPOSED IMPERVIOUS AREA = 39,397 SF (97%)
 PROPOSED PERVIOUS AREA = 1,280 SF (3%)
 NO NET INCREASE IN IMPERVIOUS AREA.

SITE SIGNAGE:

NO SITE SIGNAGE IS PROPOSED FOR THIS FACILITY.

BURGESS ROAD STATE ROAD #742
 66' RIGHT-OF-WAY

S 06°05'11" W 468.49' (PS)
 S 06°04'00" W (D)

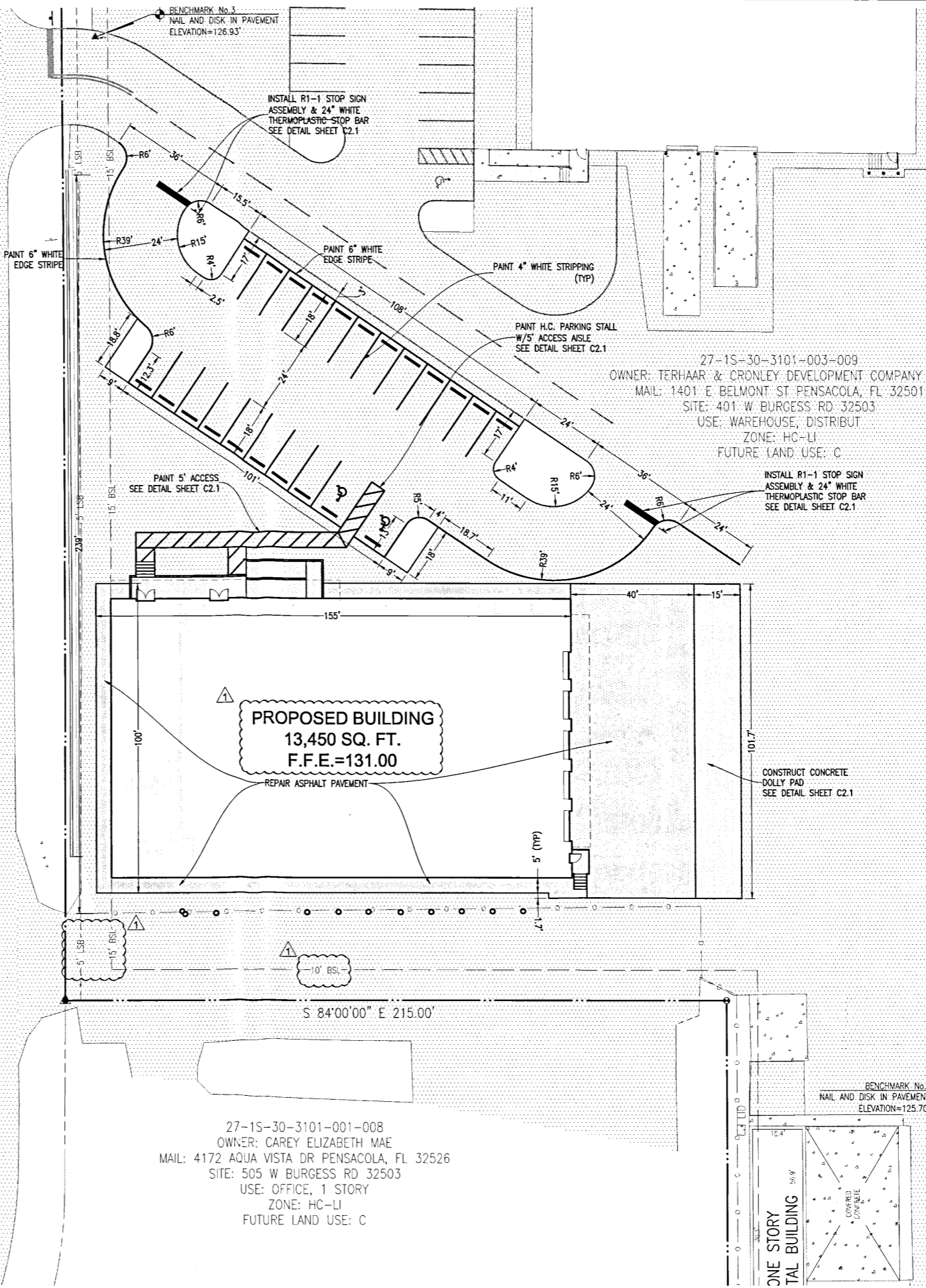

27-1S-30-3101-003-009
 OWNER: TERHAAR & CRONLEY DEVELOPMENT COMPANY, LC
 MAIL: 1401 E BELMONT ST PENSACOLA, FL 32501
 SITE: 401 W BURGESS RD 32503
 USE: WAREHOUSE, DISTRIBUT
 ZONE: HC-LI
 FUTURE LAND USE: C

PROPOSED BUILDING
 13,450 SQ. FT.
 F.F.E.=131.00

27-1S-30-3101-001-008
 OWNER: CAREY ELIZABETH MAE
 MAIL: 4172 AQUA VISTA DR PENSACOLA, FL 32526
 SITE: 505 W BURGESS RD 32503
 USE: OFFICE, 1 STORY
 ZONE: HC-LI
 FUTURE LAND USE: C

RBA
REBOL-BATTLE & ASSOCIATES
 Civil Engineers and Surveyors
 2501 N. Nebraska, Suite 300
 Pensacola, Florida 32503
 Telephone 850.438.1400 Fax 850.438.0448
 EB 00009687 1B7916

SITE LAYOUT & DIMENSION PLAN

CORT BUSINESS SERVICES
 503 WEST BURGESS ROAD
 ESCAMBIA, FLORIDA

REVISION	DATE	ESCO COMMENTS
1	01-04-2017	

NOT FOR CONSTRUCTION
 No. 53126
 STATE OF FLORIDA
 PAUL A. BATTLE, P.E.
 No. 84730
 Job No.: 2016.232
 Date: 12-16-2016

DRAWING No.
C2.0
 SHEET 5 OF 11

This drawing is the property of REBOL-BATTLE & ASSOCIATES and may not be reproduced without written permission.



FDOT STANDARD
R1-1
2'-0" x 2'-0"
N.T.S.

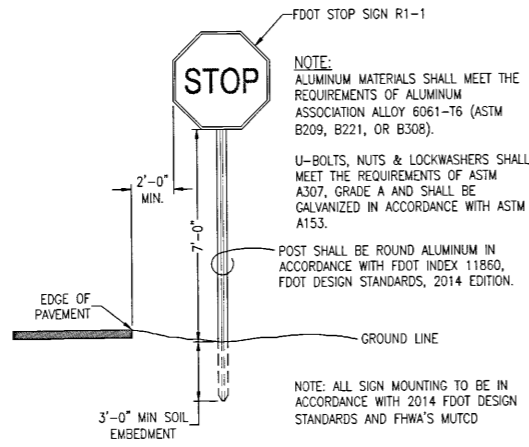

SIGN MOUNTING DETAIL
N.T.S.

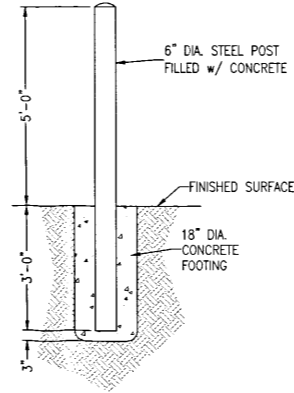

NOTE: SPACING BETWEEN BOLLARDS IS 6' MAX.

BOLLARD DETAIL
N.T.S.

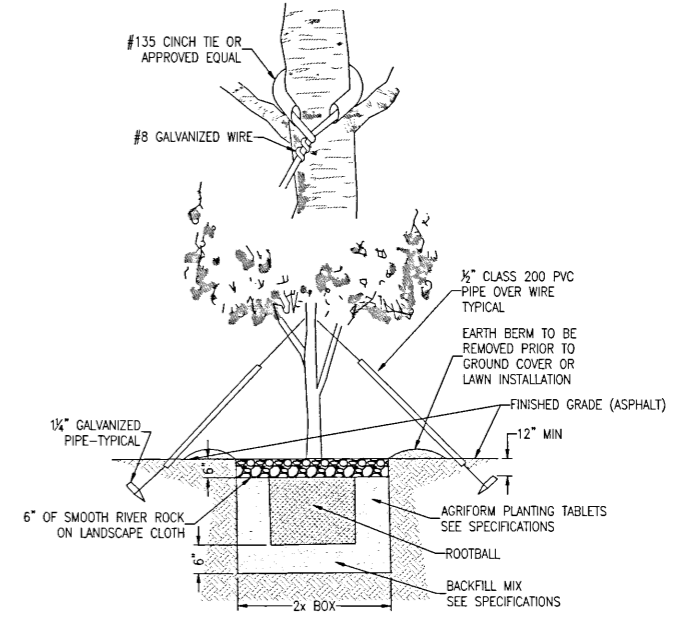

TREE PLANTING DETAIL
N.T.S.

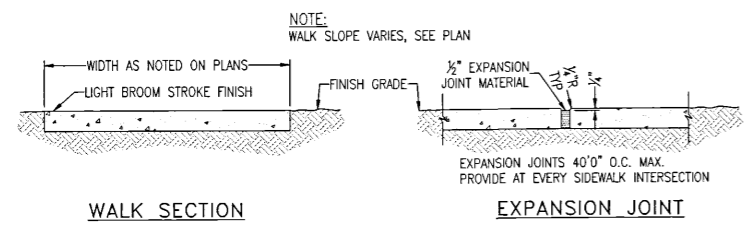

WALK SECTION

EXPANSION JOINT

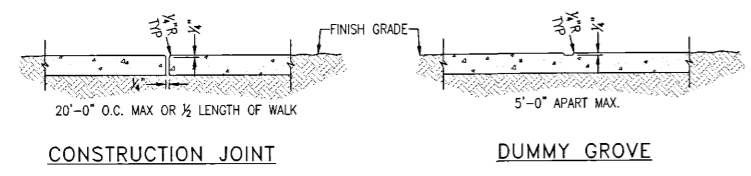

CONSTRUCTION JOINT

DUMMY GROVE

SIDEWALK DETAILS
N.T.S.

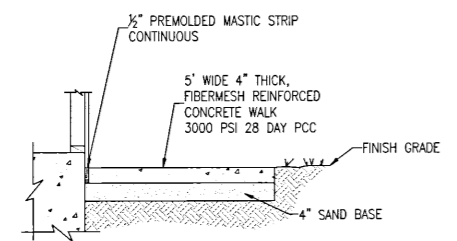

SIDEWALK DETAIL
N.T.S.

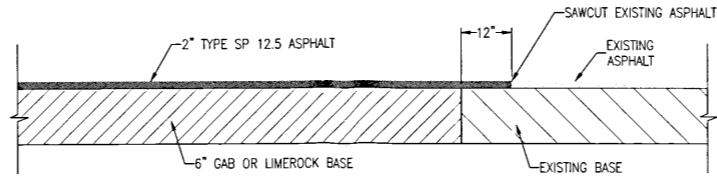

PAVEMENT SAWCUT DETAIL
N.T.S.

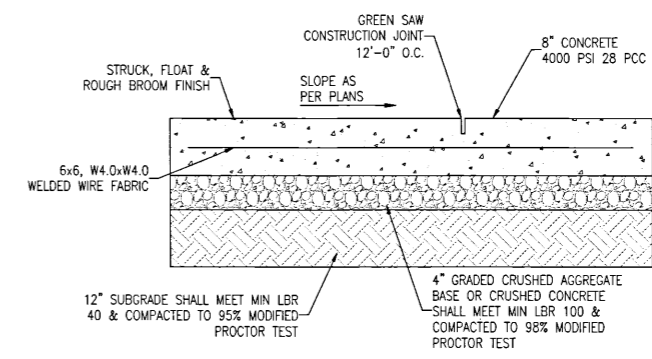

CONCRETE DOLLY PAD
N.T.S.



- NOTES:
- TOP PORTION OF FTP 25 SHALL HAVE A REFLECTIVE BLUE BACKGROUND WITH WHITE REFLECTIVE SYMBOL AND BORDER.
 - BOTTOM PORTION SHALL HAVE A REFLECTIVE WHITE BACKGROUND WITH BLACK OPAQUE LEGEND AND BORDER.
 - FTP 25 MAY BE FABRICATED ON ONE PANEL OR TWO.
 - SIGNS ARE TO BE MOUNTED AT STANDARD HEIGHT, (7' FROM PAVEMENT TO BOTTOM OF SIGN).
 - SIGN COLUMN TO BE AS PER F.D.O.T. STANDARDS, INDEX NO'S 11860 AND 11865.

SIGN USED AS PER FLORIDA STATUTES
FTP 25 Per FS 316.1955, FS 316.1956

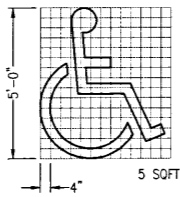

HANDICAP PAVEMENT SYMBOL

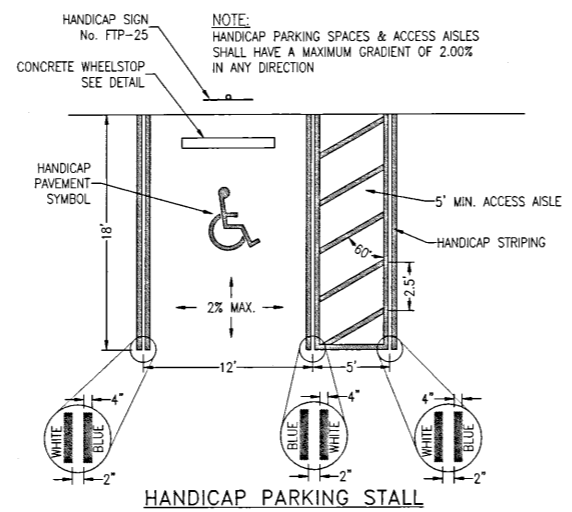

HANDICAP PARKING STALL

HANDICAP PARKING STALL DETAILS
N.T.S.

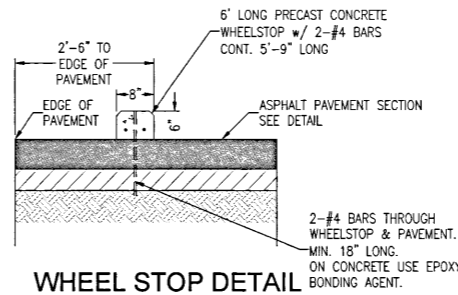

WHEEL STOP DETAIL
N.T.S.

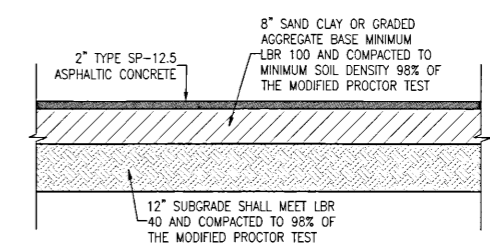

ON-SITE ASPHALT PAVEMENT DETAIL
N.T.S.

RBA
REBOL-BATTLE & ASSOCIATES
Civil Engineers and Surveyors
2301 N. Ninth Avenue, Suite 300
Pensacola, Florida 32503
Telephone: 904-438-4648
Fax: 904-438-4648
E-mail: RBA@RBA-ENG.COM

SITE DETAILS

CORT BUSINESS SERVICES
503 WEST BURGESS ROAD
ESCAMBIA, FLORIDA

NO.	DATE	REVISION	ESCO COMMENTS
1	10-04-2017		

SCALE: AS SHOWN
NOT FOR CONSTRUCTION
No. 53126
Paul A. Battle, P.E.
No. 43126
Professional Engineer
Date: 12-16-2016

DRAWING No.
C2.1
SHEET 6 OF 11

This drawing is the property of Rebol-Battle & Associates, and may not be reproduced without written permission.

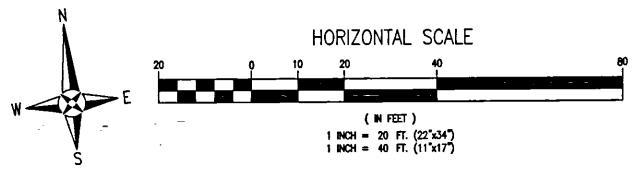

LEGEND	
	EXISTING ASPHALT
	EXISTING CONCRETE
	PROPOSED ASPHALT
	PROPOSED CONCRETE
	WATER LINE
	SEWER LINE (GRAVITY)
	FORCE MAIN
	EXISTING OVERHEAD UTILITY LINE
	EXISTING NATURAL GAS LINE
	PROPOSED WATER LINE
	PROPOSED SEWER (GRAVITY)
	BENCHMARK
	FIRE HYDRANT
	WATER METER
	WATER VALVE
	CLEANOUT
	SEWER MANHOLE
	STORMWATER MANHOLE
	GUY ANCHOR
	UTILITY POLE

- UTILITY NOTES:**
- IT IS THE CONTRACTOR'S RESPONSIBILITY TO DETERMINE THE EXACT LOCATION AND DEPTH OF EXISTING UTILITIES AND TO DETERMINE IF OTHER UTILITIES WILL BE ENCOUNTERED DURING THE COURSE OF THE WORK AND TAKE WHATEVER STEPS NECESSARY TO PROVIDE FOR THEIR PROTECTION.
 - THE CONTRACTOR SHALL COORDINATE WITH ECUA, GULF POWER, OR ANY OTHER UTILITY COMPANIES HAVING JURISDICTION FOR REMOVAL/RELOCATION AND/OR PROTECTION OF EXISTING UTILITY POLES, AERIAL LINES, FIRE HYDRANTS, AND OTHER UTILITIES AS NECESSARY TO COMPLETE CONSTRUCTION.
 - ALL NEW WATER LINES SHALL BE CLEANED, DISINFECTED, PRESSURE TESTED, AND BACTERIOLOGICALLY CLEANED FOR SERVICE IN ACCORDANCE WITH THE LATEST AWWA STANDARDS AND THE FLORIDA DEPARTMENT OF ENVIRONMENTAL PROTECTION RULES AND REGULATIONS.
 - ALL WATER MAINS SHALL BE NSF APPROVED FOR POTABLE WATER USE.
 - MAINTAIN 18 INCH MINIMUM VERTICAL SEPARATION BETWEEN ALL POTABLE WATER MAINS AND SANITARY SEWER GRAVITY LINES. (WATER ABOVE SEWER).
 - THE TOP OF ALL CLEANOUTS SHALL BE FLUSH WITH THE PAVEMENT OR, WHEN NOT IN THE PAVEMENT, FLUSH WITH THE FINISH GRADE. CONNECTION POINTS FOR UTILITIES SHALL BE CLEARLY MARKED FOR FUTURE BUILDING CONNECTION. COORDINATE WITH THE PLUMBING CONTRACTOR.
 - ALL WATER AND SEWER WORK SHALL BE IN ACCORDANCE WITH THE LATEST EDITION OF THE ECUA ENGINEERING MANUAL.
 - ADEQUATE PROVISIONS SHALL BE MADE FOR THE FLOW OF SEWERS, DRAINS AND WATER COURSES ENCOUNTERED DURING CONSTRUCTION.
 - THE CONTRACTOR SHALL NOTIFY THE APPROPRIATE UTILITY COMPANIES 72 HOURS (3 BUSINESS DAYS) PRIOR TO BEGINNING CONSTRUCTION.
 - ALL NEW WATER AND SEWER SERVICE LINES SHALL HAVE A MINIMUM COVER OF 30 INCHES (MAXIMUM 36"), UNLESS OTHERWISE NOTED.
 - THE CONTRACTOR IS TO RESTORE ALL DISTURBED RIGHTS-OF-WAY IN ACCORDANCE WITH ESCAMBIA COUNTY AND THE ECUA GUIDELINES.
 - THE CONTRACTOR SHALL COORDINATE WITH THE PLUMBING CONTRACTOR FOR BUILDING UTILITY CONNECTIONS.
 - ALL CONNECTIONS TO THE ECUA WATER AND SEWER SYSTEM SHALL BE MADE WITH ECUA PERSONNEL PRESENT.
 - ANY REMOVAL OR RELOCATION OF ECUA WATER/SEWER UTILITIES MUST BE APPROVED IN WRITING PRIOR TO THE WORK BEING DONE.

UTILITY DETAIL REFERENCE NOTE:
 REFER TO ECUA ENGINEERING MANUAL (09-01-2016) DIVISION 4 FOR ALL ECUA STANDARD DETAILS. FOR DETAILS NOT FOUND IN ECUA ENGINEERING MANUAL SEE DETAIL SHEET C4.1.

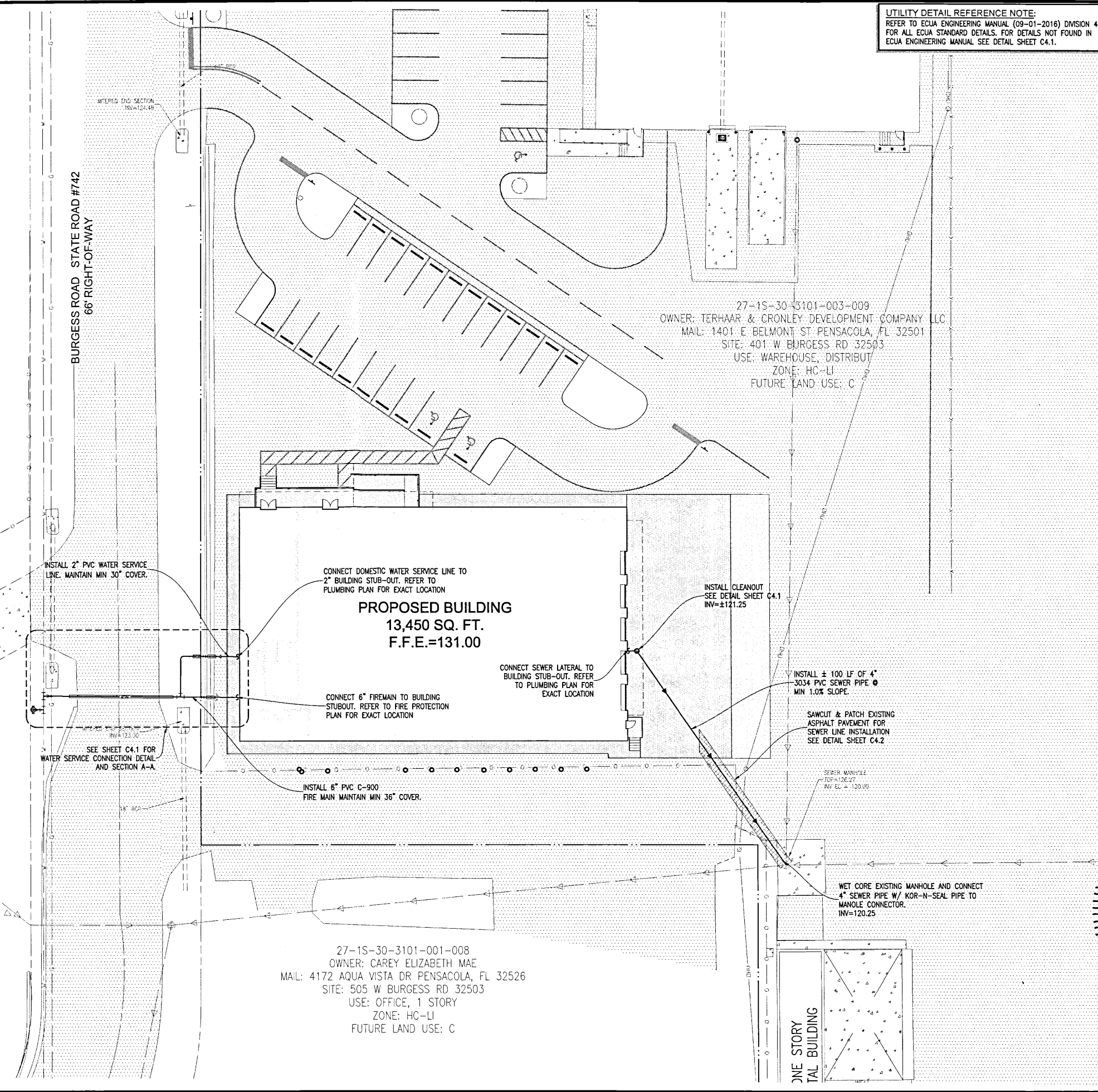

27-1S-30-3101-003-009
 OWNER: TERHAAR & CRONLEY DEVELOPMENT COMPANY, LC
 MAIL: 1401 E BELMONT ST PENSACOLA, FL 32501
 SITE: 401 W BURGESS RD 32503
 USE: WAREHOUSE, DISTRIBUTION
 ZONE: HC-LI
 FUTURE LAND USE: C

27-1S-30-3101-001-008
 OWNER: CAREY ELIZABETH MAE
 MAIL: 4172 AQUA VISTA DR PENSACOLA, FL 32526
 SITE: 505 W BURGESS RD 32503
 USE: OFFICE, 1 STORY
 ZONE: HC-LI
 FUTURE LAND USE: C

RBA
REBOL-BATTLE & ASSOCIATES
 Civil Engineers and Surveyors
 201 N. Ninth Avenue, Suite 300
 Pensacola, Florida 32503
 Telephone 850.438.0400 Fax 850.438.0448
 EB 00009657 LP7916

UTILITY PLAN

CORT BUSINESS SERVICES
 503 WEST BURGESS ROAD
 ESCAMBIA, FLORIDA

NO.	DATE	REVISION
1	06/04/2017	ESCO COMMENTS

STATE OF FLORIDA
 PROFESSIONAL ENGINEER
 No. 5312
 DATE: 12-19-17
 SEAL

Dr. By: GTP
 Ck By: MER
 Job No.: 2016.232
 Date: 12-16-2016

DRAWING No.
C4.0
 SHEET 8 OF 11

This drawing is the property of Rebol-Battle & Associates, and may not be reproduced without written permission.

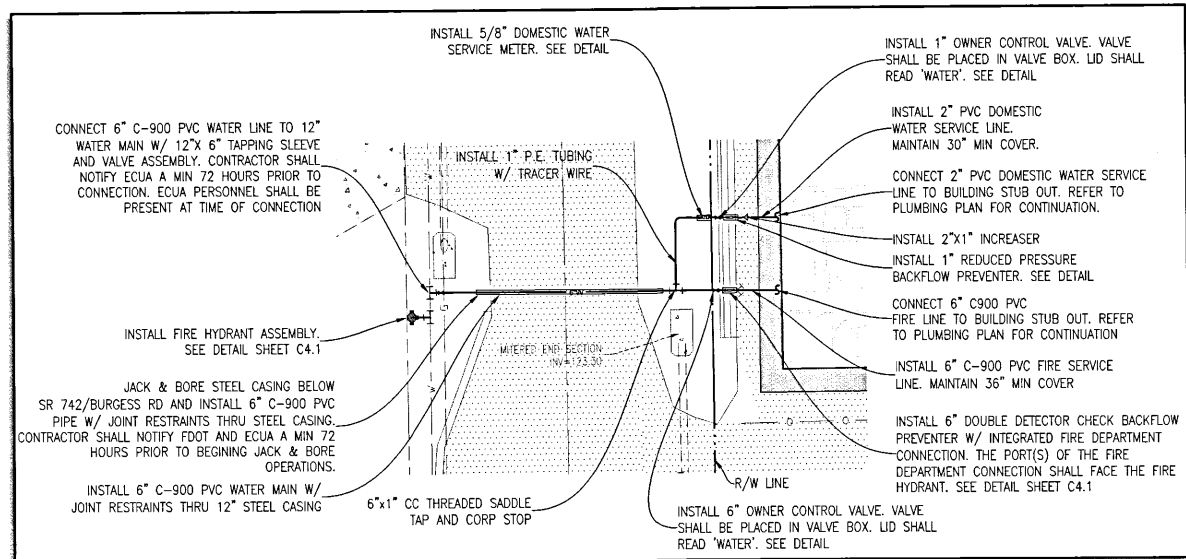

WATER CONNECTION DETAIL

N.T.S.

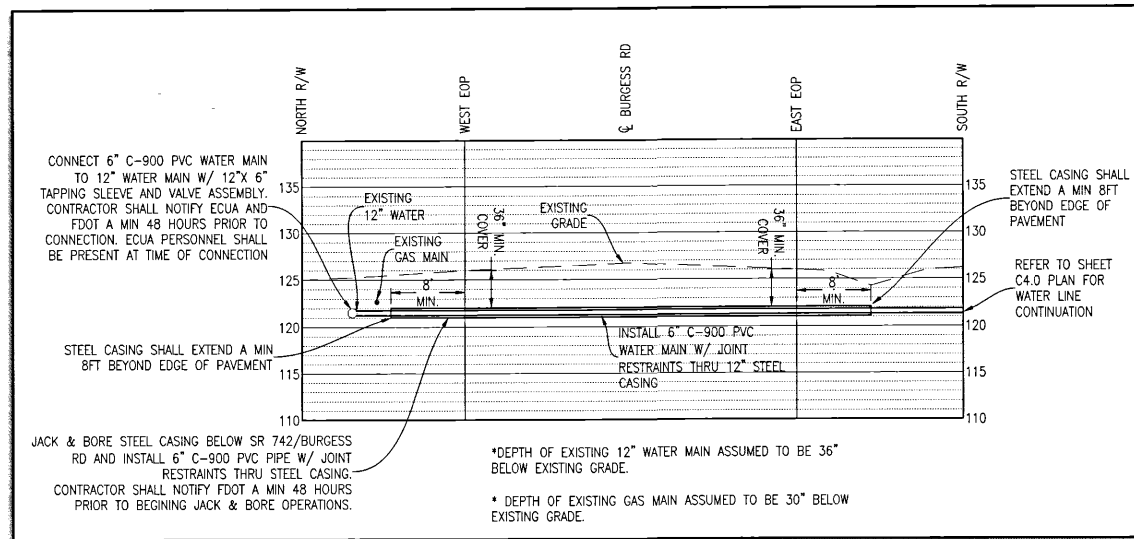

SECTION 'A-A'

N.T.S.

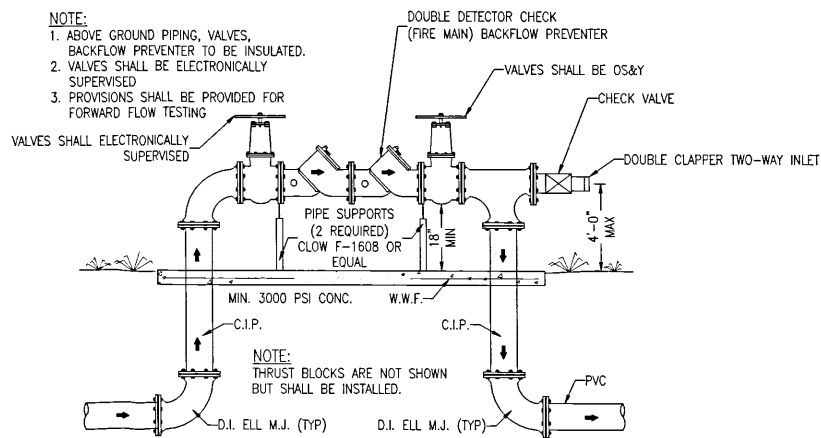

DOUBLE DETECTOR CHECK BACKFLOW PREVENTER W/ INTEGRATED FIRE DEPT CONNECTION DETAIL

N.T.S.

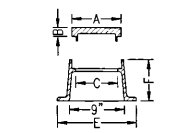
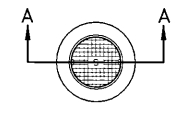
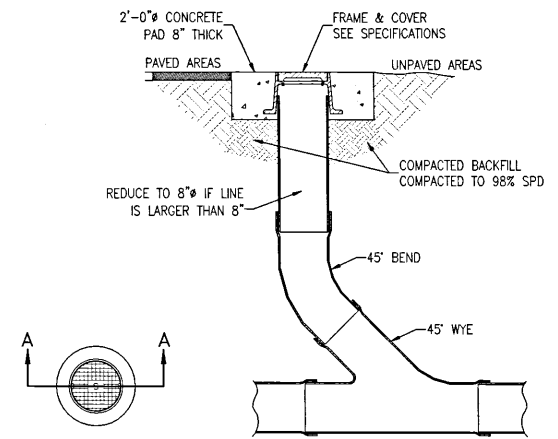

SOLID LID	A	B	C	E	F
R-1792-AL	10 3/4"	1 1/2"	8 1/2"	14 1/2"	4"
R-1792-BL	13 3/4"	1 1/2"	11 1/2"	17 1/2"	4"

SECTION A - A

SEWER CLEANOUT DETAIL (TRAFFIC RATED)

N.T.S.

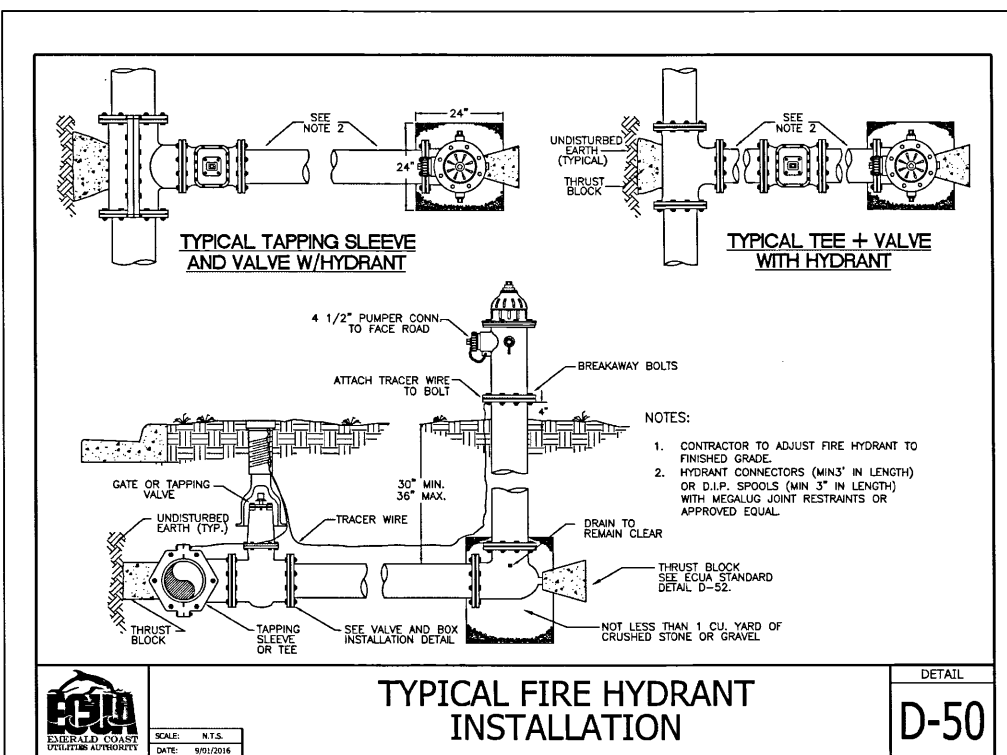

TYPICAL FIRE HYDRANT INSTALLATION

DETAIL
D-50



SCALE: N.T.S.
DATE: 9/15/2016

RBA
REBOL-BATTLE & ASSOCIATES
Civil Engineers and Surveyors
2301 N. Ninth Avenue, Suite 300
Escambia, Florida 32112
Phone: 850.439.0448
Fax: 850.439.0449
Telephone: ED 00006857 LB7816

UTILITY PLAN

CORT BUSINESS SERVICES
503 WEST BURGESS ROAD
ESCAMBIA, FLORIDA

REVISION	DATE	ESCO COMMENTS
1	01-04-2017	

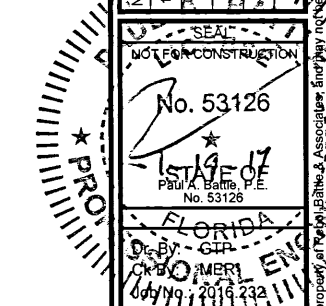

DRAWING No.
C4.1
SHEET 9 OF 11

This drawing is the property of Rebol-Battle & Associates, Inc. and may not be reproduced without written permission.

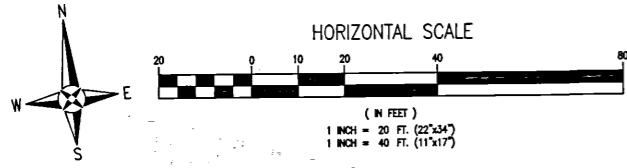

LEGEND	
	EXISTING ASPHALT
	EXISTING CONCRETE
	PROPOSED ASPHALT
	PROPOSED CONCRETE
	PROJECT LIMITS
	EXISTING FENCE
	DENOTES PROPOSED PARKING TERMINUS TREE (4 REQUIRED).

LANDSCAPE NOTES:

1. ALL TREES SHALL BE A MINIMUM HEIGHT OF 9' FROM FINISHED GRADE AT TIME OF PLANTING. A LIST OF RECOMMENDED TREES IS AVAILABLE AT NESA.
2. ALL DISTURBED AREAS SHALL BE STABILIZED WITH SEED & MULCH AND/OR SOD.

TREE PROTECTION NOTE:

1. NO PROTECTED TREES ARE LOCATED ON THE PROJECT SITE AND NO PROTECTED TREES WILL BE REMOVED, DESTRUCTIVELY DAMAGED, RELOCATED, DISFIGURED, DESTROYED, CUT DOWN, OR EXCESSIVELY PRUNED DURING CONSTRUCTION ACTIVITIES.

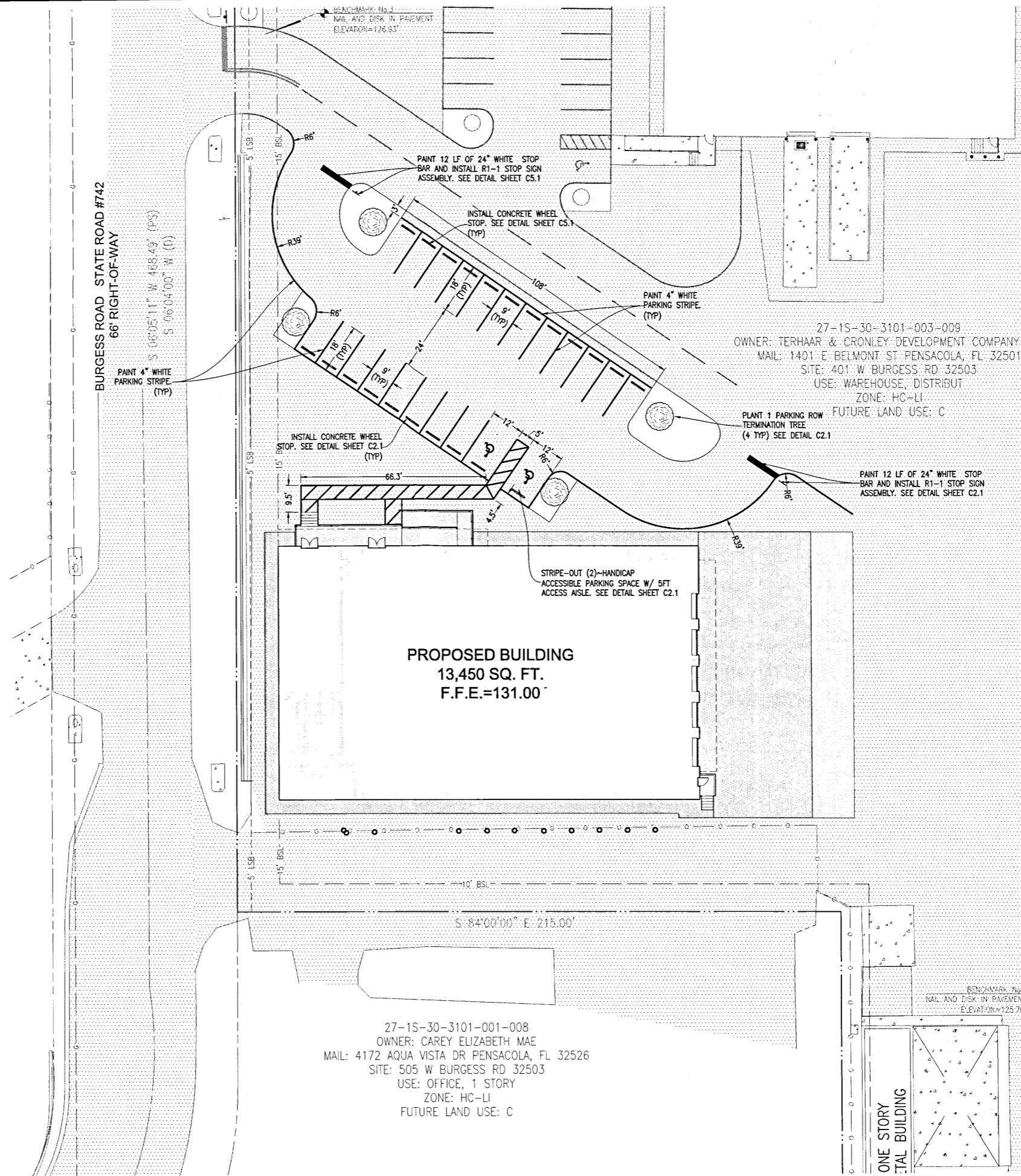

27-1S-30-3101-001-008
 OWNER: CAREY ELIZABETH MAE
 MAIL: 4172 AQUA VISTA DR PENSACOLA, FL 32526
 SITE: 505 W BURGESS RD 32503
 USE: OFFICE, 1 STORY
 ZONE: HC-LI
 FUTURE LAND USE: C

27-1S-30-3101-003-009
 OWNER: TERHAAR & CRONLEY DEVELOPMENT COMPANY, LC
 MAIL: 1401 E BELMONT ST PENSACOLA, FL 32501
 SITE: 401 W BURGESS RD 32503
 USE: WAREHOUSE, DISTRIB
 ZONE: HC-LI
 FUTURE LAND USE: C

ONE STORY
 TYPICAL BUILDING

RBA
REBOL-BATTLE & ASSOCIATES
 Civil Engineers and Surveyors
 2091 N. North Avenue, Suite 300
 Pensacola, Florida 32503
 Telephone 850.438.0400 Fax 850.438.0448
 EB 00009687 LB7916

LANDSCAPE, STRIPING AND SIGNAGE PLAN

CORT BUSINESS SERVICES
 503 WEST BURGESS ROAD
 ESCAMBIA, FLORIDA

DATE	REVISION
04-19-2017	ESCO COMMENTS

NOT FOR CONSTRUCTION
 No. 53126
 SEAL
 STATE OF FLORIDA
 Paul A. Battle, P.E.
 No. 53126

Dr. By: GTF
 Ck. By: WFR
 Job No.: 2016.232
 Date: 12-16-2016

DRAWING No.
C5.0
 SHEET 10 OF 11

This drawing is the property of Rebol-Battle & Associates, and may not be reproduced without written permission.

REVISION NO.	DATE	ESCO COMMENTS
01	04-2017	

SEAL
 NOT FOR CONSTRUCTION
 No. 53126
 1-19-17
 Paul C. Battle
 No. 53126
 REGISTERED PROFESSIONAL ENGINEER

FLORIDA
 OK BY: GTP
 DATE: 12/16/2017
 JOB No. 2016-022
 Date: 12/16/2017
 DRAWING No.
C6.0
 SHEET 11 OF 11

This drawing is the property of Rebol-Battle & Associates, and may not be reproduced without written permission.

Table I
Device Spacing
 Max. Distance Between Devices (ft.)

Speed (mph)	Type I or Type II	
	Cones or Tubular Markers	Barricades or Vertical Panels or Drums
25	25	25
30 to 45	25	30
50 to 70	25	50

Table II
Taper Length - Shoulder

Speed (mph)	%L (ft)				Notes
	#	10'	12'	Shldr.	
25	28	35	42		L=WS' 60
30	40	50	60		
35	55	68	82		L=WS 50
40	72	90	107		
45	120	150	180		L=WS 50
50	133	167	200		
55	147	183	220		L=WS 50
60	150	200	240		
65	173	217	260		L=WS 50
70	187	233	280		

GENERAL NOTES

- When four or more work vehicles enter the through traffic lanes in a one hour period or less (excluding establishing and terminating the work area), the advanced FLAGGER sign shall be substituted for the WORKERS sign. For location of flaggers and FLAGGER signs, see Index No. 603.
- SHOULDER WORK sign may be used as an alternate to the WORKER symbol sign only on the side where the shoulder work is being performed.
- When a side road intersects the highway within the TTC zone, additional TTC devices shall be placed in accordance with other applicable TCZ Indexes.
- For general TCZ requirements and additional information, refer to Index No. 600.

SYMBOLS

- Work Area
- Channelizing Device (See Index No. 600)
- Work Zone Sign
- Flagger
- Lane Identification + Direction of Traffic

CONDITIONS
 WHERE ANY VEHICLE, EQUIPMENT, WORKERS OR THEIR ACTIVITIES ENCRoACH THE AREA CLoSER THAN 12' BUT NOT CLoSER THAN 2' TO THE EDGE OF TRAVEL WAY.

LAST REVISION: 07/01/15
 DESCRIPTION: FY 2016-17 DESIGN STANDARDS
 INDEX NO.: 602
 SHEET NO.: 1 of 1

SYMBOLS:

- Work Area
- Channelizing Device (See Index No. 600)
- Work Zone Sign
- Flagger
- Lane Identification + Direction of Traffic

TEMPORARY RAISED RUMBLE STRIPS

OPTION - 1
 RUMBLE STRIP SET

OPTION - 2
 RUMBLE STRIP SET

GENERAL NOTES:

- Special Conditions may be required in accordance with these notes and the following sheets:
 - Railroad Crossings:
 - If an active railroad crossing is located closer to the Work Area than the Buffer Space plus 300 feet, extend the Buffer Space as shown on Sheet 3.
 - If the opening of vehicles across an active railroad crossing cannot be avoided, provide a uniformed traffic control officer or flagger at the highway-rail grade crossing to prevent vehicles from stopping within the highway-rail grade crossing, even if automatic train warning devices are in place.
 - If the Work Area encroaches on the Centerline, use the Layout for Temporary Lane Shift to Shoulder on Sheet 3 only if the Existing Paved Shoulder width is sufficient to provide for an 11' lane between the Work Area and the Edge of Existing Paved Shoulder. Reduce the posted speed when appropriate.
- Temporary Raised Rumble Strips:
 - Use when both of the following conditions are met concurrently:
 - Existing Posted Speed is 35 mph or greater;
 - Work duration is greater than 60 minutes.
 - Use a consistent Strip color throughout the work zone.
 - Place each Rumble Strip Set transversely across the lane at locations shown.
 - Use Option 1 or Option 2 as shown on Sheet 2. Use only one option throughout work zone.
- Additional one-way control may be provided by the following means:
 - Flag-carrying vehicle;
 - Official vehicle;
 - Pilot vehicles;
 - Traffic signals.

When flaggers are the sole means of one-way control, the flaggers must be in sight of each other or in direct communication at all times.

LAST REVISION: 02/04/16
 DESCRIPTION: FY 2016-17 DESIGN STANDARDS
 INDEX NO.: 603
 SHEET NO.: 2 of 3

SYMBOLS

- Work Area
- Lane Identification + Direction of Traffic

GENERAL NOTES

- If the work operation (excluding establishing and terminating the work area) requires that two or more work vehicles cross the offset zone in any one hour, traffic control will be in accordance with Index No. 602.
- No special signing is required.
- When a side road intersects the highway within the work area, additional TTC devices shall be placed in accordance with other applicable TCZ Indexes.
- When construction activities encroach on a sidewalk refer to Index No. 660.
- For general TCZ requirements and additional information, refer to Index No. 600.

CONDITIONS
 WHERE ANY VEHICLE, EQUIPMENT, WORKERS AND THEIR ACTIVITIES ARE BEHIND AN EXISTING BARRIER, MORE THAN 2' BEHIND THE CURB, OR 15' OR MORE FROM THE EDGE OF TRAVEL WAY.

LAST REVISION: 07/01/05
 DESCRIPTION: FY 2016-17 DESIGN STANDARDS
 INDEX NO.: 601
 SHEET NO.: 1 of 1

SYMBOLS:

- Work Area
- Channelizing Device (See Index No. 600)
- Work Zone Sign
- Flagger
- Lane Identification + Direction of Traffic

GENERAL NOTES:

- Special Conditions may be required in accordance with these notes and the following sheets:
 - Railroad Crossings:
 - If an active railroad crossing is located closer to the Work Area than the Buffer Space plus 300 feet, extend the Buffer Space as shown on Sheet 3.
 - If the opening of vehicles across an active railroad crossing cannot be avoided, provide a uniformed traffic control officer or flagger at the highway-rail grade crossing to prevent vehicles from stopping within the highway-rail grade crossing, even if automatic train warning devices are in place.
 - If the Work Area encroaches on the Centerline, use the Layout for Temporary Lane Shift to Shoulder on Sheet 3 only if the Existing Paved Shoulder width is sufficient to provide for an 11' lane between the Work Area and the Edge of Existing Paved Shoulder. Reduce the posted speed when appropriate.
- Temporary Raised Rumble Strips:
 - Use when both of the following conditions are met concurrently:
 - Existing Posted Speed is 35 mph or greater;
 - Work duration is greater than 60 minutes.
 - Use a consistent Strip color throughout the work zone.
 - Place each Rumble Strip Set transversely across the lane at locations shown.
 - Use Option 1 or Option 2 as shown on Sheet 2. Use only one option throughout work zone.
- Additional one-way control may be provided by the following means:
 - Flag-carrying vehicle;
 - Official vehicle;
 - Pilot vehicles;
 - Traffic signals.

When flaggers are the sole means of one-way control, the flaggers must be in sight of each other or in direct communication at all times.

TABLE 1
DEVICE SPACING

Posted Speed	Maximum Spacing of Cones or Tubular Markers				Maximum Spacing of Barricades/Panels/Drums				Distance Between Signs				Buffer Space
	On a Taper	On a Tangent	On a Taper	On a Tangent	A	B	C	D	A	B	C	D	
25	20'	50'	20'	50'	200'	200'	200'	100'	150'	200'	200'	100'	150'
30	20'	50'	20'	50'	200'	200'	200'	100'	200'	200'	200'	100'	200'
35	20'	50'	20'	50'	200'	200'	200'	100'	250'	200'	200'	100'	250'
40	20'	50'	20'	50'	200'	200'	200'	100'	300'	200'	200'	100'	300'
45	20'	50'	20'	50'	200'	200'	200'	100'	350'	200'	200'	100'	350'
50	20'	50'	20'	100'	500'	500'	500'	250'	425'	500'	500'	250'	425'
55	20'	50'	20'	100'	500'	500'	500'	250'	500'	500'	500'	250'	500'
60	20'	50'	20'	100'	2640'	1500'	1000'	500'	570'	2640'	1500'	1000'	570'
65	20'	50'	20'	100'	2640'	1500'	1000'	500'	645'	2640'	1500'	1000'	645'
70	20'	50'	20'	100'	2640'	1500'	1000'	500'	730'	2640'	1500'	1000'	730'

CONDITIONS
 WHERE ANY VEHICLE, EQUIPMENT, WORKERS OR THEIR ACTIVITIES ENCRoACH THE AREA BETWEEN THE CENTERLINE AND A LINE 2' OUTSIDE THE EDGE OF TRAVEL WAY.

LAST REVISION: 01/01/16
 DESCRIPTION: FY 2016-17 DESIGN STANDARDS
 INDEX NO.: 603
 SHEET NO.: 1 of 3