

Approved
ESCAMBIA COUNTY DRC PLAN REVIEW

DRC Chairman Signature

[Signature] 5/6/20
Date

Printed Name: Jennifer Hampton
Development Services Director or Designee

This document has been reviewed in accordance with the requirements of applicable Escambia County Regulations and Ordinances, and does not in any way relieve the submitting Architect, Engineer, Surveyor or other signatory from responsibility of details as drawn. A Development Order (DO) must be obtained through the Development Review Process prior to the commencement of construction. This DO approval does not constitute approval by any other agency. All additional state/federal permits shall be provided to the county prior to approval of a final plat or the issuance of state/federal permits shall be provided to the county prior to approval of a final plat or the issuance of a building permit.

SITE CONSTRUCTION PLANS

FOR

Ely Road Spec Warehouse

8765 ELY ROAD

ESCAMBIA COUNTY, FLORIDA

April 23, 2020

RBA PROJECT NO.: 2015.204

SITE INFORMATION	
OWNER:	CRONLEY INVESTMENT PROPERTIES, LLC 1401 EAST BELMONT STREET PENSACOLA, FLORIDA 32501 850.433.1001
DEVELOPER:	CRONLEY INVESTMENT PROPERTIES, LLC 1401 EAST BELMONT STREET PENSACOLA, FLORIDA 32501 850.433.1001
PROPERTY REFERENCE NO:	16-1S-30-1101-000-026
PROPERTY ADDRESS:	8765 ELY ROAD
PROPERTY AREA:	8.67 ACRES
PROJECT AREA:	3.83 ACRES
PROPERTY ZONING:	HC/LI
FUTURE LAND USE:	I
PROPOSED ACTIVITY:	WAREHOUSE
REQUIRED BUILDING SETBACKS HC/LI	FRONT YARD - 15 FT. SIDE YARD - 15 FT. REAR YARD - 15 FT.

FEMA FLOOD INSURANCE RATE MAP INFORMATION					
THE PARCEL SHOWN FOR DEVELOPMENT IS LOCATED WITHIN THE FOLLOWING FLOOD ZONE(S) AS DETAILED BY FEMA FIRM (FLOOD INSURANCE RATE MAP) INFORMATION DESCRIBED BELOW:					
FLOOD ZONE(S)	COMMUNITY No.	MAP No.	PANEL No.	SUFFIX	MAP REVISION DATE
X	120080	12033C	315	G	SEPT 29, 2006

CONTACTS	
GULF POWER 5120 DOGWOOD DRIVE MILTON, FLORIDA 32570	CONTACT: CHAD SWAILS PHONE: 850.429.2446 FAX: 850.429.2432
COX CABLE 3405 McLEMORE DR. PENSACOLA, FLORIDA 32514	CONTACT: TROY YOUNG PHONE: 850.857.4510 FAX: 850.475.0621
ECUA 9255 STURDEVANT ST. PENSACOLA, FLORIDA 32514	CONTACT: TOMMY TAYLOR PHONE: 850.969.6516
ENERGY SERVICES GAS 1625 ATWOOD DRIVE PENSACOLA, FLORIDA 32504	CONTACT: DWANE MOORE PHONE: 850.474.5319 FAX: 850.474.5331
AT&T, INC. 605 W. GARDEN STREET PENSACOLA, FLORIDA 32501	CONTACT: JONATHAN BLANKINSHIP PHONE: 850.436.1489
ESCAMBIA COUNTY PUBLIC WORKS 3383 WEST PARK PLACE PENSACOLA, FLORIDA 32501	CONTACT: MRS. JOHNNY PETTIGREW PHONE: 850.595.3404
MCI	PHONE: 800.624.9675
SUNSHINE UTILITIES	PHONE: 800.432.4770



VICINITY MAP
SCALE: 1"= 1000'



REBOL-BATTLE & ASSOCIATES

Civil Engineers and Surveyors

2301 N. Ninth Avenue, Suite 300
Pensacola, Florida 32503
Telephone 850.438.0400
Fax 850.438.0448
EB 00009657 LB 7916

ECUA ENGINEERING MANUAL REFERENCE NOTE*
*NOTES SHALL BE INSERTED IN THE UPPER RIGHT CORNER OF TITLE SHEET
*APPLICABLE ONLY TO ECUA INFRASTRUCTURE TO BE CONSTRUCTED IN PUBLIC ROW OR IN UTILITY EASEMENT; NOT TO BE APPLIED TO PRIVATE WATER/SEWER FACILITIES ON PRIVATE PROPERTY (SEE BUILDING CODE)

A. ECUA ENGINEERING MANUAL INCORPORATED BY REFERENCE

THE ECUA ENGINEERING MANUAL, DATED DECEMBER 18, 2014, ALONG WITH UPDATE # 1 DATED SEPTEMBER 1, 2016 (HEREINAFTER "MANUAL"), LOCATED AT WWW.ECUA.FL.GOV, IS HEREBY INCORPORATED BY REFERENCE INTO THIS PROJECT'S OFFICIAL CONTRACT DOCUMENTS AS IF FULLY SET FORTH THEREIN. IT IS THE CONTRACTOR'S RESPONSIBILITY TO BE KNOWLEDGEABLE OF THE MANUAL'S CONTENTS AND TO CONSTRUCT THE PROJECT IN ACCORDANCE WITH THE MANUAL. THE CONTRACTOR SHALL PROVIDE ITS EMPLOYEES ACCESS TO THE MANUAL AT ALL TIMES, VIA PROJECT SITE OR OFFICE, VIA DIGITAL OR PAPER FORMAT. IN THE EVENT OF A CONFLICT BETWEEN THE MANUAL AND PLANS, CONTRACTOR SHALL CONSULT ENGINEER OF RECORD FOR PROPER RESOLUTION.

B. ADDITIONAL DOCUMENTS (TO BE COMPLETED BY THE ENGINEER OF RECORD)

DOES THIS PROJECT HAVE ADDITIONAL TECHNICAL SPECIFICATIONS OR CONSTRUCTION DETAILS THAT SUPERSEDE THE MANUAL LISTED ABOVE?

YES NO

IF YES, CONTRACTOR SHALL CONSTRUCT PROJECT IN ACCORDANCE WITH SAID DOCUMENTS AS LISTED AND LOCATED BELOW:

DOCUMENT NAME	DOCUMENT TYPE		LOCATION	
	SPECIFICATION	DETAIL	PLANS	PROJECT MANUAL*

*PROJECT MANUALS USED ONLY WITH ECUA CIP PROJECTS

C. ENGINEER OF RECORD RESPONSIBILITIES

THE ENGINEERS OF RECORD (EORS) THAT HAVE AFFIXED THEIR SEALS AND SIGNATURES ON THESE PLANS WARRANT THEIR PORTIONS OF THE PLANS HAVE BEEN DESIGNED IN ACCORDANCE WITH THE MANUAL (UNLESS OTHERWISE DIRECTED BY THE ECUA PROJECT ENGINEER). THE EORS SHALL BE KNOWLEDGEABLE OF THE MANUAL'S CONTENTS AND SHALL ASSUME RESPONSIBILITY FOR ITS USE ON THIS PROJECT.

INDEX OF DRAWINGS

- C1.0 EXISTING SITE, DEMOLITION AND EROSION CONTROL PLAN
- C1.1 WELLHEAD PROTECTION PLAN
- C1.2 EROSION CONTROL DETAILS
- C1.3 STORMWATER POLLUTION PREVENTION PLAN
- C2.0 SITE LAYOUT AND DIMENSION PLAN
- C2.1 SITE DETAILS
- C3.0 GRADING AND DRAINAGE PLAN
- C3.1 GRADING AND DRAINAGE DETAILS
- C4.0 UTILITY PLAN
- C4.1 UTILITY DETAILS
- C5.0 LANDSCAPE PLAN

LEGAL DESCRIPTION

BEG AT SWLY COR OF ELLYSON FIELD N 0 DEG 23 MIN 10 SEC W ALG W LI 25 FT TO N R/W LI OF JOHNSON AVE N 0 DEG 23 MIN 10 SEC W 400 FT FOR POB CONT 234 75/100 FT N 89 DEG 6 MIN 27 SEC E 750 03/100 FT TO WLY R/W LI OF ELY RD S 0 DEG 23 MIN 10 SEC E ALG R/W 578 43/100 FT S 58 DEG 27 MIN 1 SEC W 67 82/100 FT S 0 DEG 37 MIN 21 SEC E 25 FT TO NLY R/W LI OF JOHNSON AVE S 89 DEG 22 MIN 39 SEC W ALG R/W 449 28/100 FT N 0 DEG 23 MIN 10 SEC W 400 FT S 89 DEG 22 MIN 39 SEC W 242 80/100 FT TO POB OR 8024 P 699

WELLHEAD PROTECTION NOTE:
THE SUBJECT PARCEL FALLS WITHIN THE TRAVEL TIME CONTOUR OF A PROTECTED (POTABLE) WELLHEAD. CONTRACTORS SHALL BE RESPONSIBLE FOR REPORTING SPILLS OF POTENTIALLY HAZARDOUS SUBSTANCES (I.E. GASOLINE, DIESEL FUEL, HYDRAULIC FLUID, CLEANING PRODUCTS, CHEMICALS, ETC.) TO THE APPROPRIATE STATE (FDEP STATE WARNING POINT (1-800-320-0519) AND LOCAL (ESCAMBIA COUNTY HEALTH DEPARTMENT/ENVIRONMENTAL HEALTH 595-6712) AGENCIES AND UTILITY (EMERALD COAST UTILITIES AUTHORITY, ECUA, 476-5110).*



REVISION	ESD/OOWNER COMMENTS

PAUL A. LICE
 No. 512 PERMITS DRAWINGS
 PROFESSIONAL ENGINEER
 No. 93126
 Date: 03-26-2020
 DRAWING No.
C1.0
 SHEET 2 OF 12

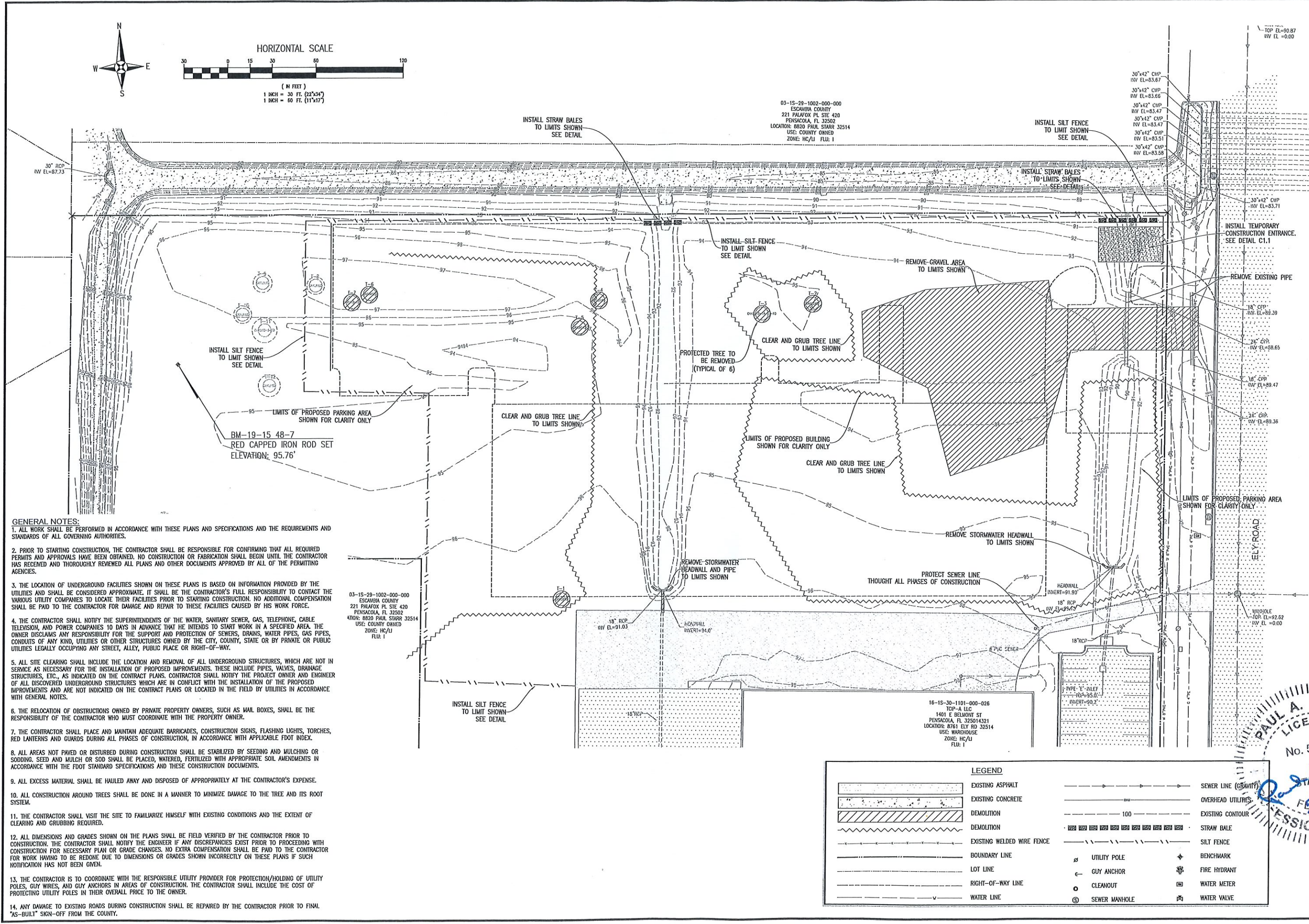

- GENERAL NOTES:**
1. ALL WORK SHALL BE PERFORMED IN ACCORDANCE WITH THESE PLANS AND SPECIFICATIONS AND THE REQUIREMENTS AND STANDARDS OF ALL GOVERNING AUTHORITIES.
 2. PRIOR TO STARTING CONSTRUCTION, THE CONTRACTOR SHALL BE RESPONSIBLE FOR CONFIRMING THAT ALL REQUIRED PERMITS AND APPROVALS HAVE BEEN OBTAINED. NO CONSTRUCTION OR FABRICATION SHALL BEGIN UNTIL THE CONTRACTOR HAS RECEIVED AND THOROUGHLY REVIEWED ALL PLANS AND OTHER DOCUMENTS APPROVED BY ALL OF THE PERMITTING AGENCIES.
 3. THE LOCATION OF UNDERGROUND FACILITIES SHOWN ON THESE PLANS IS BASED ON INFORMATION PROVIDED BY THE UTILITIES AND SHALL BE CONSIDERED APPROXIMATE. IT SHALL BE THE CONTRACTOR'S FULL RESPONSIBILITY TO CONTACT THE VARIOUS UTILITY COMPANIES TO LOCATE THEIR FACILITIES PRIOR TO STARTING CONSTRUCTION. NO ADDITIONAL COMPENSATION SHALL BE PAID TO THE CONTRACTOR FOR DAMAGE AND REPAIR TO THESE FACILITIES CAUSED BY HIS WORK FORCE.
 4. THE CONTRACTOR SHALL NOTIFY THE SUPERINTENDENTS OF THE WATER, SANITARY SEWER, GAS, TELEPHONE, CABLE TELEVISION, AND POWER COMPANIES 10 DAYS IN ADVANCE THAT HE INTENDS TO START WORK IN A SPECIFIED AREA. THE OWNER DISCLAIMS ANY RESPONSIBILITY FOR THE SUPPORT AND PROTECTION OF SEWERS, DRAINS, WATER PIPES, GAS PIPES, CONDUITS OF ANY KIND, UTILITIES OR OTHER STRUCTURES OWNED BY THE CITY, COUNTY, STATE OR BY PRIVATE OR PUBLIC UTILITIES LEGALLY OCCUPYING ANY STREET, ALLEY, PUBLIC PLACE OR RIGHT-OF-WAY.
 5. ALL SITE CLEARING SHALL INCLUDE THE LOCATION AND REMOVAL OF ALL UNDERGROUND STRUCTURES, WHICH ARE NOT IN SERVICE AS NECESSARY FOR THE INSTALLATION OF PROPOSED IMPROVEMENTS. THESE INCLUDE PIPES, VALVES, DRAINAGE STRUCTURES, ETC., AS INDICATED ON THE CONTRACT PLANS. CONTRACTOR SHALL NOTIFY THE PROJECT OWNER AND ENGINEER OF ALL DISCOVERED UNDERGROUND STRUCTURES WHICH ARE IN CONFLICT WITH THE INSTALLATION OF THE PROPOSED IMPROVEMENTS AND ARE NOT INDICATED ON THE CONTRACT PLANS OR LOCATED IN THE FIELD BY UTILITIES IN ACCORDANCE WITH GENERAL NOTES.
 6. THE RELOCATION OF OBSTRUCTIONS OWNED BY PRIVATE PROPERTY OWNERS, SUCH AS MAIL BOXES, SHALL BE THE RESPONSIBILITY OF THE CONTRACTOR WHO MUST COORDINATE WITH THE PROPERTY OWNER.
 7. THE CONTRACTOR SHALL PLACE AND MAINTAIN ADEQUATE BARRICADES, CONSTRUCTION SIGNS, FLASHING LIGHTS, TORCHES, RED LANTERNS AND GUARDS DURING ALL PHASES OF CONSTRUCTION, IN ACCORDANCE WITH APPLICABLE FDOT INDEX.
 8. ALL AREAS NOT PAVED OR DISTURBED DURING CONSTRUCTION SHALL BE STABILIZED BY SEEDING AND MULCHING OR SODDING. SEED AND MULCH OR SOD SHALL BE PLACED, WATERED, FERTILIZED WITH APPROPRIATE SOIL AMENDMENTS IN ACCORDANCE WITH THE FDOT STANDARD SPECIFICATIONS AND THESE CONSTRUCTION DOCUMENTS.
 9. ALL EXCESS MATERIAL SHALL BE HAULED AWAY AND DISPOSED OF APPROPRIATELY AT THE CONTRACTOR'S EXPENSE.
 10. ALL CONSTRUCTION AROUND TREES SHALL BE DONE IN A MANNER TO MINIMIZE DAMAGE TO THE TREE AND ITS ROOT SYSTEM.
 11. THE CONTRACTOR SHALL VISIT THE SITE TO FAMILIARIZE HIMSELF WITH EXISTING CONDITIONS AND THE EXTENT OF CLEARING AND GRUBBING REQUIRED.
 12. ALL DIMENSIONS AND GRADES SHOWN ON THE PLANS SHALL BE FIELD VERIFIED BY THE CONTRACTOR PRIOR TO CONSTRUCTION. THE CONTRACTOR SHALL NOTIFY THE ENGINEER IF ANY DISCREPANCIES EXIST PRIOR TO PROCEEDING WITH CONSTRUCTION FOR NECESSARY PLAN OR GRADE CHANGES. NO EXTRA COMPENSATION SHALL BE PAID TO THE CONTRACTOR FOR WORK HAVING TO BE REDONE DUE TO DIMENSIONS OR GRADES SHOWN INCORRECTLY ON THESE PLANS IF SUCH NOTIFICATION HAS NOT BEEN GIVEN.
 13. THE CONTRACTOR IS TO COORDINATE WITH THE RESPONSIBLE UTILITY PROVIDER FOR PROTECTION/HOLDING OF UTILITY POLES, GUY WIRES, AND GUY ANCHORS IN AREAS OF CONSTRUCTION. THE CONTRACTOR SHALL INCLUDE THE COST OF PROTECTING UTILITY POLES IN THEIR OVERALL PRICE TO THE OWNER.
 14. ANY DAMAGE TO EXISTING ROADS DURING CONSTRUCTION SHALL BE REPAIRED BY THE CONTRACTOR PRIOR TO FINAL "AS-BUILT" SIGN-OFF FROM THE COUNTY.

LEGEND

	EXISTING ASPHALT		SEWER LINE (GRAVITY)
	EXISTING CONCRETE		OVERHEAD UTILITIES
	DEMOLITION		EXISTING CONTOUR
	DEMOLITION		STRAW BALE
	EXISTING WELDED WIRE FENCE		SILT FENCE
	BOUNDARY LINE		UTILITY POLE
	LOT LINE		GUY ANCHOR
	RIGHT-OF-WAY LINE		CLEANOUT
	WATER LINE		SEWER MANHOLE
			BENCHMARK
			FIRE HYDRANT
			WATER METER
			WATER VALVE

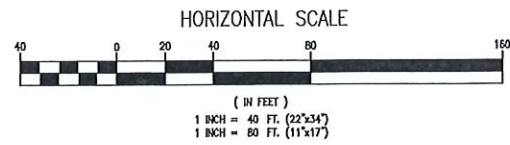
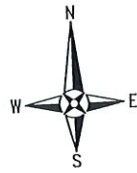

LEGEND	
	EXISTING ASPHALT
	EXISTING CONCRETE
	200' CLEAR WELL
	7 YEAR TRAVEL CONTOUR
	20 YEAR TRAVEL CONTOUR
	EXISTING WELDED WIRE FENCE
	BOUNDARY LINE
	LOT LINE
	RIGHT-OF-WAY LINE
	WATER LINE

WELLHEAD PROTECTION NOTE:
 THE SUBJECT PARCEL FALLS WITHIN THE TRAVEL TIME CONTOUR OF A PROTECTED (POTABLE) WELLHEAD. CONTRACTORS SHALL BE RESPONSIBLE FOR REPORTING SPILLS OF POTENTIALLY HAZARDOUS SUBSTANCES (I.E. GASOLINE, DIESEL FUEL, HYDRAULIC FLUID, CLEANING PRODUCTS, CHEMICALS, ETC.) TO THE APPROPRIATE STATE (FDEP STATE WARNING POINT (1-800-320-0519) AND LOCAL (ESCAMBA COUNTY HEALTH DEPARTMENT/ENVIRONMENTAL HEALTH 595-6712) AGENCIES AND UTILITY (EMERALD COAST UTILITIES AUTHORITY, ECUA, 476-5110)."

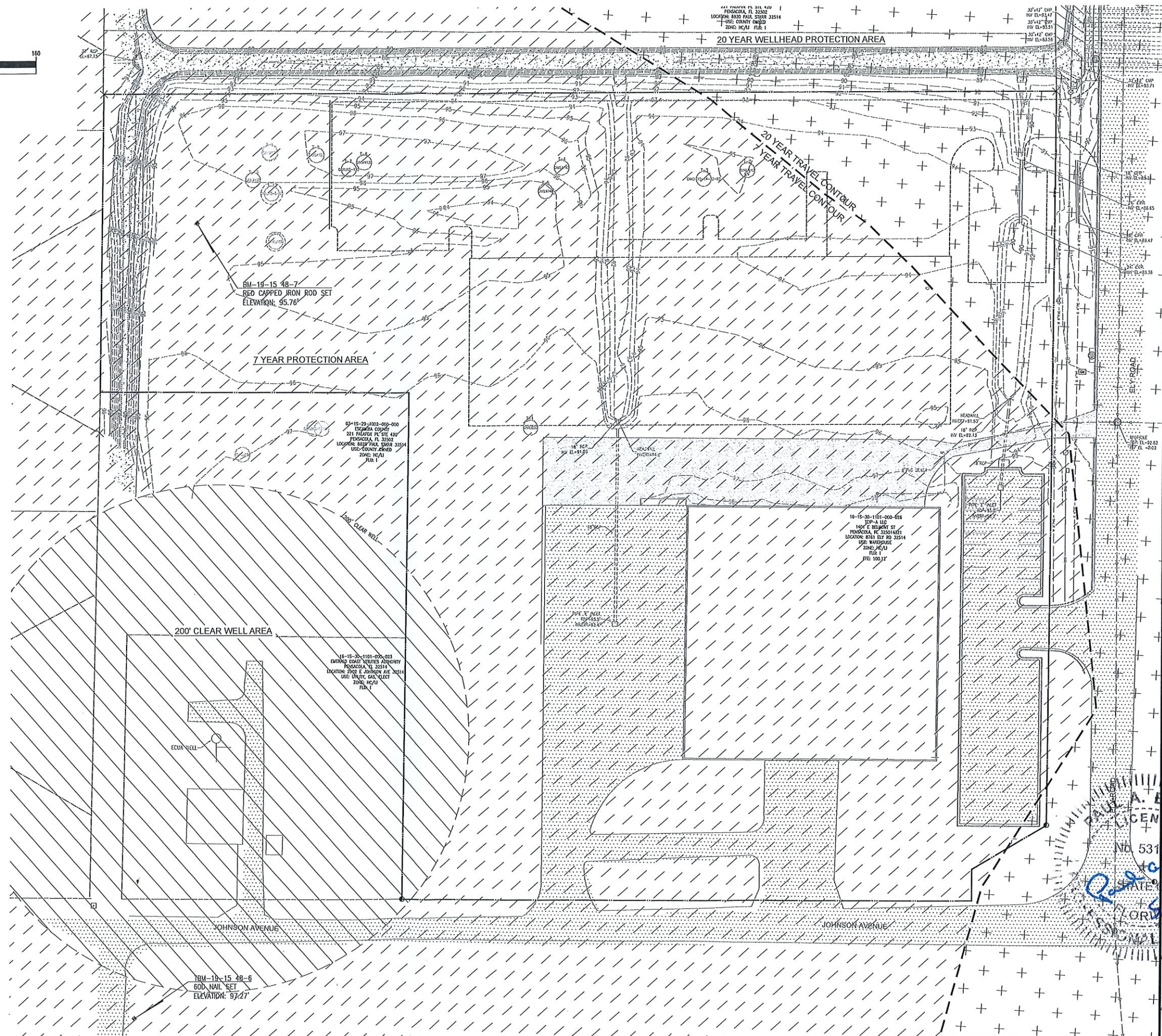

RBA
REBOL-BATTLE & ASSOCIATES
 Civil Engineers and Surveyors
 2301 N. Ninth Avenue, Suite 300
 Pensacola, Florida 32503
 Telephone 850-438-0400 Fax 850-438-0448
 E-mail 003@rba.net LP97916

WELLHEAD PROTECTION PLAN

Ely Road Spec Warehouse
 8765 Ely Road
 Escambia County, Florida

NO.	DATE	REVISION
1	03-23-2020	ESCO/OWNER COMMENTS

Paula A. Battle, P.E.
 No. 53126
 State of Florida
 Dr. By: GTP
 Ck. By: PAB
 Job No.: 2015.204
 Date: 03-26-2020

GENERAL NOTES FOR SOIL EROSION AND SEDIMENT CONTROL:

1. ALL EROSION AND SEDIMENT CONTROL PRACTICES TO BE INSTALLED PRIOR TO ANY MAJOR SOIL DISTURBANCE, OR IN THEIR PROPER SEQUENCE, AND MAINTAINED UNTIL PERMANENT PROTECTION IS ESTABLISHED.
2. ANY DISTURBED AREAS THAT WILL BE LEFT EXPOSED MORE THAN 30 DAYS, AND NOT SUBJECT TO CONSTRUCTION TRAFFIC, WILL IMMEDIATELY RECEIVE A TEMPORARY SEEDING. IF THE SEASON PREVENTS THE ESTABLISHMENT OF A TEMPORARY COVER, THE DISTURBED AREAS WILL BE MULCHED WITH STRAW, OR EQUIVALENT MATERIAL, AT A RATE OF TWO (2) TONS PER ACRE, ACCORDING TO STATE STANDARDS.
3. PERMANENT VEGETATION TO BE SEED OR SODDED ON ALL EXPOSED AREAS WITHIN TEN (10) DAYS AFTER GRADING. MULCH TO BE USED AS NECESSARY FOR PROTECTION UNTIL SEEDING IS ESTABLISHED.
4. ALL WORK AND MATERIALS TO BE IN ACCORDANCE WITH THE FDOT "STANDARD SPECIFICATIONS FOR ROAD AND BRIDGE CONSTRUCTION", LATEST EDITION, SECTIONS 104, 570, 575 AND 980 TO 986.
5. A BITUMINOUS CONCRETE BASE COURSE WILL BE APPLIED IMMEDIATELY FOLLOWING ROUGH GRADING AND INSTALLATION OF IMPROVEMENTS IN ORDER TO STABILIZE STREETS, ROADS, DRIVEWAYS AND PARKING AREAS. IN AREAS WHERE NO UTILITIES ARE PRESENT, THE BITUMINOUS CONCRETE BASE SHALL BE INSTALLED WITHIN 15 DAYS OF THE PRELIMINARY GRADING.
6. IMMEDIATELY FOLLOWING INITIAL DISTURBANCE OR ROUGH GRADING, ALL CRITICAL AREAS SUBJECT TO EROSION (I.E. STEEP SLOPES AND ROADWAY EMBANKMENTS) WILL RECEIVE A TEMPORARY SEEDING IN COMBINATION WITH STRAW MULCH OR A SUITABLE EQUIVALENT, AT A THICKNESS OF TWO (2) TO FOUR (4) INCHES MIXED WITH THE TOP TWO (2) INCHES OF SOIL, ACCORDING TO STATE STANDARDS.
7. ANY STEEP SLOPES RECEIVING PIPELINE INSTALLATION WILL BE BACKFILLED AND STABILIZED DAILY, AS THE INSTALLATION PROCEEDS (I.E. SLOPES GREATER THAN 3:1).
8. A CRUSHED LIMEROCK, VEHICLE WHEEL-CLEANING BLANKET SHALL BE INSTALLED AT THE CONTRACTOR'S STAGING YARD AND/OR STOCKPILE AREAS TO PREVENT OFF-SITE TRACKING OF SEDIMENT BY CONSTRUCTION VEHICLES ONTO PUBLIC ROADS. BLANKET SHALL BE 15FT. X 50FT. X 6IN. (MINIMUM), CRUSHED LIMEROCK 2 1/2 INCHES IN DIAMETER. SAID BLANKET SHALL BE UNDERLAIN WITH A FDOT CLASS 3 SYNTHETIC FILTER FABRIC AND MAINTAINED IN GOOD ORDER.
9. AT THE TIME WHEN THE SITE PREPARATION FOR PERMANENT VEGETATIVE STABILIZATION IS GOING TO BE ACCOMPLISHED, ANY SOIL THAT WILL NOT PROVIDE A SUITABLE ENVIRONMENT TO SUPPORT ADEQUATE VEGETATIVE GROUND COVER, SHALL BE REMOVED OR TREATED IN SUCH A WAY THAT WILL PERMANENTLY ADJUST THE SOIL CONDITIONS AND RENDER IT SUITABLE FOR VEGETATIVE GROUND COVER. IF THE REMOVAL OR TREATMENT OF THE SOIL WILL NOT PROVIDE SUITABLE CONDITIONS, NON-VEGETATIVE MEANS OF PERMANENT GROUND STABILIZATION WILL HAVE TO BE EMPLOYED.

10. CONDUIT OUTLET PROTECTION MUST BE INSTALLED AT ALL REQUIRED OUTFALLS PRIOR TO THE DRAINAGE SYSTEM BECOMING OPERATIONAL.
11. UNFILTERED DEWATERING IS NOT PERMITTED. THE CONTRACTOR SHALL TAKE ALL NECESSARY PRECAUTIONS DURING ALL DEWATERING OPERATIONS TO MINIMIZE SEDIMENT TRANSFER.
12. SHOULD THE CONTROL OF DUST AT THE SITE BE NECESSARY, THE SITE WILL BE SPRINKLED UNTIL THE SURFACE IS WET, TEMPORARY VEGETATION COVER SHALL BE ESTABLISHED OR MULCH SHALL BE APPLIED IN ACCORDANCE WITH STATE STANDARDS FOR EROSION CONTROL.
13. ALL SOIL WASHED, DROPPED, SPILLED OR TRACKED OUTSIDE THE LIMIT OF DISTURBANCE OR ONTO PUBLIC RIGHTS-OF-WAY WILL BE REMOVED IMMEDIATELY.
14. THE CONTRACTOR SHALL BE RESPONSIBLE FOR ANY EROSION OR SEDIMENTATION THAT MAY OCCUR BELOW STORMWATER OUTFALLS OR OFFSITE AS A RESULT OF CONSTRUCTION OF THE PROJECT.
15. ALL SOIL STOCKPILES ARE TO BE TEMPORARILY STABILIZED IN ACCORDANCE WITH SOIL EROSION AND SEDIMENT CONTROL NOTE NUMBER 2 (ABOVE).
16. THE SITE SHALL AT ALL TIMES BE GRADED AND MAINTAINED SUCH THAT ALL STORM WATER RUNOFF IS DIVERTED TO SOIL EROSION AND SEDIMENT CONTROL FACILITIES.
17. ALL SEDIMENTATION STRUCTURES SHALL BE INSPECTED AND MAINTAINED REGULARLY.
18. ALL CATCH BASIN INLETS SHALL BE PROTECTED WITH HAY BALES AS SHOWN ON DETAIL.
19. THE CONTRACTOR SHALL PREPARE A PLAN FOR THE PROPER DEWATERING AND DOWNSTREAM SILTATION PROTECTION OF EACH STREAM CROSSING PRIOR TO EXCAVATING THE STREAM BED. PLAN SHALL BE FORWARDED TO THE ENGINEER FOR APPROVAL. THE ENGINEER SHALL BE NOTIFIED FOR INSPECTION PRIOR TO EACH STREAM CROSSING CONSTRUCTION.
20. ANY AREAS USED FOR THE CONTRACTOR'S STAGING, INCLUDING BUT NOT LIMITED TO, TEMPORARY STORAGE OF STOCKPILED MATERIALS (E.G. CRUSHED STONE, QUARRY PROCESS STONE, SELECT FILL, EXCAVATED MATERIALS, ETC.), SHALL BE ENTIRELY PROTECTED BY A SILT FENCE ALONG THE LOW ELEVATION SIDE TO CONTROL SEDIMENT RUNOFF.

* WHERE APPLICABLE

TEMPORARY SEEDING DETAILS:

SEED BED PREPARATION:
SOIL TO BE THOROUGHLY PULVERIZED BY DISK-HARROWING AND BE LOOSE AND REASONABLY SMOOTH. APPLY FERTILIZER AT A RATE OF 260 LBS/ACRE OF 16-16-16 OR EQUIVALENT, APPLY DOLOMITIC LIMESTONE AT A RATE OF 800 TO 1000 LBS/ACRE TO PROVIDE A SOIL pH OF 5.5 TO 6.5, LIME & FERTILIZER TO BE WORKED INTO THE TOPSOIL TO A DEPTH OF 4". ADD SANDY LOAM TOPSOIL TO A MINIMUM OF TWO (2) INCHES WHERE REQUIRED.

SEED MIXTURE:
CONSISTING OF ANNUAL RYE (LOLIUM MULTIFLORUM) AT A RATE OF 174 LBS/ACRE.

PERMANENT SEEDING DETAILS:

SEED BED PREPARATION:
SOIL TO BE THOROUGHLY PULVERIZED BY DISK-HARROWING AND BE LOOSE AND REASONABLY SMOOTH. APPLY FERTILIZER AT A RATE OF 260 LBS/ACRE OF 16-16-16 OR EQUIVALENT, APPLY DOLOMITIC LIMESTONE AT A RATE OF 800 TO 1000 LBS/ACRE TO PROVIDE A SOIL pH OF 5.5 TO 6.5, LIME & FERTILIZER TO BE WORKED INTO THE TOPSOIL TO A DEPTH OF 4". ADD SANDY LOAM TOPSOIL TO A MINIMUM OF TWO (2) INCHES WHERE REQUIRED.

SEED MIXTURE CONSISTING OF	RATE	PURITY	GERMINATION
ARGENTINE BAHIA	260 LBS/AC.	95%	80%
PENSACOLA BAHIA	260 LBS/AC.	95%	40%(MIN.)-80%(TOTAL)

SODDING:
SOD SHALL BE WELL ROOT MATTED CENPEDE OR BAHIA GRASS COMMERCIALY CUT TO A MINIMUM DIMENSION OF 12" x 24" A MAXIMUM OF 72 HOURS PRIOR TO PLACEMENT. SOD SHALL BE LIVE, FRESH AND UNINJURED, REASONABLY FREE OF WEEDS AND OTHER GRASSES, WITH A HEAVY SOIL MAT ADHERING TO THE ROOT SYSTEM. SOD SHALL BE GROWN, CUT, AND SUPPLIED BY A STATE CERTIFIED GROWER.

TRAFFIC CONTROL STANDARDS:
1. CONSTRUCTION TRAFFIC SHALL BE RESTRICTED TO ONSITE ACCESS BY MEANS SO DESIGNATED BY THE ENGINEER, POLICE/SHERIFF DEPARTMENT, ESCAMBIA COUNTY HIGHWAY DEPARTMENT, AND/OR THE FLORIDA DEPARTMENT OF TRANSPORTATION.
2. TRAFFIC DURING WET WEATHER SHALL BE MINIMIZED AND APPROPRIATE ROADWAY AND SITE CLEAN-UP SHALL BE PROVIDED BY THE CONTRACTOR AS SOON AS WEATHER CONDITIONS PERMIT.

TREE PROTECTION:
1. DAMAGED TRUNKS OR EXPOSED ROOTS WILL BE PAINTED IMMEDIATELY WITH A GOOD GRADE OF "TREE PAINT".
2. TREE LIMB REMOVAL, WHERE NECESSARY, WILL BE DONE FLUSH TO TRUNK OR MAIN BRANCH AND THAT AREA PAINTED IMMEDIATELY WITH A GOOD GRADE OF TREE PAINT.

DUST CONTROL:

1. ALL AREAS OF CLEARING AND EMBANKMENT AS WELL AS CONSTRUCTION HAUL ROADS SHALL BE TREATED AND MAINTAINED IN SUCH A MANNER AS TO MINIMIZE ANY DUST GENERATION.
2. DISTURBED AREAS SHALL BE MAINTAINED IN A ROUGH GRADED CONDITION AND TEMPORARILY SEEDED AND/OR MULCHED UNTIL PROPER WEATHER CONDITIONS EXIST FOR THE ESTABLISHMENT OF PERMANENT VEGETATION COVER.
3. IN EVENT OF EMERGENCY CONDITIONS, TILLAGE WILL BE SATISFACTORY FREE BEFORE SOIL BLOWING STARTS.
4. CALCIUM CHLORIDE MAY BE APPLIED TO UNPAVED ROADWAY AREAS, ONLY, SUBJECT TO THE ENGINEER'S APPROVAL AND CONFORMANCE WITH FDOT STANDARD SPECIFICATIONS, SECTION 102-5, LATEST EDITION.

PROPOSED SEQUENCE OF CONSTRUCTION:

1. THE INSTALLATION OF ALL SEDIMENT AND EROSION CONTROL DEVICES THAT CAN BE PLACED PRIOR TO ANY MAJOR SOIL DISTURBANCES.
2. CLEAR AND REMOVE ALL EXISTING VEGETATION IN THOSE AREAS WHERE NECESSARY. ALL REMAINING VEGETATION IS TO BE PROPERLY PROTECTED AND IS TO REMAIN IN ITS NATURAL STATE. TOPSOIL IN AREAS TO BE DISTURBED IS TO BE STRIPPED TO A MINIMUM DEPTH OF SIX (6) INCHES AND STOCKPILED SEPARATELY FROM OTHER EXCAVATED SOIL(S).
3. THE IMMEDIATE INSTALLATION OF ALL REMAINING SEDIMENT AND EROSION CONTROL DEVICES.
4. PERFORM ALL DEMOLITION WORK.
5. CONSTRUCT ALL UNDERGROUND UTILITIES AND STORM DRAIN SYSTEMS.
6. CONSTRUCT ROADS (SUBGRADE, CURB & GUTTER, BASE, PAVEMENT, SIDEWALKS AND LANDSCAPING).
7. COMPLETE STORMWATER PONDS.
8. UPON THE COMPLETION OF THE CONSTRUCTION ACTIVITIES, PROVIDE RESTORATION, FINE GRADE REMAINDER OF SITE, RESPREAD STOCKPILED TOPSOIL AND STABILIZE WITH PERMANENT VEGETATIVE COVER AND LANDSCAPING.
9. THE REMOVAL OF APPROPRIATE TEMPORARY SEDIMENT AND EROSION CONTROL DEVICES.

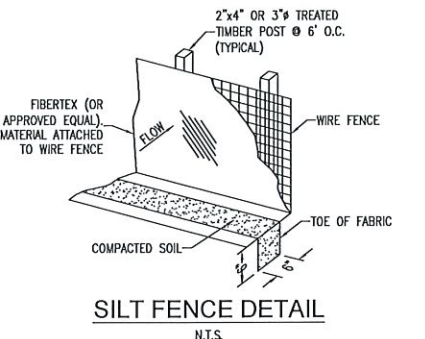
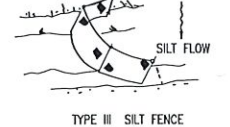
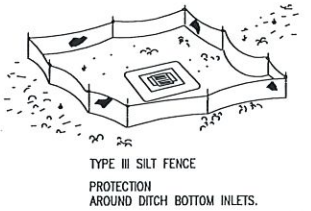
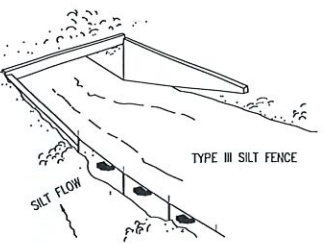

SILT FENCE APPLICATIONS

DO NOT DEPLOY IN A MANNER THAT SILT FENCES WILL ACT AS A DAM ACROSS PERMANENT FLOWING WATERCOURSES. SILT FENCES ARE TO BE USED AT UPLAND LOCATIONS AND TURBIDITY BARRIERS USED AT PERMANENT BODIES OF WATER.

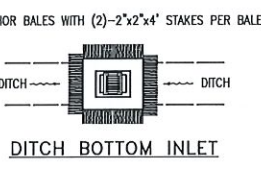
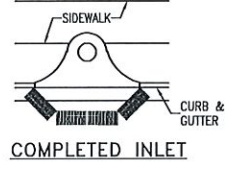
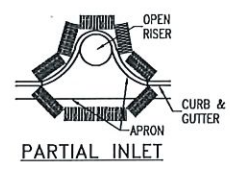
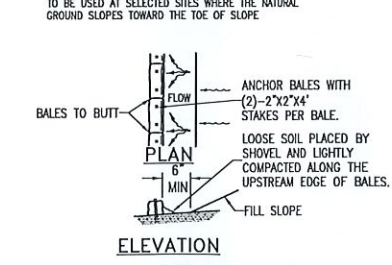
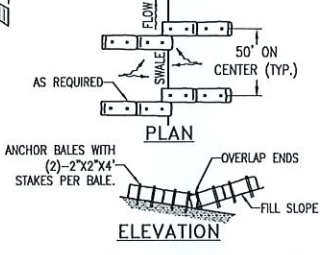
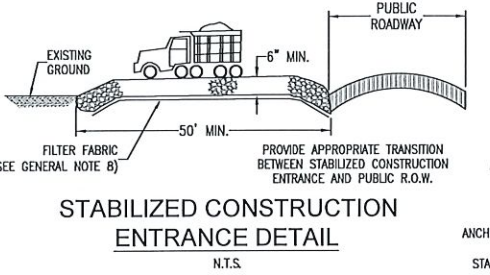
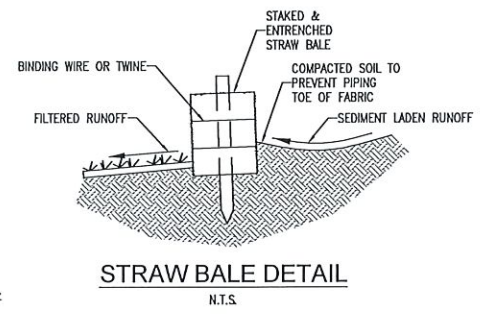
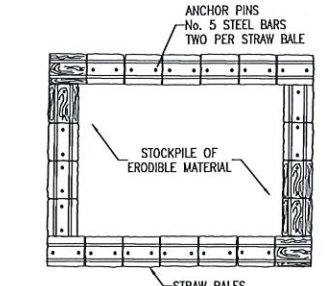
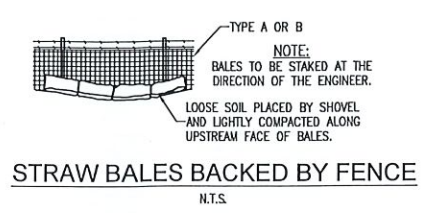

PROTECTION AROUND INLETS OR SIMILAR STRUCTURES



NOTE:
ALL PROTECTED TREES AS SHOWN ON THE PLANS TO REMAIN ARE TO BE PROTECTED DURING CONSTRUCTION. THE CONTRACTOR SHALL INSTALL ORANGE CONSTRUCTION FENCING AT THE DRIP LINE OF EACH PROTECTED TREE BEFORE WORKING IN THE VICINITY OF THE TREE.

BARRIERS FOR FILL SLOPES

N.T.S.

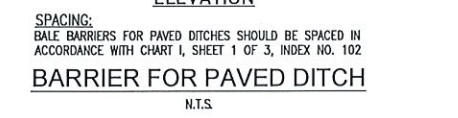

BARRIER FOR PAVED DITCH

N.T.S.

REPLACEMENT RATIO: (DSM 2-5.2 (a))
TOTAL PROTECTED TREE TRUNK DIAMETER (DBH) REMOVED = 110 INCHES
110 x 0.50 = 55 INCHES. TOTAL CALIPER REPLACEMENT = 55 INCHES

REPLACEMENT LIMITS: (DSM 2-5.2 (a))
TOTAL TREE REPLACEMENT FOR NON-HERITAGE TREES NEED NOT EXCEED 25 CALIPER INCHES PER DEVELOPMENT SITE ACRE.
TOTAL DEVELOPMENT SITE = 3.83 ACRE X 25 = 95.75
REPLACEMENT LIMITS = 96 INCHES

REQUIRED TOTAL CALIPER REPLACEMENT = 55 INCHES

TOTAL 2.5 INCH TREES REQUIRED = 22, OR TOTAL 3 INCH TREES REQUIRED = 19. DEVELOPER MAY CHOOSE COMBINATION OF 2.5 AND 3 INCH TREES BUT THE TOTAL CALIPER INCHES TO BE REPLACED MUST BE 55 INCHES. CALIPER INCHES ARE TO BE REPLACED/PLANTED USING A MINIMUM 2.5 CALIPER INCH NATIVE, CANOPY, FL GRADE 1 OR BETTER REPLACEMENT/MITIGATION TREE. THE DEVELOPER MAY ALSO CHOOSE TO PAY INTO THE ESCAMBIA COUNTY TREE FUND.

TREE PROTECTION NOTES:
1. NO UN-PERMITTED GRADING OR CLEARING BY HEAVY EQUIPMENT SHOULD HAPPEN UNDER THE DRIPLINE OF PROTECTED TREES ON SITE.

2. STORAGE OF HEAVY EQUIPMENT SHALL NOT OCCUR UNDER THE DRIPLINE OF PROTECTED TREES ON SITE.

3. NO PROTECTED TREES INDICATED FOR PRESERVATION SHALL BE REMOVED, DESTRUCTIVELY DAMAGED, MUTILATED, RELOCATED, DISFIGURED, DESTROYED, CUT DOWN OR EXCESSIVELY PRUNED.

4. FOR VIABILITY OF PROTECTED TREES REMAINING ON SITE, THE ROOTS OF 1" DIAMETER OR GREATER SHALL BE CUT CLEANLY WITH APPROPRIATE EQUIPMENT. DO NOT USE EQUIPMENT THAT PULLS AND SHATTERS ROOTS (E.G. BACKHOE). ROOTS SHALL BE PRUNED TO A DEPTH OF 18" BELOW THE EXISTING GRADE OR TO A DEPTH OF DISTURBANCE IF LESS THAN 18" FROM EXISTING GRADE.

5. ALL ADEQUATE TREE PROTECTION MEASURES AND BARRICADES SHALL BE INSTALLED PRIOR TO SITE DISTURBANCE AND MAINTAINED IN GOOD WORKING ORDER UNTIL PROJECT IS COMPLETE AND STATE OF PROTECTION IS STABILIZED.

6. ALL TREES SHALL BE AT LEAST 2.5" DIAMETER MEASURED AT DBH AT THE TIME OF PLANTING.

7. ALL DISTURBED AREAS SHALL BE STABILIZED WITH SEED & MULCH AND/OR SODDING.

8. ALL DISTURBED AREAS WITHIN THE RIGHT OF WAY TO BE SODDED WITH BERMUDA GRASS.

9. ANY LAND DISTURBING ACTIVITIES, INCLUDING THE PLACEMENT OF FILL/FILL MATERIALS, GRADING, EXCAVATING, ETC. SHALL NOT OCCUR UNTIL SUCH TIME AS APPROPRIATE PERMIT(S) ARE ISSUED FOR THE PROPOSED WORK.

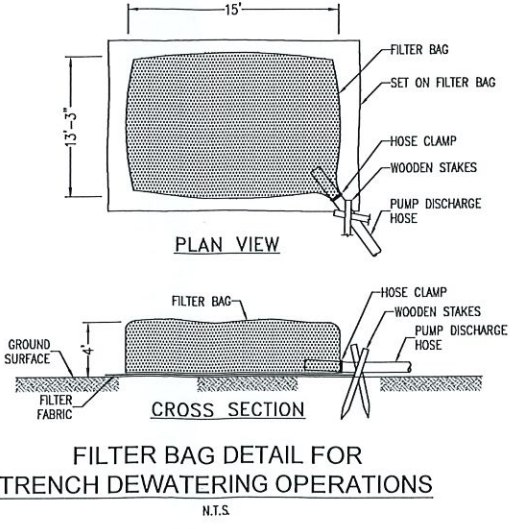

DESCRIPTION:
FILTER BAGS WILL BE USED AS AN EFFECTIVE FILTER MEDIUM TO CONTAIN SAND, SILT AND FINES WHEN TRENCH DEWATERING. THE WETLAND FILTER BAG CONTAINS THESE MATERIALS WHILE ALLOWING THE WATER TO FLOW THROUGH THE FABRIC.

INSTALLATION:
WETLAND FILTER BAGS MAY REPLACE HAY BALE CORRALS DURING TRENCH DEWATERING, AT THE DISCRETION OF THE ENGINEER/INSPECTOR. TO INSURE PROPER INSTALLATION, FILTER BAGS WILL BE PLACED ON RELATIVELY FLAT TERRAIN FREE OF BRUSH AND STUMPS TO AVOID RUPTURES AND PUNCTURES. PROPER INSTALLATION REQUIRES CUTTING A SMALL HOLE IN THE CORNER OF THE BAG, INSERTING THE PUMP DISCHARGE HOSE, AND THEN SECURING THE DISCHARGE HOSE TO THE BAG WITH A HOSE CLAMP. FILTER BAGS WILL BE PLACED AS FAR AWAY FROM FLOWING STREAMS AND WETLANDS AS POSSIBLE.

MAINTENANCE:
PRIOR TO REMOVING A BAG FROM THE HOSE, THE BAG WILL BE TIED OFF BELOW THE END OF THE HOSE ALLOWING THE BAG TO DRAIN. DRAINAGE WILL NOT BE ALLOWED THROUGH THE INLET HOLE. TO AVOID RUPTURE, THE BAGS WILL BE ATTENDED AND PUMPING RATES MONITORED. ONCE THE BAG IS INFLATED TO A HEIGHT OF 4 FEET, PUMPING WILL STOP TO AVOID RUPTURE. FILTER BAGS USED DURING CONSTRUCTION WILL BE BUNDLED AND REMOVED FOR PROPER DISPOSAL.

SPECIFICATION:
FILTER BAGS ARE CONSTRUCTED OF NON-WOVEN GEOTEXTILE FABRIC. A MAXIMUM OF ONE SIX INCH DISCHARGE HOSE WILL BE ALLOWED PER FILTER BAG. BAG CAPACITY WILL BE EXCEEDED BEYOND 2,000 GALLONS PER MINUTE. TYPICAL BAG DIMENSIONS ARE 15 FEET BY 13.25 FEET. TO HELP PREVENT PUNCTURES, GEOTEXTILE FABRIC WILL BE PLACED BENEATH THE FILTER BAG WHEN USED IN WOODED LOCATIONS. UNATTENDED FILTER BAGS WILL BE ENCIRCLED WITH A HAY BALE OR SILT FENCE CORRAL. HOSE CLAMPS WILL BE USED TO SECURE THE DISCHARGE HOSE, WIRE OR STRING WILL NOT BE USED.

TREE CHART OF PROTECTED TREES

TREE #	SIZE & TYPE	REMOVE/PROTECT
T-1	25' LIVE OAK	REMOVE
T-2	14' LAUREL OAK	REMOVE
T-3	18' LAUREL OAK	REMOVE
T-4	14' LAUREL OAK	REMOVE
T-5	14' LAUREL OAK	REMOVE
T-6	13' LAUREL OAK	REMOVE
T-7	12' LIVE OAK	REMOVE
T-8	12' LIVE OAK	PROTECT
T-9	15' LIVE OAK	PROTECT
T-10	12' LIVE OAK	PROTECT
T-11	15' LIVE OAK	PROTECT
T-12	15' LIVE OAK	PROTECT

TREE PROTECTION NOTE:
ALL TREE BARRICADES SHALL BE INSTALLED PRIOR TO ANY LAND DISTURBING ACTIVITIES (STORMWATER POND, GRADING, ETC.) AND MAINTAINED IN GOOD WORKING ORDER UNTIL THE PROJECT IS COMPLETE AND THE SITE BECOMES STABILIZED.

REVISION	DATE	ES/OWNER COMMENTS
	04-23-2020	

SEAL
PERMIT/DRAWINGS
No. 53
20
P. E.
No. 68328
Date: 03-26-2020
DRAWING No.
C1.2
SHEET 4 OF 12

STORM WATER POLLUTION PREVENTION PLAN

1.0 BACKGROUND & REQUIREMENTS:

1.1 INTRODUCTION:

THE REFERENCED SUPPORT DOCUMENTATION FOR THIS STORM WATER POLLUTION PREVENTION PLAN (SWPPP) IS THE UNITED STATES ENVIRONMENTAL PROTECTION AGENCY'S (EPA) STORM WATER MANAGEMENT FOR CONSTRUCTION ACTIVITIES, DEVELOPING POLLUTION PREVENTION PLANS AND BEST MANAGEMENT PRACTICES SUMMARY GUIDANCE (EPA 833-R-92-001) AND STORM WATER MANAGEMENT FOR CONSTRUCTION ACTIVITIES, DEVELOPING POLLUTION PREVENTION PLANS AND BEST MANAGEMENT PRACTICES (EPA 832-R-92-005). THIS SWPPP IS DESIGNED TO PROTECT ONSITE AND ADJACENT NATURAL RESOURCES, INCLUDING BUT NOT LIMITED TO, WETLANDS, MARSHES, BAYOUS AND BAYS, WHILE PRESERVING WILDLIFE AND ARCHEOLOGICAL RESOURCES.

AN ENVIRONMENTAL RESOURCE PERMIT APPLICATION HAS BEEN SUBMITTED TO THE NWFVMD N/A

1.2 NOTICE OF INTENT (NOI):

RULE 62-621.300(4), FAC REQUIRES THE CONSTRUCTION OPERATOR OF A SITE THAT DISTURBS ONE OR MORE ACRES TO OBTAIN COVERAGE FROM THE GENERIC PERMIT FOR STORMWATER DISCHARGE FROM LARGE AND SMALL CONSTRUCTION ACTIVITIES. THE CONTRACTOR IS REQUIRED TO SUBMIT A NOTICE OF INTENT TO USE GENERIC PERMIT FOR STORMWATER DISCHARGE FROM LARGE AND SMALL CONSTRUCTION ACTIVITIES (FDEP FORM 62-621.300(4)(B)) ALONG WITH THE APPROPRIATE APPLICATION FEE TO THE FOLLOWING ADDRESS 48 HOURS PRIOR TO COMMENCING CONSTRUCTION:

NPDES STORMWATER NOTICES CENTER, MS # 2510
FLORIDA DEPARTMENT OF ENVIRONMENTAL PROTECTION
2600 BLAIR STONE ROAD
TALLAHASSEE, FLORIDA 32399-2400

THIS FORM CAN BE OBTAINED FROM FDEP'S WEBSITE (WWW.DEP.STATE.FL.US) OR BY CONTACTING FDEP. PLEASE NOTE THAT THE CURRENT APPLICATION FEE IS \$300; HOWEVER, THIS FEE IS SUBJECT TO CHANGE WITHOUT NOTICE. ALWAYS REFER TO THE MOST CURRENT VERSION OF RULE 62-4.050(4)(D), FAC TO CONFIRM THE AMOUNT BEFORE SUBMITTING PAYMENT. IF CONSTRUCTION ACTIVITY EXCEEDS FIVE YEARS, THE CONTRACTOR MUST RE-APPLY FOR COVERAGE.

1.3 STORMWATER POLLUTION PREVENTION PLAN (SWPPP):

THE CONTRACTOR IS REQUIRED TO CERTIFY THIS STORMWATER POLLUTION PREVENTION PLAN (SWPPP) BELOW PRIOR TO SUBMITTING THE NOI. THIS SWPPP IS NOT REQUIRED TO BE SUBMITTED WITH THE NOI, BUT IS REQUIRED TO BE KEPT ON SITE DURING ALL PHASES OF CONSTRUCTION. BECAUSE EROSION AND SEDIMENT CONTROLS AND CONSTRUCTION METHODS VARY SIGNIFICANTLY FROM CONTRACTOR TO CONTRACTOR, THE CONTRACTOR CAN PROPOSE ALTERNATIVE METHODS TO THIS SWPPP THAT ARE EQUAL OR BETTER AT CONTROLLING EROSION AND SEDIMENTATION. AT A MINIMUM, THE CONTRACTOR MUST FOLLOW THE EROSION CONTROL PLAN SPECIFIED IN THE CONSTRUCTION PLANS AND DOCUMENTS. ANY MODIFICATIONS TO THIS SWPPP MUST BE DOCUMENTED AND KEPT WITH THE PLAN AS PART OF THE RECORDS KEEPING PROCESS TO BE IN FULL COMPLIANCE WITH THE CGP.

1.4 CONTRACTOR'S / SUBCONTRACTOR CERTIFICATION:

I CERTIFY UNDER PENALTY OF LAW THAT I UNDERSTAND, AND SHALL COMPLY WITH, THE TERMS AND CONDITIONS OF THE STATE OF FLORIDA GENERIC PERMIT FOR STORMWATER DISCHARGE FROM LARGE AND SMALL CONSTRUCTION ACTIVITIES AND THIS STORMWATER POLLUTION PREVENTION PLAN PREPARED THEREUNDER.

PRINT & SIGN NAME	COMPANY & ADDRESS
_____	_____
_____	_____
_____	_____
NAME & TITLE (PRINT)	

SIGNATURE	DATE
_____	_____

1.5 RESPONSIBLE AUTHORITY CERTIFICATION:

I CERTIFY UNDER PENALTY OF LAW THAT THIS DOCUMENT AND ALL ATTACHMENTS WERE PREPARED UNDER MY DIRECTION OR SUPERVISION IN ACCORDANCE WITH A SYSTEM DESIGNED TO ASSURE THAT QUALIFIED PERSONNEL GATHERED AND EVALUATED THE INFORMATION SUBMITTED. BASED ON MY INQUIRY OF THE PERSON OR PERSONS WHO MANAGE THE SYSTEM, OR THOSE PERSONS DIRECTLY RESPONSIBLE FOR GATHERING THE INFORMATION, THE INFORMATION SUBMITTED IS, TO THE BEST OF MY KNOWLEDGE AND BELIEF, TRUE, ACCURATE, AND COMPLETE. I AM AWARE THAT THERE ARE SIGNIFICANT PENALTIES FOR SUBMITTING FALSE INFORMATION, INCLUDING THE POSSIBILITY OF FINE AND IMPRISONMENT FOR KNOWING VIOLATIONS.

PRINT & SIGN NAME	COMPANY & ADDRESS
_____	_____
_____	_____
NAME & TITLE (PRINT)	

SIGNATURE	DATE
_____	_____

1.6 NOTICE OF TERMINATION (NOT):

THE CONTRACTOR IS REQUIRED TO SUBMIT A NOTICE OF TERMINATION OF GENERIC PERMIT COVERAGE (FDEP FORM 62-621.300(6)) UPON CONSTRUCTION COMPLETION TO DISCONTINUE PERMIT COVERAGE. THE NOT IS TO BE SUBMITTED TO THE FOLLOWING ADDRESS:

NPDES STORMWATER NOTICES CENTER, MS # 2510
FLORIDA DEPARTMENT OF ENVIRONMENTAL PROTECTION
2600 BLAIR STONE ROAD
TALLAHASSEE, FLORIDA 32399-2400

THIS FORM CAN BE OBTAINED FROM FDEP'S WEBSITE (WWW.DEP.STATE.FL.US) OR BY CONTACTING FDEP. THE NOT CAN NOT BE SUBMITTED UNTIL ALL DISTURBED SOILS AT THE CONSTRUCTION SITE HAVE BEEN FINALLY STABILIZED AND TEMPORARY EROSION AND SEDIMENT CONTROL MEASURES HAVE BEEN REMOVED OR WILL BE REMOVED AT AN APPROPRIATE TIME. FINAL STABILIZATION MEANS THAT ALL SOIL DISTURBING ACTIVITIES AT THE SITE HAVE BEEN COMPLETED AND THAT A UNIFORM PERENNIAL VEGETATIVE COVER WITH A DENSITY OF 70 PERCENT OF THE COVER FOR UNPAVED AREAS AND AREAS NOT COVERED BY PERMANENT STRUCTURES HAS BEEN ESTABLISHED, OR EQUIVALENT STABILIZATION MEASURES HAVE BEEN EMPLOYED. IF CONSTRUCTION ACTIVITY EXCEEDS FIVE YEARS, THE CONTRACTOR MUST RE-APPLY FOR COVERAGE.

1.7 APPLICATION INFORMATION:

PROJECT ADDRESS: 8765 ELY ROAD
PENSACOLA, FL 32501

LATITUDE: N 30°31'7.53"
LONGITUDE: W 87°12'8.41"

WATER MANAGEMENT DISTRICT: NORTHWEST FLORIDA (NWFVMD)

MS4 OPERATOR NAME: ESCAMBIA COUNTY

RECEIVING WATER NAME: EVENTUAL OUTFALL TO PENSACOLA BAY

2.0 SITE DESCRIPTION:

2.1 NATURE OF CONSTRUCTION ACTIVITIES:

THIS PROJECT INVOLVES THE CONSTRUCTION OF A 50,000 SF. OFFICE AND WAREHOUSE BUILDING. CONSTRUCTION INCLUDES PARKING, UTILITIES AND STORMWATER COLLECTION SYSTEM.

2.2 SEQUENCE OF MAJOR SOIL DISTURBING ACTIVITIES:

THE FOLLOWING SEQUENCE OF MAJOR ACTIVITIES SHALL BE FOLLOWED UNLESS THE CONTRACTOR CAN PROPOSE AN ALTERNATIVE THAT IS EQUAL TO OR BETTER AT CONTROLLING EROSION AND SEDIMENTATION. THE DETAILED SEQUENCE FOR THE ENTIRE PROJECT CAN VARY SIGNIFICANTLY FROM CONTRACTOR TO CONTRACTOR. THE CONTRACTOR IS RESPONSIBLE FOR DOCUMENTING ANY CHANGES.

1. CLEAR, GRUB AND PERFORM ALL DEMOLITION WORK.
2. COMPLETE ROUGH GRADING OF THE POND AND DIRECT ALL STORMWATER RUNOFF TO THE POND(S).
3. CONSTRUCT ALL UNDERGROUND UTILITIES AND STORM DRAIN SYSTEM.
4. CONSTRUCT ROADS (SUBGRADE, CURB & GUTTER, BASE, PAVEMENT, SIDEWALKS, AND LANDSCAPING).
5. COMPLETE STORMWATER PONDS.

2.3 AREA ESTIMATES:

ONSITE AREA: 2.00 ACRES
OFFSITE AREA: 2.00 ACRES
TOTAL AREA: 2.00 ACRES
AREA TO BE DISTURBED: 2.00 ACRES

2.4 RUNOFF DATA:

RUNOFF COEFFICIENTS (C):

BEFORE: TOTAL COMPOSITE C = 0.20 AND 0.95
DURING: VARIES BETWEEN = 0.20 AND 0.95
AFTER: VARIES BETWEEN = 0.20 AND 0.95
TOTAL COMPOSITE C = 0.70

SOILS DATA:
THE SOILS LOCATED AT THE SITE ARE PREDOMINATELY VERY LOOSE TO LOOSE SLIGHTLY SILTY SANDS. GROUNDWATER WAS NOT ENCOUNTERED IN THE 15 FT TO 20 FT DEEP TEST BORING. FOR MORE DETAILED SOILS INFORMATION, REFER TO THE GEOTECHNICAL SERVICES REPORT PREPARED BY UNIVERSAL ENGINEERING SERVICES.

DRAINAGE AREAS FOR EACH OUTFALL:

OUTFALL LOCATION	TOTAL AREA FLOWING TO POND	'C' COEFFICIENT
EXISTING CONVEYANCE	0.70	2.00
CONCRETE CONVEYANCE DITCH		

2.5 SITE MAP:

THE CONSTRUCTION PLANS ARE TO BE USED AS THE SITE MAPS. THE LOCATION OF THE REQUIRED INFORMATION IS DESCRIBED BELOW. THE SHEET NUMBERS FOR ALL THE ITEMS DISCUSSED BELOW ARE IDENTIFIED ON THE KEY SHEET OF THE CONSTRUCTION PLANS.

DRAINAGE PATTERNS: ALL DRAINAGE PATTERNS ARE SHOWN ON THE GRADING & DRAINAGE PLANS.

APPROXIMATE SLOPES: APPROXIMATE SLOPES ARE SHOWN ON THE GRADING & DRAINAGE POND SIDE SLOPES ARE SHOWN ON THE POND CROSS-SECTIONS.

AREAS OF SOIL DISTURBANCE: ALL DEMOLITION IS SHOWN ON THE EXISTING SITE CONDITIONS AND DEMOLITION AND EROSION CONTROL PLAN SHEET. ALL PROPOSED CONSTRUCTION IS SHOWN ON THE REMAINING PLANS. ANY AREAS WHERE DEMOLITION WORK OR PERMANENT FEATURES ARE SHOWN ABOVE OR BELOW GROUND WILL BE DISTURBED.

AREAS NOT TO BE DISTURBED: ANY AREAS NOT SHOWING DEMOLITION WORK OR PERMANENT FEATURES ARE ASSUMED NOT TO BE DISTURBED. IT WILL BE THE CONTRACTOR'S RESPONSIBILITY TO INDICATE ON THE PLANS ANY OF THESE AREAS THAT DO GET DISTURBED AS WELL AS ANY AREAS USED FOR STAGING AND MATERIALS STORAGE.

LOCATIONS OF CONTROLS: ALL PROPOSED TEMPORARY CONTROLS AND EXISTING PERMANENT CONTROLS ARE SHOWN ON THE EXISTING SITE, DEMOLITION AND EROSION CONTROL PLAN. ALL PROPOSED PERMANENT CONTROLS ARE SHOWN ON THE REMAINING PLANS. IT WILL BE THE CONTRACTOR'S RESPONSIBILITY TO INDICATE THE LOCATION OF ANY OTHER CONTROLS ON THE PLANS THAT ARE USED DURING CONSTRUCTION.

PERMANENT STABILIZATION IS SHOWN ON THE PLANS. IT WILL BE THE CONTRACTOR'S RESPONSIBILITY TO INDICATE THE LOCATION ON THE PLANS OF ALL TEMPORARY STABILIZATION PRACTICES USED DURING CONSTRUCTION.

SURFACE WATERS: N/A

DISCHARGE POINTS: ESCAMBIA COUNTY MS4

2.6 RECEIVING WATERS:

EVENTUAL OUTFALL TO PENSACOLA BAY

3.0 CONTROLS:

3.1 EROSION AND SEDIMENT CONTROLS:

ALL EROSION AND SEDIMENT CONTROLS SPECIFIED ON THE DEMOLITION AND EROSION CONTROL PLAN SHEETS, AND THE EROSION CONTROL DETAILS SHALL BE INSTALLED PRIOR TO ANY CONSTRUCTION OR DEMOLITION. SILT FENCING AND STAKED HAY BALES SHALL BE INSTALLED ALONG DOWN-GRADIENT LIMITS.

TEMPORARY SEEDING AND MULCHING SHALL BE APPLIED AFTER 14-DAY INTERVALS OF CEASED DISTURBANCE ACTIVITIES THAT WILL EXCEED 20-DAY PERIODS. GRADED AREAS SHALL BE STABILIZED WITH PERMANENT SEEDING, MULCHING, AND FERTILIZING, OR SODDING WITHIN FIVE DAYS OF FINAL GRADING. LANDSCAPING, INCLUDING SODDING, SHALL BE INSTALLED BY AN EXPERIENCED LANDSCAPE CONTRACTOR. PROPOSED DISTURBED AREAS WILL NOT EXCEED 8 ACRES IN ANY DRAINAGE AREA.

3.2 STORMWATER MANAGEMENT:

PROPOSED STORMWATER MANAGEMENT FACILITIES FOR THIS SITE INCLUDE: N/A

THE PROPOSED STORMWATER MANAGEMENT FACILITIES MEET ALL STORMWATER TREATMENT REQUIREMENTS AND ALL RATE CONTROL REQUIREMENTS SET FORTH BY THE LOCAL AND STATE REGULATORY AGENCIES.

3.3 OTHER CONTROLS:

WASTE DISPOSAL: THE CONTRACTOR IS RESPONSIBLE FOR ALL WASTE DISPOSAL FROM THE SITE. THE CONTRACTOR SHALL EMPLOY WASTE DISPOSAL PRACTICES THAT MEET ALL LOCAL, STATE, AND FEDERAL GUIDELINES AND PREVENT DISCHARGE OF SOLID MATERIALS TO WATERS OF THE UNITED STATES. THE CONTRACTOR IS RESPONSIBLE FOR DOCUMENTING THIS PORTION OF THE SWPPP.

OFFSITE VEHICLE TRACKING: IF OFF SITE TRACKING OF SEDIMENTS BY CONSTRUCTION VEHICLES OCCURS, THE CONTRACTOR IS REQUIRED TO INSTALL A SOIL TRACKING PREVENTION DEVICE (STPD) AS PER FDOT STANDARD INDEX 106 AT ALL EXITS TO THE SITE WHERE SEDIMENT TRACKING IS OCCURRING. THE CONTRACTOR IS ALSO RESPONSIBLE FOR DOCUMENTING THIS PORTION OF THE SWPPP.

HAZARDOUS MATERIALS: ALL POLLUTANTS AND HAZARDOUS MATERIALS INCLUDING BUT NOT LIMITED TO FERTILIZERS, HERBICIDES, PESTICIDES, SOLVENTS, OILS AND OIL FILTERS, PETROLEUM PRODUCTS, PAINT, AND EQUIPMENT MAINTENANCE FLUIDS, SHALL BE STORED INDOORS OR UNDER COVER IN AREAS WITH SECONDARY CONTAINMENT. SECONDARY CONTAINMENT PREVENTS A SPILL FROM SPREADING ACROSS THE SITE AND INCLUDES DIKES, BERMS, CURBING, OR OTHER CONTAINMENT METHODS. HAZARDOUS MATERIAL STORAGE AREAS SHALL BE INSPECTED WEEKLY AND AFTER STORM EVENTS. STORAGE AREAS SHALL BE KEPT CLEAN, WELL ORGANIZED, AND EQUIPPED WITH AMPLE CLEANUP SUPPLIES/SPILL KITS AS APPROPRIATE FOR THE MATERIALS BEING STORED. MATERIAL SAFETY DATA SHEETS, MATERIAL INVENTORY, AND EMERGENCY CONTACT INFORMATION SHALL BE MAINTAINED ON-SITE. ALL PERSONNEL SHALL RECEIVE INSTRUCTION REGARDING PROPER PROCEDURES FOR HAZARDOUS MATERIAL HANDLING AND DISPOSAL. HAZARDOUS MATERIALS SHALL NOT BE DISPOSED OF INTO ON-SITE DUMPSTERS; HAZARDOUS MATERIALS SHALL BE DISPOSED OF IN ACCORDANCE WITH FEDERAL, STATE, AND MUNICIPAL REGULATIONS. VEHICLES AND EQUIPMENT WILL BE MAINTAINED OFF-SITE. ALL VEHICLES AND EQUIPMENT INCLUDING SUBCONTRACTOR VEHICLES WILL BE CHECKED FOR LEAKING OIL AND FLUIDS. VEHICLES LEAKING FLUIDS WILL NOT BE ALLOWED ON-SITE. DRIP PANS SHALL BE PLACED UNDER ALL VEHICLES AND EQUIPMENT THAT ARE PARKED OVERNIGHT.

APPLICATION OF FERTILIZERS, HERBICIDES, AND PESTICIDES: FERTILIZERS, HERBICIDES, AND PESTICIDES SHALL BE DELIVERED TO THE SITE IN ORIGINAL, UNOPENED CONTAINERS BEARING MANUFACTURER'S CHEMICAL ANALYSIS, NAME, TRADE NAME, TRADEMARK, AND INDICATION OF CONFORMANCE TO STATE AND FEDERAL LAWS. FERTILIZERS, HERBICIDES, AND PESTICIDES SHALL BE IN APPLIED IN ACCORDANCE WITH THE MANUFACTURER'S SUGGESTED RATE.

5.0 INSPECTIONS:

QUALIFIED PERSONNEL SHALL INSPECT THE FOLLOWING ITEMS, BUT NOT LIMITED TO, AT LEAST ONCE EVERY SEVEN CALENDAR DAYS AND WITHIN 24 HOURS OF THE END OF A STORM THAT IS 0.25 INCHES OR GREATER. WHERE SITES HAVE BEEN FINALLY STABILIZED, INSPECTIONS SHALL BE CONDUCTED AT LEAST ONCE EVERY MONTH.

- POINTS OF DISCHARGE TO WATERS OF THE UNITED STATES.
- POINTS OF DISCHARGE TO MUNICIPAL SEPARATE STORM SEWER SYSTEMS.
- DISTURBED AREAS OF THE SITE THAT HAVE NOT BEEN FINALLY STABILIZED.
- AREAS USED FOR STORAGE OF MATERIALS THAT ARE EXPOSED TO PRECIPITATION.
- STRUCTURAL CONTROLS.
- STORMWATER MANAGEMENT SYSTEMS.
- LOCATIONS WHERE VEHICLES ENTER OR EXIT THE SITE.

6.0 NON-STORMWATER DISCHARGES:

THE CONTRACTOR SHALL BE RESPONSIBLE FOR REPORTING ANY HAZARDOUS SUBSTANCE SPILLS THAT MAY EQUAL OR EXCEED A REPORTABLE QUANTITY (RQ). REFER TO EPA'S LIST OF HAZARDOUS SUBSTANCES AND REPORTABLE QUANTITIES (EPA 40 CFR 302.4 & 117). V THIS LIST CAN BE OBTAINED FROM EPA'S WEBSITE (WWW.EPA.GOV) OR BY CONTACTING EPA. IF AN RQ RELEASE DOES OCCUR THE CONTRACTOR SHALL PERFORM THE FOLLOWING PROCEDURES:

- NOTIFY THE NATIONAL RESPONSE CENTER IMMEDIATELY AT 800-424-8802.
- PROVIDE WRITTEN DESCRIPTION OF THE RELEASE WITHIN 14 DAYS PROVIDING DATES, CAUSE AND PREVENTION METHODS TO THE REGIONAL EPA OFFICE.
- MODIFY THE SWPPP AS NECESSARY TO ADDRESS ADDED PREVENTION METHODS.

7.0 IMPLEMENTATION CHECKLIST:

7.1 RECORDS:

THE CONTRACTOR SHALL MAINTAIN RECORDS OF CONSTRUCTION ACTIVITIES INCLUDING, BUT NOT LIMITED TO:

- DATES WHEN MAJOR GRADING ACTIVITIES OCCUR.
- DATES WHEN CONSTRUCTION ACTIVITIES TEMPORARILY CEASE ON A PORTION OF THE SITE.
- DATES WHEN CONSTRUCTION ACTIVITIES PERMANENTLY CEASE ON A PORTION OF THE SITE.
- DATES WHEN STABILIZATION MEASURES ARE INITIATED ON THE SITE.

7.2 INSPECTION REPORTS:

THE CONTRACTOR SHALL PREPARE INSPECTION REPORTS SUMMARIZING THE FOLLOWING, BUT NOT LIMITED TO:

- NAME OF INSPECTOR.
- QUALIFICATIONS OF INSPECTOR.
- MEASURES/AREAS INSPECTED.
- OBSERVED CONDITIONS.
- CHANGES NECESSARY TO THE SWPPP.

7.3 RELEASES OF REPORTABLE QUANTITIES OF OIL OR HAZARDOUS MATERIALS:

THE CONTRACTOR SHALL REPORT ANY RELEASES OF REPORTABLE QUANTITIES OF OIL OR HAZARDOUS MATERIALS IF THEY OCCUR AS PER THE MEASURES OUTLINED IN SECTION 6.0 OF THE SWPPP.

7.4 SWPPP MODIFICATION:

THE CONTRACTOR SHALL MODIFY THE SWPPP AS NECESSARY TO:

- COMPLY WITH MINIMUM PERMIT REQUIREMENTS WHEN NOTIFIED BY FDEP THAT THE PLAN DOES NOT COMPLY.
- ADDRESS ANY CHANGES IN DESIGN, CONSTRUCTION OPERATIONS OR MAINTENANCE, WHICH HAS AN EFFECT ON THE POTENTIAL FOR DISCHARGE OF POLLUTANTS.
- PREVENT REOCCURRENCE OF REPORTABLE QUANTITY RELEASES OF HAZARDOUS MATERIAL OR OIL.

8.0 TERMINATION CHECKLIST:

THE FOLLOWING ITEMS SHALL BE COMPLETE BEFORE SUBMITTING THE NOT:

- ALL SOIL DISTURBING ACTIVITIES ARE COMPLETE.
- TEMPORARY EROSION AND SEDIMENT CONTROL MEASURES HAVE BEEN REMOVED OR WILL BE REMOVED AT AN APPROPRIATE TIME.
- ALL AREAS OF THE CONSTRUCTION SITE NOT OTHERWISE COVERED BY PERMANENT PAVEMENT OR STRUCTURE HAVE BEEN STABILIZED WITH UNIFORM PERENNIAL VEGETATIVE COVER WITH A DENSITY OF 70% OR EQUIVALENT MEASURES HAVE BEEN EMPLOYED.

PAUL A. BATTLE, P.E.
Professional Engineer
No. 53128
Date: 03-26-2020

RBA
REBOL-BATTLE & ASSOCIATES
Civil Engineers and Surveyors
2301 N. Ninth Avenue, Suite 300
Pensacola, Florida 32503
Telephone: 850-686-0600 Fax: 850-686-0448
E: 686-0607 F: 686-0448

**NPDES - STORMWATER
POLLUTION PREVENTION
PLAN**

Ely Road Spec Warehouse
8765 Ely Road
Escambia County, Florida

REVISION	DATE	ESCO/OWNER COMMENTS
1	04-23-2020	

DATE: 04-23-2020
JOB NO.: 2015.204
DATE: 03-26-2020

DRAWING No.
C1.3
SHEET 5 OF 12

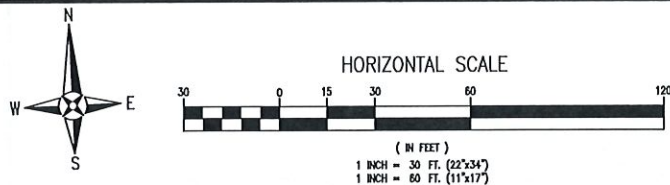

03-15-29-1002-000-000
 ESCAMBIA COUNTY
 221 PALAFOX PL. STE 420
 PENSACOLA, FL 32502
 LOCATION: 8820 PAUL STARR 32514
 USE: COUNTY OWNED
 ZONE: HC/LI FLU: I

RBA
REBOL-BATTLE & ASSOCIATES
 Civil Engineers and Surveyors
 2301 N. Ninth Avenue, Suite 300
 Pensacola, Florida 32503
 Telephone 850.438.0400 Fax 850.438.0448
 EB 00009657 LB7916

SITE LAYOUT & DIMENSION PLAN

Ely Road Spec Warehouse
 8765 Ely Road
 Escambia County, Florida

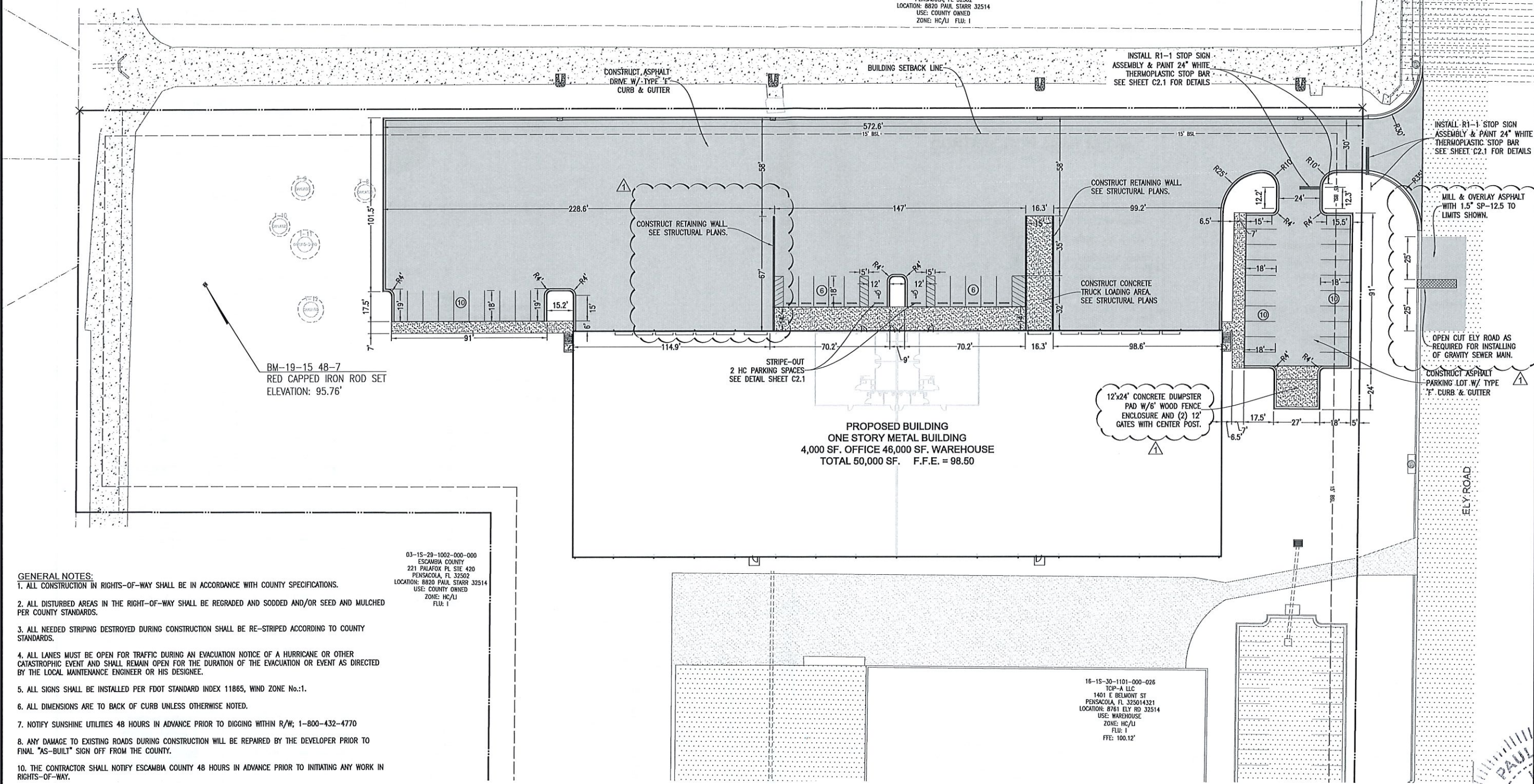

- GENERAL NOTES:**
1. ALL CONSTRUCTION IN RIGHTS-OF-WAY SHALL BE IN ACCORDANCE WITH COUNTY SPECIFICATIONS.
 2. ALL DISTURBED AREAS IN THE RIGHT-OF-WAY SHALL BE REGRADED AND SODDED AND/OR SEED AND MULCHED PER COUNTY STANDARDS.
 3. ALL NEEDED STRIPING DESTROYED DURING CONSTRUCTION SHALL BE RE-STRIPED ACCORDING TO COUNTY STANDARDS.
 4. ALL LANES MUST BE OPEN FOR TRAFFIC DURING AN EVACUATION NOTICE OF A HURRICANE OR OTHER CATASTROPHIC EVENT AND SHALL REMAIN OPEN FOR THE DURATION OF THE EVACUATION OR EVENT AS DIRECTED BY THE LOCAL MAINTENANCE ENGINEER OR HIS DESIGNEE.
 5. ALL SIGNS SHALL BE INSTALLED PER FDOT STANDARD INDEX 11865, WIND ZONE No.1.
 6. ALL DIMENSIONS ARE TO BACK OF CURB UNLESS OTHERWISE NOTED.
 7. NOTIFY SUNSHINE UTILITIES 48 HOURS IN ADVANCE PRIOR TO DIGGING WITHIN R/W; 1-800-432-4770
 8. ANY DAMAGE TO EXISTING ROADS DURING CONSTRUCTION WILL BE REPAIRED BY THE DEVELOPER PRIOR TO FINAL "AS-BUILT" SIGN OFF FROM THE COUNTY.
 10. THE CONTRACTOR SHALL NOTIFY ESCAMBIA COUNTY 48 HOURS IN ADVANCE PRIOR TO INITIATING ANY WORK IN RIGHTS-OF-WAY.

AREA CALCULATIONS:
 PROJECT AREA = 167,025 SF
 EXISTING BUILDING AREA = 0 SF
 EXISTING IMPERVIOUS AREA = 0 SF
 EXISTING PERVIOUS AREA = 167,025 SF
 PROPOSED BUILDING AREA = 50,000 SF
 PROPOSED IMPERVIOUS AREA = 112,125 SF (73%)
 PROPOSED PERVIOUS AREA = 45,900 SF (27%)
 PROPOSED LANDSCAPED AREA = 45,900 SF (27%)

PARKING REQUIREMENTS:
 TOTAL REQUIRED PARKING SPACES (WAREHOUSE)
 0.5 SPACE PER 1000 SF = 46,000/1000=46x0.5 = 23
 TOTAL REQUIRED PARKING SPACES (OFFICE)
 3.5 SPACE PER 1000 SF = 4,000/1000=4x3.5 = 14 (14)
 TOTAL PARKING SPACES REQUIRED = 37
 TOTAL PARKING SPACES PROVIDED = 42
 STANDARD PARKING SPACES = 40
 H.C. PARKING SPACES = 2
 (1 H.C. / 25 SPACES MINIMUM)

EVACUATION NOTE:
 ALL LANES MUST BE OPEN FOR TRAFFIC DURING AN EVACUATION NOTICE OF A HURRICANE OR OTHER CATASTROPHIC EVENT AND SHALL REMAIN OPEN FOR THE DURATION OF THE EVACUATION OR EVENT AS DIRECTED BY THE LOCAL MAINTENANCE ENGINEER OR HIS DESIGNEE.

WELLHEAD PROTECTION NOTE:
 THE SUBJECT PARCEL FALLS WITHIN THE TRAVEL TIME CONTOUR OF A PROTECTED (POTABLE) WELLHEAD. CONTRACTORS SHALL BE RESPONSIBLE FOR REPORTING SPILLS OF POTENTIALLY HAZARDOUS SUBSTANCES (I.E. GASOLINE, DIESEL FUEL, HYDRAULIC FLUID, CLEANING PRODUCTS, CHEMICALS, ETC.) TO THE APPROPRIATE STATE (FDEP STATE WARNING POINT (1-800-320-0519) AND LOCAL (ESCAMBIA COUNTY HEALTH DEPARTMENT/ENVIRONMENTAL HEALTH 595-6712) AGENCIES.*

PROJECT NOTES:
 TRASH PICK-UP WILL BE PROVIDED BY ON-SITE DUMPSTER.

LEGEND

	EXISTING ASPHALT
	EXISTING CONCRETE
	PROPOSED ASPHALT
	PROPOSED CONCRETE
	BOUNDARY LINE
	EASEMENT LINE
	LOT LINE
	RIGHT-OF-WAY LINE

REVISION	DATE	ESCO/OWNER COMMENTS
1	04-23-2020	

PAUL J. REBOL-BATTLE, P.E.
 051912020
 106-26-2020
 DRAWING No. **C2.0**
 SHEET 6 OF 12

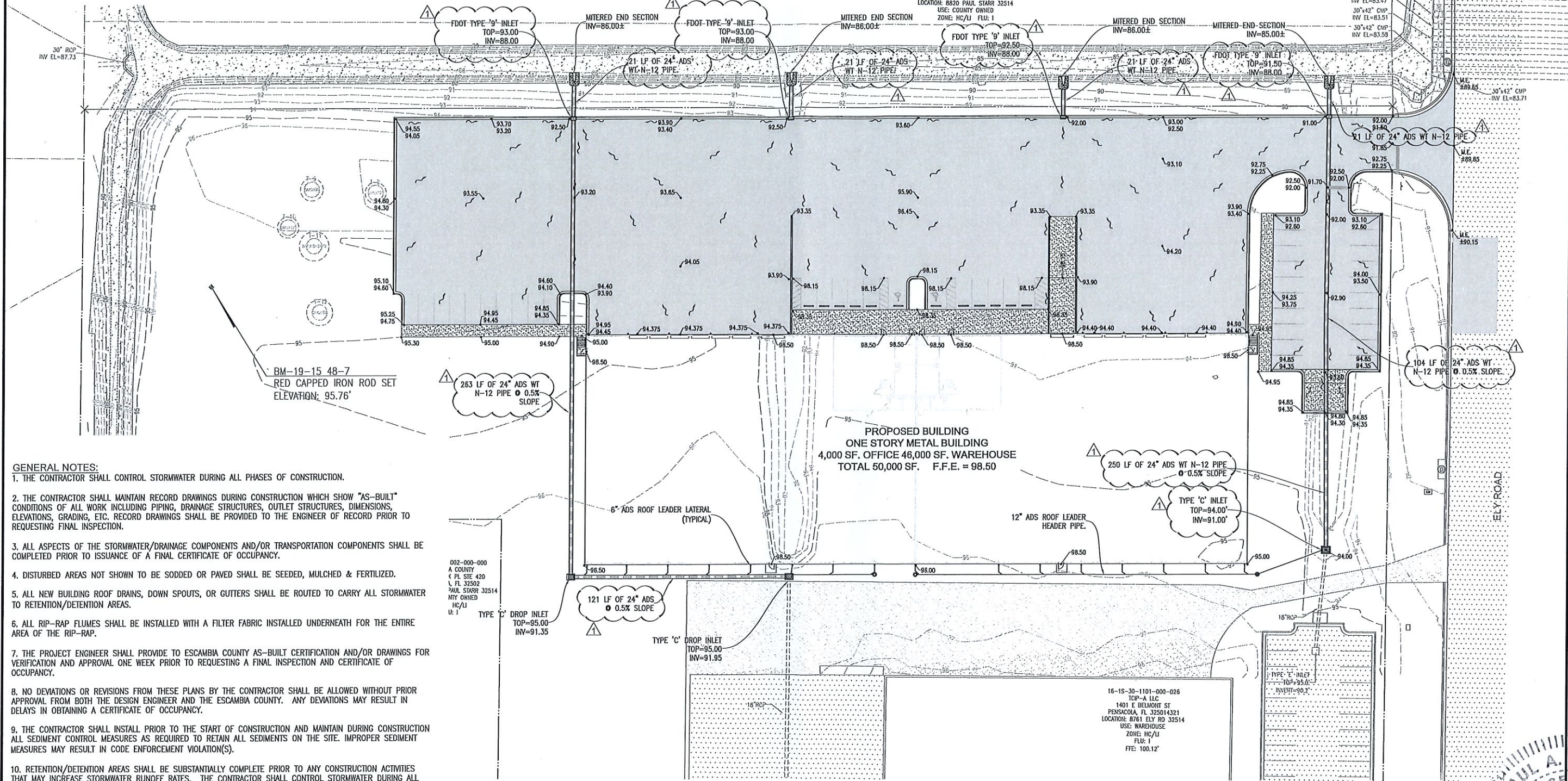
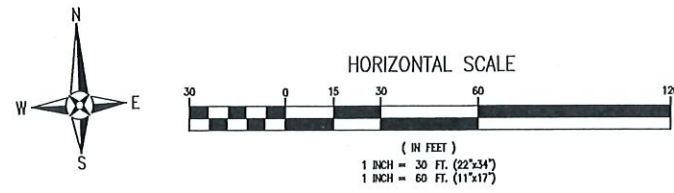

- GENERAL NOTES:**
1. THE CONTRACTOR SHALL CONTROL STORMWATER DURING ALL PHASES OF CONSTRUCTION.
 2. THE CONTRACTOR SHALL MAINTAIN RECORD DRAWINGS DURING CONSTRUCTION WHICH SHOW "AS-BUILT" CONDITIONS OF ALL WORK INCLUDING PIPING, DRAINAGE STRUCTURES, OUTLET STRUCTURES, DIMENSIONS, ELEVATIONS, GRADING, ETC. RECORD DRAWINGS SHALL BE PROVIDED TO THE ENGINEER OF RECORD PRIOR TO REQUESTING FINAL INSPECTION.
 3. ALL ASPECTS OF THE STORMWATER/DRAINAGE COMPONENTS AND/OR TRANSPORTATION COMPONENTS SHALL BE COMPLETED PRIOR TO ISSUANCE OF A FINAL CERTIFICATE OF OCCUPANCY.
 4. DISTURBED AREAS NOT SHOWN TO BE SODDED OR PAVED SHALL BE SEEDED, MULCHED & FERTILIZED.
 5. ALL NEW BUILDING ROOF DRAINS, DOWN SPOUTS, OR GUTTERS SHALL BE ROUTED TO CARRY ALL STORMWATER TO RETENTION/DETENTION AREAS.
 6. ALL RIP-RAP FLUMES SHALL BE INSTALLED WITH A FILTER FABRIC INSTALLED UNDERNEATH FOR THE ENTIRE AREA OF THE RIP-RAP.
 7. THE PROJECT ENGINEER SHALL PROVIDE TO ESCAMBIA COUNTY AS-BUILT CERTIFICATION AND/OR DRAWINGS FOR VERIFICATION AND APPROVAL ONE WEEK PRIOR TO REQUESTING A FINAL INSPECTION AND CERTIFICATE OF OCCUPANCY.
 8. NO DEVIATIONS OR REVISIONS FROM THESE PLANS BY THE CONTRACTOR SHALL BE ALLOWED WITHOUT PRIOR APPROVAL FROM BOTH THE DESIGN ENGINEER AND THE ESCAMBIA COUNTY. ANY DEVIATIONS MAY RESULT IN DELAYS IN OBTAINING A CERTIFICATE OF OCCUPANCY.
 9. THE CONTRACTOR SHALL INSTALL PRIOR TO THE START OF CONSTRUCTION AND MAINTAIN DURING CONSTRUCTION ALL SEDIMENT CONTROL MEASURES AS REQUIRED TO RETAIN ALL SEDIMENTS ON THE SITE. IMPROPER SEDIMENT MEASURES MAY RESULT IN CODE ENFORCEMENT VIOLATION(S).
 10. RETENTION/DETENTION AREAS SHALL BE SUBSTANTIALLY COMPLETE PRIOR TO ANY CONSTRUCTION ACTIVITIES THAT MAY INCREASE STORMWATER RUNOFF RATES. THE CONTRACTOR SHALL CONTROL STORMWATER DURING ALL PHASES OF CONSTRUCTION AND TAKE ADEQUATE MEASURES TO PREVENT THE EXCAVATED POND FROM BLINDING DUE TO SEDIMENTS.
 11. NOTIFY SUNSHINE UTILITIES 48 HOURS IN ADVANCE PRIOR TO DIGGING WITHIN RIGHT-OF-WAY. (1-800-432-4770)
 12. THE DEVELOPER/CONTRACTOR SHALL RESHAPE PER PLAN SPECIFICATIONS, CLEAN-OUT ACCUMULATED SILT, AND STABILIZE RETENTION PONDS AT THE END OF CONSTRUCTION WHEN ALL DISTURBED AREAS HAVE BEEN STABILIZED AND PRIOR TO REQUEST FOR INSPECTION.
 13. THE OWNER OR HIS AGENT SHALL ARRANGE/SCHEDULE WITH THE COUNTY A FINAL INSPECTION OF THE DEVELOPMENT UPON COMPLETION AND ANY INTERMEDIATE INSPECTIONS (595-3434). AS-BUILT CERTIFICATION IS REQUIRED PRIOR TO REQUEST FOR FINAL INSPECTION/APPROVAL.
 14. THE PROJECT ENGINEER SHALL PROVIDE TO ESCAMBIA COUNTY "AS-BUILT" RECORD DRAWINGS FOR VERIFICATION AND APPROVAL BY ESCAMBIA COUNTY ONE WEEK PRIOR TO REQUESTING A FINAL INSPECTION AND CERTIFICATE OF OCCUPANCY, OR PROVIDE "AS-BUILT" CERTIFICATION THAT THE PROJECT CONSTRUCTION ADHERES TO THE PERMITTED PLANS AND SPECIFICATIONS. THE "AS-BUILT" CERTIFICATION OR THE "AS-BUILT" RECORD DRAWINGS MUST BE SIGNED, SEALED AND DATED BY A REGISTERED FLORIDA PROFESSIONAL ENGINEER.

LEGEND			
	EXISTING ASPHALT		EXISTING CONTOUR
	EXISTING CONCRETE		PROPOSED CONTOUR
	PROPOSED ASPHALT		BENCHMARK
	PROPOSED CONCRETE		GUY ANCHOR
	PROPOSED GRAVEL		FLOW ARROW
	BOUNDARY LINE		EXISTING SPOT ELEVATION
	EASEMENT LINE		PROPOSED SPOT ELEVATION
	LOT LINE		PROPOSED SPOT ELEVATION MEET EXISTING
	RIGHT-OF-WAY LINE		
	UTILITY POLE		
	LIGHT POLE		
	TELEPHONE BOX		
	100.00 (BACK OF CURB)		
	99.50 (EDGE OF PAVEMENT)		

03-15-29-1002-000-000
 ESCAMBIA COUNTY
 221 PALAFOX PL. STE 420
 PENSACOLA, FL 32502
 LOCATION: 8761 ELY ROAD, STARR 32514
 USE: COUNTY OWNED
 ZONE: HC/LI FLU: I

16-15-30-1101-000-026
 TOP-A LLC
 1401 E BELMONT ST
 PENSACOLA, FL 325014321
 LOCATION: 8761 ELY RD 32514
 USE: WAREHOUSE
 ZONE: HC/LI
 FLU: I
 FFE: 100.12'

002-000-000
 A COUNTY
 FL. SITE 420
 FL. 32502
 PAUL STARR 32514
 NY OWNED
 HC/LI
 U: I

PAUL A. STARR
 LICENSED PROFESSIONAL ENGINEER
 No. 53126
 E. Paul A. Starr, P.E.
 No. 53126
 Dr. By: [Signature]
 Ck By: PAB
 Job No.: 2015.204
 Date: 03-26-2020

RBA
REBOL-BATTLE & ASSOCIATES
 Civil Engineers and Surveyors
 2301 N. Ninth Avenue, Suite 300
 Pensacola, Florida 32503
 Telephone: 850.438.0400 Fax: 850.438.0448
 E-mail: info@rba.com Website: www.rba.com

GRADING & DRAINAGE PLAN

Ely Road Spec Warehouse
 8765 Ely Road
 Escambia County, Florida

NO.	DATE	REVISION

SEAL
 PERMIT DRAWINGS
 No. 53126
 Dr. By: [Signature]
 Ck By: PAB
 Job No.: 2015.204
 Date: 03-26-2020

DRAWING No.
C3.0
 SHEET 8 OF 12

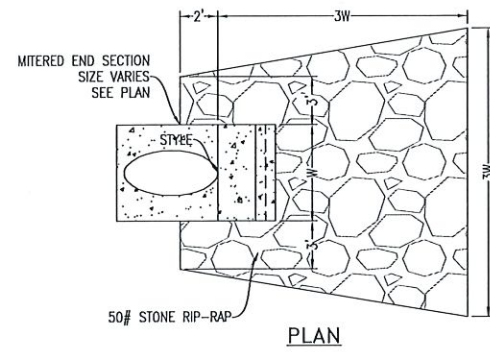

RIP-RAP DETAIL
N.T.S.

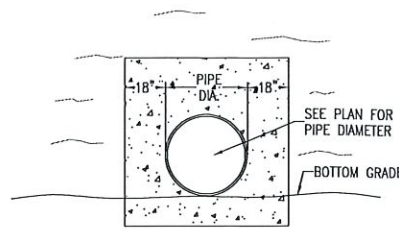
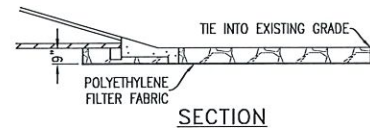

MITERED END SECTION
N.T.S.

NOTE:
CUT DRAIN PIPE ENDS TO MITERED SECTIONS. COMPACT SOIL ADJACENT TO ENDS AND SOD ACCORDINGLY. ALSO, COMPACT SOIL LIFT COVERING DRAIN PIPES AND SOD ACCORDINGLY.

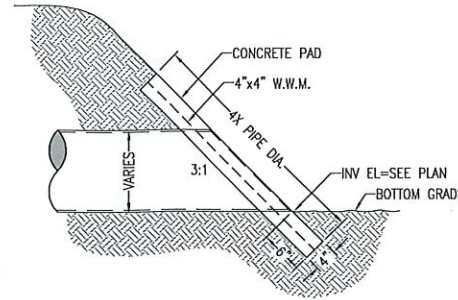

TYPICAL SECTION

- NOTES:**
1. MANHOLE SHALL CONFORM TO A.S.T.M. C 478 SPECIFICATIONS WITH 4000 PSI CONCRETE.
 2. DIAMETER OF OPENING FOR PIPE SHALL BE 1" LARGER DIAMETER THAN BELL OF THE PIPE BEING USED.
 3. JOINTING COMPOUND SHALL BE RAM NECK, TYPE 1, ROPE FORM PLASTIC GASKET OR EQUAL.
 4. ALL PATCHING TO BE DONE WITH HYDRAULIC CEMENT. NO MORTAR REPAIRS PERMITTED.
 5. CONCRETE TO BE 2500 P.S.I., REINFORCING STEEL TO BE A.S.T.M. A 615 GRADE 60 OR PROVIDE PRE-CAST MANHOLE BASE SECTION IN CONFORMANCE WITH ASTM C-478.
 6. SEAL WITH A-LOK, KORE-N-SEAL OR LOCK-JOINT PER SPECIFICATION 2570-2.03.
 7. CAST IN PLACE MANHOLE MAY BE ALLOWED IN PRE-APPROVED LOCATIONS.

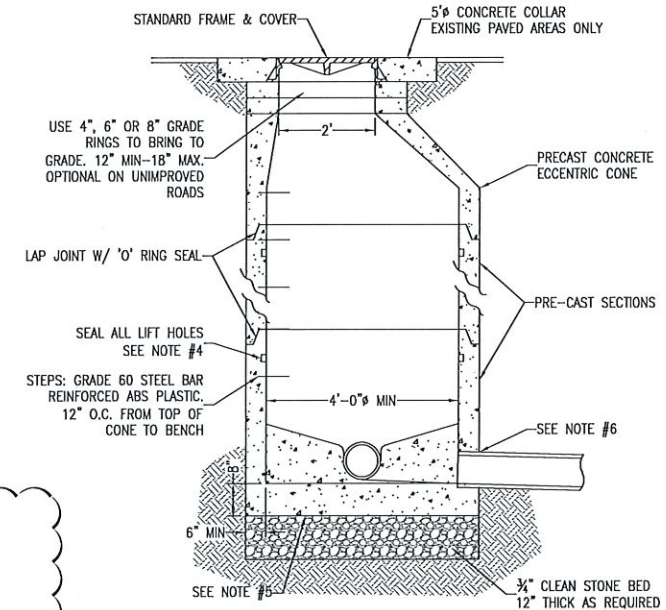

STORMWATER MANHOLE DETAIL
N.T.S.

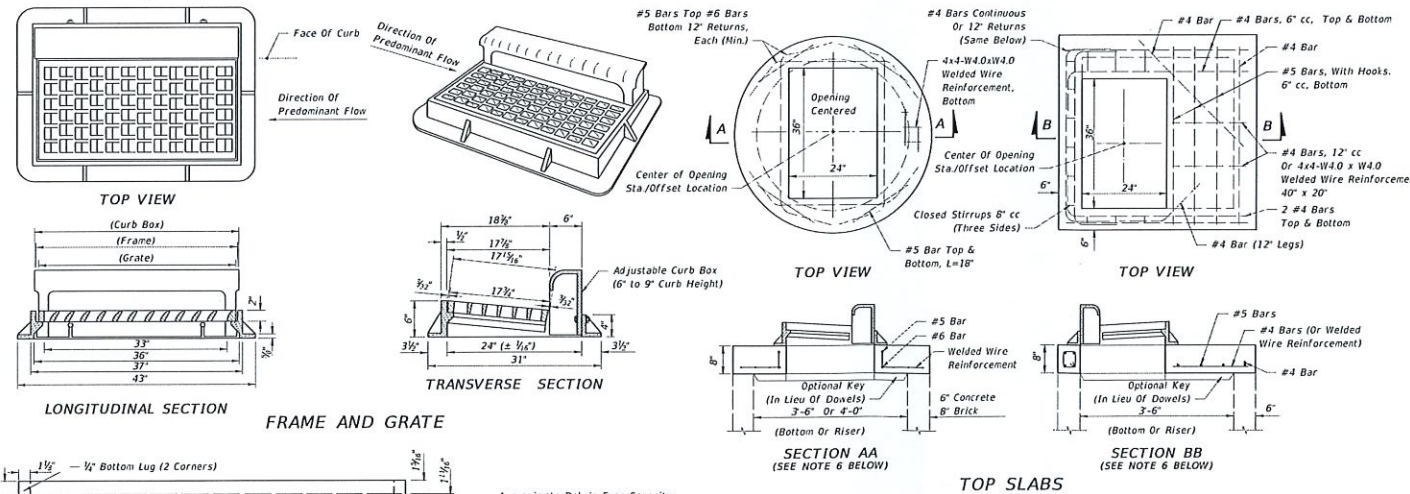

- GENERAL NOTES**
1. This inlet is primarily intended for locations with light to moderate flows where right of way does not permit the use of throated curb inlets Types 1 through 6. The typical application is on curb returns to city streets. The inlet grate is suitable for pedestrian and bicycle traffic.
 2. This inlet to be located outside of curb ramp area in vertical faced curbs such as Curb and Gutter Type F. Grate shall be oriented with vanes directed toward Predominant flow.
 3. For structure bottoms see Index No. 200. For supplemental details see Index No. 201.
 4. All steel in slab tops shall have 1 1/2" minimum cover unless otherwise shown. Tops shall be either cast-in-place or precast concrete.
 5. For Alternate B applications, top slab openings shall be placed such that 2 edges of inlet frame will be located directly above bottom wall or riser wall.
 6. When used on a structure with dimensions larger than those detailed above and risers are not applied, the top slab shall be constructed using Index No. 200 with the slab opening adjusted to 24"x36". The "Special Top Slab" on Index No. 200 is not permitted.
 7. Frame may be adjusted with one to six courses of brick.
 8. Vaned grates with approximately equal openings will be permitted that satisfy AASHTO HL-93 loading. Grates shall be reversible, right or left.

LAST REVISION 11/01/16	DESCRIPTION:	FDOT DESIGN STANDARDS	FY 2017-18	INDEX NO. 214	SHEET NO. 1 of 1
---------------------------	--------------	--------------------------	------------	------------------	---------------------

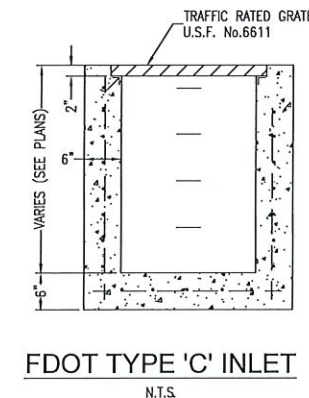
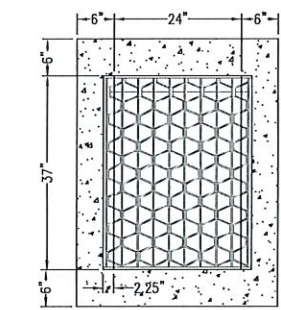

RBA
REBOL-BATTLE & ASSOCIATES
Civil Engineers and Surveyors
2301 N. Ninth Avenue, Suite 300
Pensacola, Florida 32503
Telephone 850.438.0400 Fax 850.438.0448
EE 0000957 137916

**GRADING & DRAINAGE
DETAILS**

Ely Road Spec Warehouse
8765 Ely Road
Escambia County, Florida

REVISION	DATE	BY	CHK

PAUL A. BATTLE
LICENSED PROFESSIONAL ENGINEER
No. 53126
SCALE OF
DATE: 03-26-2020
Dr. By: GTP
Chk. By: PAB
Job No.: 2015.204
Date: 03-26-2020

DRAWING No.
C3.1
SHEET 9 OF 12

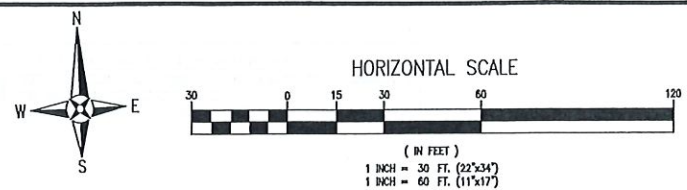

03-15-29-1002-000-000
 ESCAMBA COUNTY
 221 PALAFOX PL STE 420
 PENSACOLA, FL 32502
 LOCATION: 8820 PAUL STARR 32514
 USE: COUNTY OWNED
 ZONE: HC/LJ FLU: I

30"x42" CMP
 INV EL=83.67
 30"x42" CMP
 INV EL=83.66
 30"x42" CMP
 INV EL=83.47
 30"x42" CMP
 INV EL=83.47
 30"x42" CMP
 INV EL=83.51
 30"x42" CMP
 INV EL=83.58

TOP EL=90.87
 INV EL = 0.00

BM-19-15 48-7
 RED CAPPED IRON ROD SET
 ELEVATION: 95.76'

CONNECT 2" WATER SERVICE LINE TO BUILDING STUB-OUT. REFER TO PLUMBING PLAN SHEET P101 FOR EXACT LOCATION.
 CONNECT 6" FIRE SERVICE LINE TO BUILDING STUB-OUT. REFER TO PLUMBING PLANS FOR EXACT LOCATION.

PROPOSED BUILDING
 ONE STORY METAL BUILDING
 4,000 SF. OFFICE 46,000 SF. WAREHOUSE
 TOTAL 50,000 SF. F.F.E. = 98.50

CONNECT 4" SEWER LATERAL TO BUILDING STUB-OUT. REFER TO PLUMBING PLAN SHEET P101 FOR EXACT LOCATION.

EXISTING ECUA 8" WATER MAIN
 30"x42" CMP
 INSTALL 1/4" METER. WATER METER SHALL BE IN THE RIGHT-OF-WAY
 8"x2" SADDLE TAP, CC THREAD 2" BLUE ENDOT PE TUBING WITH BLUE TRACER WIRE. MAINTAIN 18" SEPARATION BETWEEN TAPS.
 CONNECT TO EXISTING 8" WATER MAIN WITH 8"x6" TAPPING SLEEVE AND VALVE. MAINTAIN 18" SEPARATION BETWEEN TAPS. CONTRACTOR SHALL NOTIFY ECUA AT LEAST 72 HOURS BEFORE CONNECTION. ECUA PERSONNEL SHALL BE PRESENT AT TIME OF CONNECTION.

INSTALL FIRE HYDRANT ASSEMBLY
 INSTALL 6" OWNER CONTROL GATE VALVE.
 INSTALL 6" DOUBLE DETECTOR CHECK BACKFLOW PREVENTER W/ INTEGRATED FDC. SEE DETAIL SHEET C4.1

CONNECT SEWER LATERAL TO EXISTING 10" SEWER MAIN. CONTRACTOR SHALL NOTIFY ECUA AT LEAST 48 HOURS BEFORE CONNECTION. ECUA PERSONNEL SHALL BE PRESENT AT TIME OF CONNECTION.

OPEN CUT AND PATCH ELY ROAD AS REQUIRED FOR INSTALLING OF GRAVITY SEWER MAIN. SEE CUT AND PATCH DETAIL SHEET C4.1
 MILL & OVERLAY ASPHALT WITH 1.5" SP-12.5 TO LIMITS SHOWN.

- UTILITY NOTES:**
- IT IS THE CONTRACTOR'S RESPONSIBILITY TO DETERMINE THE EXACT LOCATION AND DEPTH OF EXISTING UTILITIES AND TO DETERMINE IF OTHER UTILITIES WILL BE ENCOUNTERED DURING THE COURSE OF THE WORK AND TAKE WHATEVER STEPS NECESSARY TO PROVIDE FOR THEIR PROTECTION.
 - THE CONTRACTOR SHALL COORDINATE WITH ECUA, GULF POWER, OR ANY OTHER UTILITY COMPANIES HAVING JURISDICTION FOR REMOVAL/RELOCATION AND/OR PROTECTION OF EXISTING UTILITY POLES, AERIAL LINES, FIRE HYDRANTS, AND OTHER UTILITIES AS NECESSARY TO COMPLETE CONSTRUCTION.
 - ALL NEW WATER LINES SHALL BE CLEANED, DISINFECTED, PRESSURE TESTED, AND BACTERIOLOGICALLY CLEANED FOR SERVICE IN ACCORDANCE WITH THE LATEST AWWA STANDARDS AND THE FLORIDA DEPARTMENT OF ENVIRONMENTAL PROTECTION RULES AND REGULATIONS.
 - ALL WATER MAINS SHALL BE NSF APPROVED FOR POTABLE WATER USE.
 - MAINTAIN 18 INCH MINIMUM VERTICAL SEPARATION BETWEEN ALL POTABLE WATER MAINS AND SANITARY SEWER GRAVITY LINES. (WATER ABOVE SEWER).
 - THE TOP OF ALL CLEANOUTS SHALL BE FLUSH WITH THE PAVEMENT OR, WHEN NOT IN THE PAVEMENT, FLUSH WITH THE FINISH GRADE. CONNECTION POINTS FOR UTILITIES SHALL BE CLEARLY MARKED FOR FUTURE BUILDING CONNECTION. COORDINATE WITH THE PLUMBING CONTRACTOR.
 - ALL WATER AND SEWER WORK SHALL BE IN ACCORDANCE WITH THE LATEST EDITION OF THE ECUA ENGINEERING MANUAL.
 - ADEQUATE PROVISIONS SHALL BE MADE FOR THE FLOW OF SEWERS, DRAINS AND WATER COURSES ENCOUNTERED DURING CONSTRUCTION.
 - THE CONTRACTOR SHALL NOTIFY THE APPROPRIATE UTILITY COMPANIES 72 HOURS (3 BUSINESS DAYS) PRIOR TO BEGINNING CONSTRUCTION.
 - ALL NEW WATER AND SEWER SERVICE LINES SHALL HAVE A MINIMUM COVER OF 30 INCHES (MAXIMUM 36"), UNLESS OTHERWISE NOTED.
 - THE CONTRACTOR IS TO RESTORE ALL DISTURBED RIGHTS-OF-WAY IN ACCORDANCE WITH ESCAMBA COUNTY AND THE ECUA GUIDELINES.
 - THE CONTRACTOR SHALL COORDINATE WITH THE PLUMBING CONTRACTOR FOR BUILDING UTILITY CONNECTIONS.
 - ALL CONNECTIONS TO THE ECUA WATER AND SEWER SYSTEM SHALL BE MADE WITH ECUA PERSONNEL PRESENT.
 - ANY REMOVAL OR RELOCATION OF ECUA WATER/SEWER UTILITIES MUST BE APPROVED IN WRITING PRIOR TO THE WORK BEING DONE.

LEGEND	
	EXISTING ASPHALT
	EXISTING CONCRETE
	PROPOSED ASPHALT
	PROPOSED CONCRETE
	BOUNDARY LINE
	LOT LINE
	RIGHT-OF-WAY LINE
	WATER LINE
	SEWER LINE (GRAVITY)
	FORCE MAIN
	OVERHEAD UTILITIES
	GAS LINE
	UTILITY POLE
	GUY WIRE
	SIGN
	CLEAN OUT
	SEWER MANHOLE
	BENCHMARK
	FIRE HYDRANT
	WATER METER
	WATER VALVE

UTILITY DETAIL REFERENCE NOTE:
 REFER TO ECUA ENGINEERING MANUAL (09-01-2016) DIVISION 4 FOR ALL ECUA STANDARD DETAILS.

16-15-30-1101-000-026
 TCP-A LLC
 1401 E BELMONT ST
 PENSACOLA, FL 325014321
 LOCATION: 8761 ELY RD 32514
 USE: WAREHOUSE
 ZONE: HC/LJ
 FLU: I
 FFE: 100.12'

PAUL BATTLE, P.E.
 PROFESSIONAL ENGINEER
 No. 53126
 STATE OF FLORIDA
 DR BY: GTP
 CK BY: PAB
 Job No.: 2015-204
 Date: 03/26-2020

RBA
REBOL-BATTLE & ASSOCIATES
 Civil Engineers and Surveyors
 2307 N. Ninth Avenue, Suite 300
 Pensacola, Florida 32503
 Telephone: 904.468.0446
 Fax: 904.468.0448
 E-mail: RBAS@RBA-FL.COM

UTILITY PLAN

Ely Road Spec Warehouse
 8765 Ely Road
 Escambia County, Florida

No.	DATE	REVISION	ESCO/OWNER COMMENTS
1	04-23-2020		

DRAWING No.
C4.0
 SHEET 10 OF 12

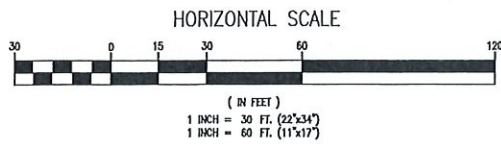

03-15-29-1002-000-000
 ESCAMBA COUNTY
 221 PALAFOX PL. STE 420
 PENSACOLA, FL 32502
 LOCATION: 8820 PAUL STARR 32514
 USE: COUNTY OWNED
 ZONE: HC/LI FLU: 1

03-15-29-1002-000-000
 ESCAMBA COUNTY
 221 PALAFOX PL. STE 420
 PENSACOLA, FL 32502
 LOCATION: 8820 PAUL STARR 32514
 USE: COUNTY OWNED
 ZONE: HC/LI
 FLU: 1

16-15-30-1101-000-026
 TOP-A LLC
 1401 E BELMONT ST
 PENSACOLA, FL 325014321
 LOCATION: 8765 ELY RD 32514
 USE: WAREHOUSE
 ZONE: HC/LI
 FLU: 1
 FFE: 100.12'

PROPOSED BUILDING
 ONE STORY METAL BUILDING
 4,000 SF. OFFICE 46,000 SF. WAREHOUSE
 TOTAL 50,000 SF. F.F.E. = 98.50

REPLACEMENT RATIO: (DSM 2-5.2 (a))
 TOTAL PROTECTED TREE TRUNK DIAMETER (DBH) REMOVED = 110 INCHES
 110 x 0.50 = 55 INCHES. TOTAL CALIPER REPLACEMENT = 55 INCHES

REPLACEMENT LIMITS: (DSM 2-5.2 (a))
 TOTAL TREE REPLACEMENT FOR NON-HERITAGE TREES NEED NOT EXCEED 25 CALIPER INCHES PER
 DEVELOPMENT SITE ACRE.
 TOTAL DEVELOPMENT SITE = 3.83 ACRE X 25 = 95.75
 REPLACEMENT LIMITS = 96 INCHES

REQUIRED TOTAL CALIPER REPLACEMENT = 55 INCHES

TOTAL 2.5 INCH TREES REQUIRED = 22, OR TOTAL 3 INCH TREES REQUIRED = 19. DEVELOPER MAY CHOOSE
 COMBINATION OF 2.5 AND 3 INCH TREES BUT THE TOTAL CALIPER INCHES TO BE REPLACE MUST BE 55
 INCHES. CALIPER INCHES ARE TO BE REPLACED/PLANTED USING A MINIMUM 2.5 CALIPER INCH NATIVE,
 CANOPY, FL GRADE 1 OR BETTER REPLACEMENT/MITIGATION TREE. THE DEVELOPER MAY ALSO CHOOSE TO
 PAY INTO THE ESCAMBA COUNTY TREE FUND.

TREE PROTECTION NOTES:

1. NO UN-PERMITTED GRADING OR CLEARING BY HEAVY EQUIPMENT SHOULD HAPPEN UNDER THE DRIPLINE OF PROTECTED TREES ON SITE.
2. STORAGE OF HEAVY EQUIPMENT SHALL NOT OCCUR UNDER THE DRIPLINE OF PROTECTED TREES ON SITE.
3. NO PROTECTED TREES INDICATED FOR PRESERVATION SHALL BE REMOVED, DESTRUCTIVELY DAMAGED, MUTILATED, RELOCATED, DISFIGURED, DESTROYED, CUT DOWN OR EXCESSIVELY PRUNED.
4. FOR VIABILITY OF PROTECTED TREES REMAINING ON SITE, THE ROOTS OF 1" DIAMETER OR GREATER SHALL BE CUT CLEANLY WITH APPROPRIATE EQUIPMENT. DO NOT USE EQUIPMENT THAT PULLS AND SHATTERS ROOTS (E.G. BACKHOE). ROOTS SHALL BE PRUNED TO A DEPTH OF 18" BELOW THE EXISTING GRADE OR TO A DEPTH OF DISTURBANCE IF LESS THAN 18" FROM EXISTING GRADE.
5. ALL ADEQUATE TREE PROTECTION MEASURES AND BARRICADES SHALL BE INSTALLED PRIOR TO SITE DISTURBANCE AND MAINTAINED IN GOOD WORKING ORDER UNTIL PROJECT IS COMPLETE AND SITE BECOMES STABILIZED.
6. ALL TREES SHALL BE AT LEAST 2.5" DIAMETER MEASURED AT DBH AT TIME OF PLANTING.
7. ALL DISTURBED AREAS SHALL BE STABILIZED WITH SEED & MULCH AND/OR SOD.
8. ALL DISTURBED AREAS WITHIN THE RIGHT OF WAY TO BE SODDED WITH BERMUDA GRASS.
9. ANY LAND DISTURBING ACTIVITIES, INCLUDING THE PLACEMENT OF FILL/FILL MATERIALS, GRADING, EXCAVATING, ETC. SHALL NOT OCCUR UNTIL SUCH TIME AS APPROPRIATE PERMIT(S) ARE ISSUED FOR THE PROPOSED WORK.

TREE DIVERSITY REQUIREMENTS:

ESCAMBA COUNTY LDC SECTION DSM 2-6.1(C)(2):

THE DIVERSITY OF ANY TREE REQUIRED TO BE PLANTED ON A SITE SHALL COMPLY WITH THE FOLLOWING LIMITS TO AVOID UNIFORM SITE TREE DECLINE FROM PESTS OR DISEASE:

- 5-19 NEW TREES = 67% MAXIMUM PERCENTAGE OF ANY ONE SPECIES
- 20-49 NEW TREES = 40% MAXIMUM PERCENTAGE OF ANY ONE SPECIES
- 50 OR MORE NEW TREES = 30% MAXIMUM PERCENTAGE OF ANY ONE SPECIES

22 NEW TREES TO BE PLANTED = 40% MAXIMUM PERCENTAGE OF ANY ONE SPECIES

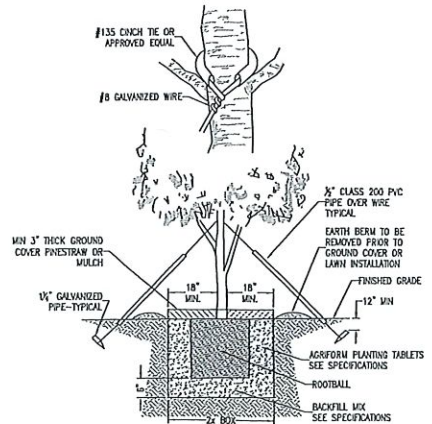

TREE PLANTING DETAIL

LEGEND

- EXISTING ASPHALT
- EXISTING CONCRETE
- PROPOSED ASPHALT
- PROPOSED CONCRETE
- EXISTING CHAIN LINK FENCE
- EXISTING WOODEN FENCE
- BOUNDARY LINE
- LOT LINE
- RIGHT-OF-WAY LINE

LEGEND

- EXISTING TREE
- DENOTES PROPOSED PARKING ROW TERMINUS TREE SOUTHERN MAGNOLIA OR APPROVED EQUAL (MIN. 2.5" DIAMETER AT BREAST HEIGHT) (MATURE HEIGHT > 30 FEET) TOTAL REQUIRED = 7
- DENOTES PROPOSED MITIGATION TREE. LIVE OAK, SAND OAK, RED BUD OR APPROVAL-EQUAL (MIN. 2.5" DIAMETER AT BREAST HEIGHT) (MATURE HEIGHT > 30 FT) TOTAL REQUIRED = 22

RBA
 REBOL-BATTLE & ASSOCIATES
 Civil Engineers and Surveyors
 2301 N. Ninth Avenue, Suite 300
 Pensacola, Florida 32503
 Telephone: 850.438.0400 Fax: 850.438.0448
 E3 00028527 LP1916

LANDSCAPE, STRIPING AND SIGNAGE PLAN

Ely Road Spec Warehouse
 8765 Ely Road
 Escambia County, Florida

No.	DATE	REVISION	ESCO/OWNER COMMENTS
1	04-23-2020		

SEAL
 PERMIT DRAWINGS
 No. 53126
 Paul A. Battle, P.E.
 License No. 53126
 Drawn By: GTF
 Checked By: PAB
 Job No.: 2016.204
 Date: 03-26-2020
 DRAWING No. 1
C5.0
 SHEET 12 OF 12