

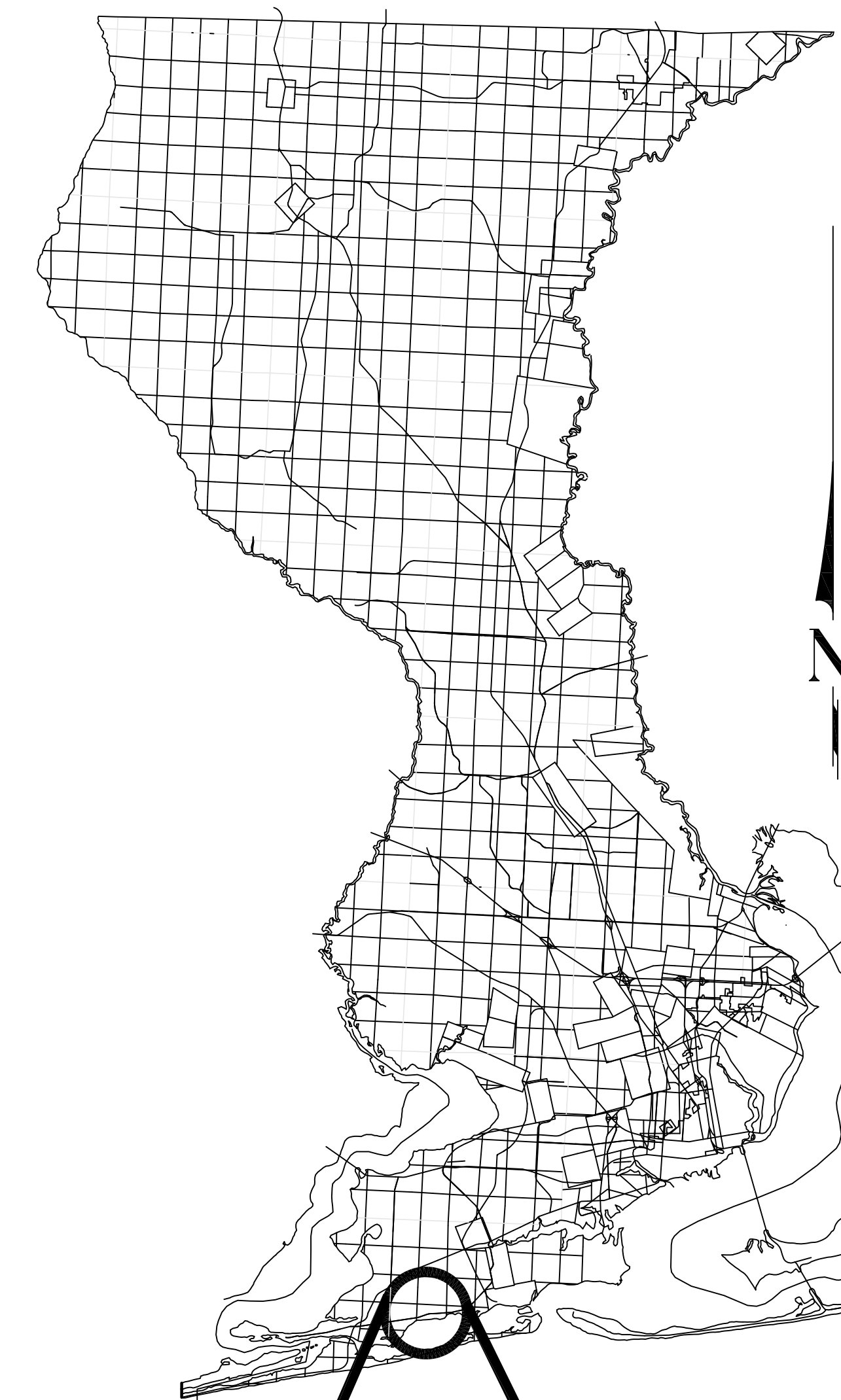

BOARD OF COUNTY COMMISSIONERS
ESCAMBIA COUNTY, FLORIDA
PUBLIC WORKS DEPARTMENT
ENGINEERING / INFRASTRUCTURE DIVISION

LAP FINANCIAL PROJECT ID 436251-2-58-01 (FEDERAL FUNDS)



INDEX OF PLANS

SHEET NO.	SHEET DESCRIPTION
1	OVERALL PLAN AND GENERAL NOTES
2	GULF BEACH HIGHWAY
3	GULF BEACH HIGHWAY
4	GULF BEACH HIGHWAY
5	GULF BEACH HIGHWAY
6	GULF BEACH HIGHWAY
7	GULF BEACH HIGHWAY
8	PONTE VERDE BOULEVARD
9	GULF BEACH HIGHWAY
10	GULF BEACH HIGHWAY
11	LEEWARD DRIVE
12	LEEWARD DRIVE
13	GULF BEACH HIGHWAY
14	GULF BEACH HIGHWAY
15	SANCHEZ LANE
16	CASA MARIA LANE
17	SINTON DRIVE
18	SINTON DRIVE
19	COMSTOCK AVENUE
20	NELLIE AVENUE
21	NELLIE AVENUE
22	REDONDO STREET AND BERTHA STREET
23	CHANTICLEER OUTFALL
24	WINGATE OUTFALL
25	LEEWARD DRIVE OUTFALL
26	SANCHEZ LANE OUTFALL
27	BIG LAGOON OUTFALL
28	SHOREWOOD SUBDIVISION AND LEEWARD DR TO SANCHEZ LN OUTFALL
29	NORTH LINE SECTION 24 OUTFALL
30	QUINAVISTA OUTFALL
31	CONSTRUCTION DETAILS
32	CONSTRUCTION DETAILS
33	CONSTRUCTION DETAILS
34	CONSTRUCTION DETAILS
35	CONSTRUCTION DETAILS
36	GARCON SWAMP STUDY

PHASE 1
CONSTRUCTION PLANS
 FOR
ESCAMBIA COUNTY
DRAINAGE IMPROVEMENTS
 ALONG
GULF BEACH HIGHWAY

FLOOD 2014

REVISED 4/19/16

DATE: JANUARY, 1995

COMMISSIONERS

- | | |
|----------------|------------------|
| DISTRICT ONE | WILSON ROBERTSON |
| DISTRICT TWO | DOUG UNDERHILL |
| DISTRICT THREE | LUMON MAY |
| DISTRICT FOUR | GROVER ROBINSON |
| DISTRICT FIVE | STEVEN BARRY |

BLUE ANGEL HIGHWAY
 SORRENTO ROAD
 BAUER ROAD
 GULF BEACH HIGHWAY

VICINITY MAP



THESE PLANS HAVE BEEN PREPARED IN ACCORDANCE WITH THE FLORIDA GREEN BOOK (DATED MAY 2002), THE FLORIDA DEPARTMENT OF TRANSPORTATION STANDARD SPECIFICATIONS FOR ROAD & BRIDGE CONSTRUCTION (DATED JULY 2015), THE FLORIDA DEPARTMENT OF TRANSPORTATION DESIGN STANDARDS (DATED JANUARY 2016), AND THE LATEST ESCAMBIA COUNTY STANDARD SPECIFICATIONS.

ANY REFERENCE TO FDOT STANDARD SPECIFICATIONS FOR ROAD AND BRIDGE CONSTRUCTION, LATEST EDITION, DIVISION I, GENERAL REQUIREMENTS AND COVENANTS, SHALL BE EXCLUDED AND NOT APPLICABLE TO ANY SPECIFICATION REFERED HEREIN OR OTHERWISE LISTED IN THESE PLANS OR RELATED DOCUMENTS OR THE ESCAMBIA COUNTY TECHNICAL SPECIFICATIONS.

**100% SUBMITTAL
FOR BIDDING PURPOSES ONLY**

PROJECT NUMBER: ENGFLOOD0414-87	
PROJECT MANAGER: NICK CHAUVIN	
SECTION / TOWNSHIP / RANGE: 22 / 3S / 31W	DISTRICT: 2
PROJECT ENGINEER: STEVE GECL, P.E.	REG FLA ENG NO: 33658
SIGNATURE:	DATE:

S:\PROJECTS CURRENT\26407 Gulf Beach Highway Drainage Repairs\Drawing\26407 Repair Plans.dwg, Apr 19, 2016 - 3:07:30PM, Clint

- THE LOCATION SHOWN FOR EXISTING UNDERGROUND UTILITIES IS APPROXIMATE. THE CONTRACTOR SHALL DETERMINE THE EXACT LOCATION OF ALL EXISTING UTILITIES BEFORE COMMENCING WORK IN EACH AREA. THE CONTRACTOR AGREES TO BE COMPLETELY RESPONSIBLE FOR ALL DAMAGES WHICH MIGHT OCCUR BY HIS FAILURE TO EXACTLY LOCATE AND PRESERVE ALL UTILITIES.
- UTILITY OWNERS SHALL BE NOTIFIED AT LEAST 48 HOURS PRIOR TO ANY CONSTRUCTION SO THAT THE UTILITY OWNER CAN SPOT VERIFY AND/OR EXPOSE THEIR UTILITIES. KNOWN UTILITIES OWNERS INCLUDE:

SEWER/WATER - EMERALD COAST UTILITY AUTHORITY MR. MIKE HAMLIN P.O. BOX 15311 PENSACOLA, FL 32514 PH: (850) 969-3310	ELECTRIC - GULF POWER MR. CHAD SWALLS 5120 DOGWOOD DRIVE MILTON, FL 32570 PH: (850) 429-2446
NATURAL GAS - ENERGY SERVICES OF PENSACOLA MR. GLENN BAILEY 1625 ATWOOD DRIVE PENSACOLA, FL 32514 PH: (850) 474-5310	CABLE - COX CABLE MR. TROY YOUNG 2421 EXECUTIVE PLAZA PENSACOLA, FL 32504 PH: (850) 857-4564
TELEPHONE - AT&T FLORIDA MR. STAN WRIGHT 605 WEST GARDEN STREET PENSACOLA, FL 32501 PH: (850) 436-1488	SUNSHINE STATE ONE-CALL 7200 LAKE ELLENOR DRIVE, SUITE 200 ORLANDO, FL 32809 PH: (800) 432-4770
ESCAMBIA COUNTY, TRAFFIC SIGNAL UTILITY SPOTS MS. JOHNNY COX 3363 WEST PARK PLACE PENSACOLA, FL 32505 PH:(850) 595-3484	
- AT&T FLORIDA WILL COMPLETE ALL WORK DURING THE HOURS OF 7:30 AM - 4:30 PM, MONDAY THRU FRIDAY. NO NIGHT OR WEEKEND WORKWORK.
- ALL CABLE DAMAGE MUST BE REPORTED TO THE ATT FLORIDA REPAIR SERVICE DEPARTMENT AT 611 FROM A LAND LINE OR 877-737-2478 IF USING A CELL PHONE.
- ALL LOOP DETECTOR INSTALLATION SHALL BE DONE AS PER FDOT INDEX 17781.
- CONTRACTOR IS TO USE CAUTION WHEN WORKING IN OR AROUND AREAS OF OVERHEAD TRANSMISSION LINES AND UNDERGROUND UTILITIES.
- UTILITIES TO REMAIN AND BE PROTECTED DURING CONSTRUCTION. NECESSARY REPAIRS SHALL BE CONSIDERED INCIDENTAL TO OTHER PAY ITEMS AND SHALL BE TO THE SATISFACTION OF UTILITY OWNERS.

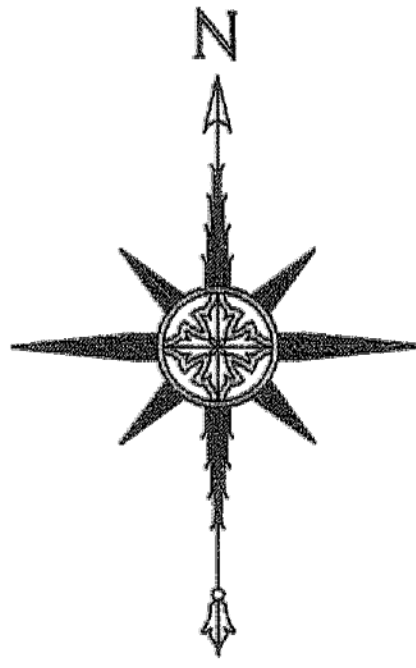
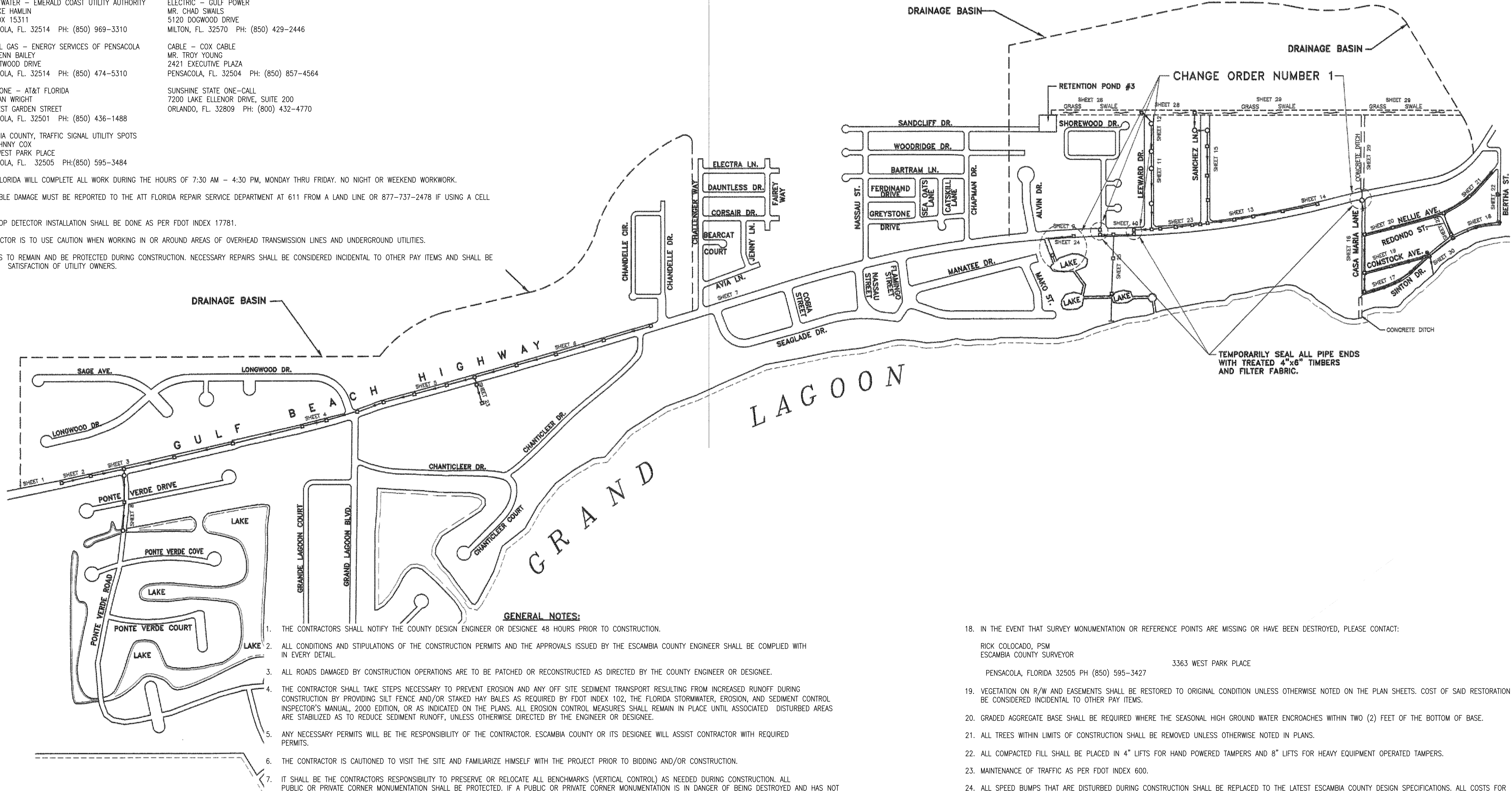

GENERAL NOTES:

- THE CONTRACTORS SHALL NOTIFY THE COUNTY DESIGN ENGINEER OR DESIGNEE 48 HOURS PRIOR TO CONSTRUCTION.
- ALL CONDITIONS AND STIPULATIONS OF THE CONSTRUCTION PERMITS AND THE APPROVALS ISSUED BY THE ESCAMBIA COUNTY ENGINEER SHALL BE COMPLIED WITH IN EVERY DETAIL.
- ALL ROADS DAMAGED BY CONSTRUCTION OPERATIONS ARE TO BE PATCHED OR RECONSTRUCTED AS DIRECTED BY THE COUNTY ENGINEER OR DESIGNEE.
- THE CONTRACTOR SHALL TAKE STEPS NECESSARY TO PREVENT EROSION AND ANY OFF SITE SEDIMENT TRANSPORT RESULTING FROM INCREASED RUNOFF DURING CONSTRUCTION BY PROVIDING SILT FENCE AND/OR STAKED HAY BALES AS REQUIRED BY FDOT INDEX 102, THE FLORIDA STORMWATER, EROSION, AND SEDIMENT CONTROL INSPECTOR'S MANUAL, 2000 EDITION, OR AS INDICATED ON THE PLANS. ALL EROSION CONTROL MEASURES SHALL REMAIN IN PLACE UNTIL ASSOCIATED DISTURBED AREAS ARE STABILIZED AS TO REDUCE SEDIMENT RUNOFF, UNLESS OTHERWISE DIRECTED BY THE ENGINEER OR DESIGNEE.
- ANY NECESSARY PERMITS WILL BE THE RESPONSIBILITY OF THE CONTRACTOR. ESCAMBIA COUNTY OR ITS DESIGNEE WILL ASSIST CONTRACTOR WITH REQUIRED PERMITS.
- THE CONTRACTOR IS CAUTIONED TO VISIT THE SITE AND FAMILIARIZE HIMSELF WITH THE PROJECT PRIOR TO BIDDING AND/OR CONSTRUCTION.
- IT SHALL BE THE CONTRACTORS RESPONSIBILITY TO PRESERVE OR RELOCATE ALL BENCHMARKS (VERTICAL CONTROL) AS NEEDED DURING CONSTRUCTION. ALL PUBLIC OR PRIVATE CORNER MONUMENTATION SHALL BE PROTECTED. IF A PUBLIC OR PRIVATE CORNER MONUMENTATION IS IN DANGER OF BEING DESTROYED AND HAS NOT BEEN PROPERLY REFERENCED, THE CONTRACTOR SHALL NOTIFY THE ENGINEER OR DESIGNEE IMMEDIATELY. ANY ESCAMBIA COUNTY HARN/GPS NETWORK MONUMENTS OR BUREAU OF SURVEY AND MAPPING GPS NETWORK MONUMENTS WITHIN THE LIMITS OF CONSTRUCTION SHALL BE PROTECTED. IF A HARN/GPS NETWORK MONUMENTS OR BUREAU OF SURVEY AND MAPPING GPS NETWORK MONUMENTS ARE DISTURBED OR DESTROYED THE CONTRACTOR SHALL BE RESPONSIBLE FOR REPLACEMENT OF THE MONUMENTS AND HAVE THE MONUMENTS POSITION DETERMINED BY A FLORIDA LICENSED PROFESSIONAL SURVEYOR AND MAPPER USING GUIDELINES AS ESTABLISHED BY NATIONAL GEODETIC SURVEY FOR BLUE BOOKING AND APPROVAL.
- EXISTING DRAINAGE FEATURES WITHIN CONSTRUCTION LIMITS SHALL REMAIN UNLESS OTHERWISE NOTED.
- THE CONTRACTOR SHALL MATCH EXISTING CONDITIONS AT THE BEGINNING AND END OF CONSTRUCTION AS DIRECTED BY THE COUNTY ENGINEER OR DESIGNEE.
- EXISTING STREETS AND DRIVES SHALL BE MAINTAINED TO LOCAL TRAFFIC AND PROPERTY OWNERS.
- ALL ROADWAY CONSTRUCTION SHALL COMPLY WITH THE ESCAMBIA COUNTY TECHNICAL SPECIFICATIONS, LATEST EDITION.
- ALL MATERIALS, TESTING AND CONSTRUCTION METHODS SHALL CONFORM TO THE ESCAMBIA COUNTY TECHNICAL SPECIFICATIONS, LATEST EDITION.
- ANY REFERENCE TO FDOT STANDARD SPECIFICATIONS FOR ROAD AND BRIDGE CONSTRUCTION, LATEST EDITION, DIVISION 1, GENERAL REQUIREMENTS AND COVENANTS, SHALL BE EXCLUDED AND NOT APPLICABLE TO ANY SPECIFICATION REFERRED HEREIN OR OTHERWISE LISTED IN THESE PLANS OR RELATED DOCUMENTS OR THE ESCAMBIA COUNTY TECHNICAL SPECIFICATIONS.
- EXISTING STREET AND ROAD NAME SIGNS ON THE PROJECT SHALL BE KEPT VISIBLE AT ALL TIMES FOR THE FACILITATION OF ACCESS BY EMERGENCY VEHICLES. ALL OTHER EXISTING SIGNS THAT CONFLICT WITH CONSTRUCTION OPERATIONS SHALL BE TAKEN DOWN AND STOCKPILED WITHIN THE R/W LIMITS BY THE CONTRACTOR AS DIRECTED BY THE COUNTY ENGINEER OR DESIGNEE. ANY EXISTING SIGNS THAT ARE TO BE RELOCATED AND ARE DAMAGED BEYOND USE BY THE CONTRACTOR SHALL BE REPLACED BY THE CONTRACTOR AT HIS EXPENSE.
- THE CONTRACTOR SHALL MAINTAIN AT LEAST ONE 10' OPEN LAKE AT ALL TIMES. NO OPEN EXCAVATION SHALL REMAIN OVER NIGHT. CONTRACTOR SHALL RESTORE ROAD TO TWO LANES OF TRAFFIC AT THE END OF EACH WORK DAY.
- CONTRACTOR SHALL COMPLY WITH ALL F.D.E.P. AND ARMY CORP. OF ENGINEERS REQUIREMENTS.
- ONLY ACCESS TO THE ROAD R/W AS SHOWN IS GUARANTEED BY THE COUNTY. PRIVATE R/W REQUIRED BY THE CONTRACTOR TO FACILITATE CONSTRUCTION SHALL BE ACQUIRED BY THE CONTRACTOR WITH NO ADDITIONAL COMPENSATION OR ASSISTANCE FROM THE COUNTY.

- IN THE EVENT THAT SURVEY MONUMENTATION OR REFERENCE POINTS ARE MISSING OR HAVE BEEN DESTROYED, PLEASE CONTACT:

RICK COLOCADO, PSM
ESCAMBIA COUNTY SURVEYOR
PENSACOLA, FLORIDA 32505 PH (850) 595-3427
- VEGETATION ON R/W AND EASEMENTS SHALL BE RESTORED TO ORIGINAL CONDITION UNLESS OTHERWISE NOTED ON THE PLAN SHEETS. COST OF SAID RESTORATION SHALL BE CONSIDERED INCIDENTAL TO OTHER PAY ITEMS.
- GRADED AGGREGATE BASE SHALL BE REQUIRED WHERE THE SEASONAL HIGH GROUND WATER ENCROACHES WITHIN TWO (2) FEET OF THE BOTTOM OF BASE.
- ALL TREES WITHIN LIMITS OF CONSTRUCTION SHALL BE REMOVED UNLESS OTHERWISE NOTED IN PLANS.
- ALL COMPACTED FILL SHALL BE PLACED IN 4" LIFTS FOR HAND POWERED TAMPERS AND 8" LIFTS FOR HEAVY EQUIPMENT OPERATED TAMPERS.
- MAINTENANCE OF TRAFFIC AS PER FDOT INDEX 600.
- ALL SPEED BUMPS THAT ARE DISTURBED DURING CONSTRUCTION SHALL BE REPLACED TO THE LATEST ESCAMBIA COUNTY DESIGN SPECIFICATIONS. ALL COSTS FOR REPLACEMENT OF SAID SPEED BUMPS SHALL BE INCIDENTAL TO OTHER ITEMS AND NO ADDITIONAL COMPENSATION SHALL BE CONSIDERED.
- ALL EXISTING MAILBOXES INTERFERING WITH NEW CONSTRUCTION SHALL BE RELOCATED OR REPLACED BY THE CONTRACTOR IN ACCORDANCE WITH POSTAL REQUIREMENTS AND IN ACCORDANCE WITH ESCAMBIA COUNTY TECHNICAL SPECIFICATION, FDOT DESIGN STANDARDS AND UNITED POSTAL REQUIREMENTS. ALL EXISTING BRICK MAILBOXES WITHIN LIMITS OF CONSTRUCTION OR COUNTY RIGHT OF WAY SHALL BE REMOVED AND PLACED ON THE PROPERTY LINE OF THE OWNER. CONTRACTOR SHALL REPLACE EXISTING BRICK MAILBOX WITH APPROVED PLASTIC BREAK AWAY MAILBOX.
- THE CONTRACTOR SHALL, AT A MINIMUM, MATCH EXISTING SIGNING AND PAVEMENT MARKINGS. ALL SIGNING AND PAVEMENT MARKINGS SHALL BE PLACED IN ACCORDANCE WITH THE LATEST FDOT DESIGN STANDARDS. THE CONTRACTOR SHALL CONTACT THE COUNTY TRAFFIC DEPARTMENT PRIOR TO INSTALLATION OF ANY SIGNING AND PAVEMENT MARKINGS.
- WHERE UNSUITABLE MATERIAL, AS DEFINED BY THE COUNTY SPECIFICATIONS SECTION 02300, 1.3(i), IS ENCOUNTERED IN THE AREAS PROPOSED FOR PAVING, THE CONTRACTOR SHALL IMMEDIATELY NOTIFY THE COUNTY ENGINEER OR DESIGNEE PRIOR TO ANY EXCAVATION.
- PIPE LENGTHS SHOWN IN THE PLANS DO NOT INCLUDE THE LENGTH OF PIPE THAT MUST BE INSTALLED WITH THE MITERED END SECTION. THEREFORE, ALL PIPES LENGTHS ASSOCIATED WITH MITERED END SECTIONS SHALL BE PAID FOR IN THE UNIT COST OF THE MITERED END SECTION.
- ALL SIDEWALK CONSTRUCTION SHALL COMPLY WITH THE 2010 ADA STANDARDS FOR ACCESSIBLE DESIGN.
- ESCAMBIA COUNTY IS NOT PART OF "SUNSHINE STATE ONE CALL" AND SHALL BE NOTIFIED PRIOR TO CONSTRUCTION AT THE ABOVE CONTACT INFORMATION.
- ALL BUS STOPS IN THE ROUTE OF THIS PROJECT MUST BE BROUGHT UP TO ADA COMPLIANCES. IN ADDITION, BUS STOPS SHOULD MEET THE MOST CURRENT ESCAMBIA COUNTY DESIGN STANDARDS AND PROWAG GUIDELINES.
- THESE PLANS WERE PREPARED USING RECORD DRAWINGS AND RECENT IMPROVEMENTS ARE NOT SHOWN. LOCATION OF EXISTING UTILITIES HAVE NOT BEEN VERIFIED. THE CONTRACTOR SHALL DETERMINE THE EXACT LOCATION OF ALL EXISTING UTILITIES BEFORE COMMENCING WORK, AND IS FULLY RESPONSIBLE FOR ANY AND ALL DAMAGES THAT MIGHT BE OCCASIONED BY THE CONTRACTOR'S FAILURE TO EXACTLY LOCATE AND PRESERVE ANY AND ALL ABOVE GROUND AND UNDERGROUND UTILITIES.

APPR.	DATE	REVISION	NO.	REVISED	NO.	DATE
	4/19/16		3	GULF BEACH HWY PIPE REPAIRS	4	
GECI & ASSOCIATES, INC. ENGINEERS 5 S. PALATKOF PLACE, PENSACOLA, FL 32501 Phone (850) 432-2929 - Fax (850) 432-2875 E-Mail - geci@geci.com			DESIGNED	ELH	DRAWN	LCW
SCALE	N.T.S.	CHECKED				
RELEASED FOR CONSTRUCTION BY			SAG	DATE		
CHANGE ORDER NO. 1 OVERALL PLAN AND GENERAL NOTES GULF BEACH HIGHWAY DRAINAGE PROJECT ESCAMBIA COUNTY, FL.						
PROJECT NO.	SHEET NO.					
940401	1 OF 35					

S:\PROJECTS CURRENT\26407 Gulf Beach Highway Drainage Repairs\Drawing\26407 Repair Plans.dwg, Apr 19, 2016 - 3:08:48PM, Clint

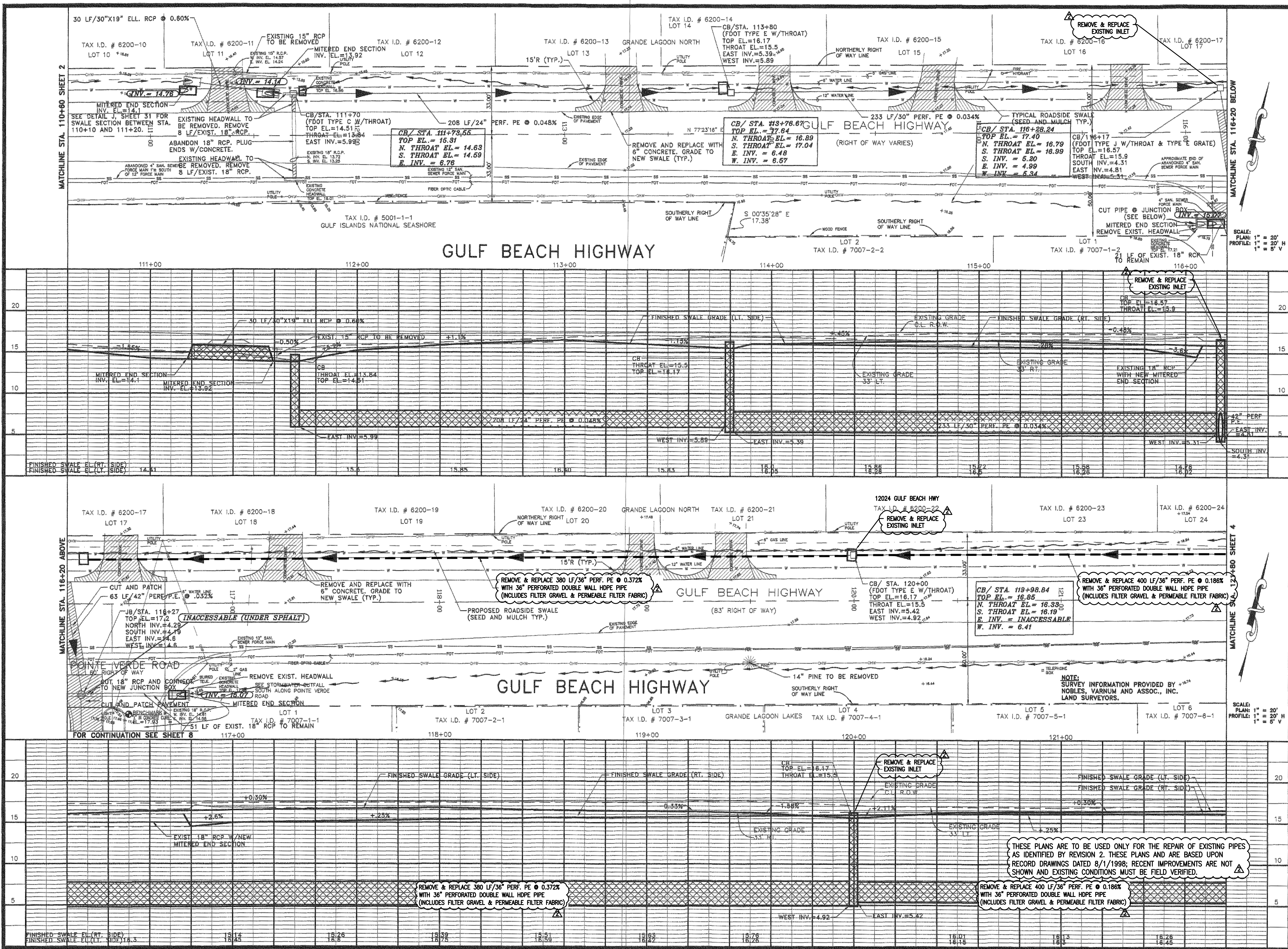

DATE	APPR.	NO.	REVISION
5/3/96		3	GULF BEACH HWY PIPE REPAIRS
4/19/16		4	
		5	

GECI & ASSOCIATES, INC.
 ENGINEERS
 5 S. PALMROY PLACE, PENSACOLA, FL 32501
 Phone (850) 432-2929 • Fax (850) 432-2875
 Email - geci@geci.com

SCALE: H: 1" = 20'
 V: 1" = 5'

THESE PLANS ARE TO BE USED ONLY FOR THE REPAIR OF EXISTING PIPES AS IDENTIFIED BY REVISION 2. THESE PLANS AND ARE BASED UPON RECORD DRAWINGS DATED 8/1/1998; RECENT IMPROVEMENTS ARE NOT SHOWN AND EXISTING CONDITIONS MUST BE FIELD VERIFIED.

PROJECT NO. SHEET NO.
 940401 3 OF 36

S:\PROJECTS CURRENT\26407 Gulf Beach Highway Drainage Repairs\Drawing\26407 Repair Plans.dwg, Apr 19, 2016 - 3:10:03PM, Clint

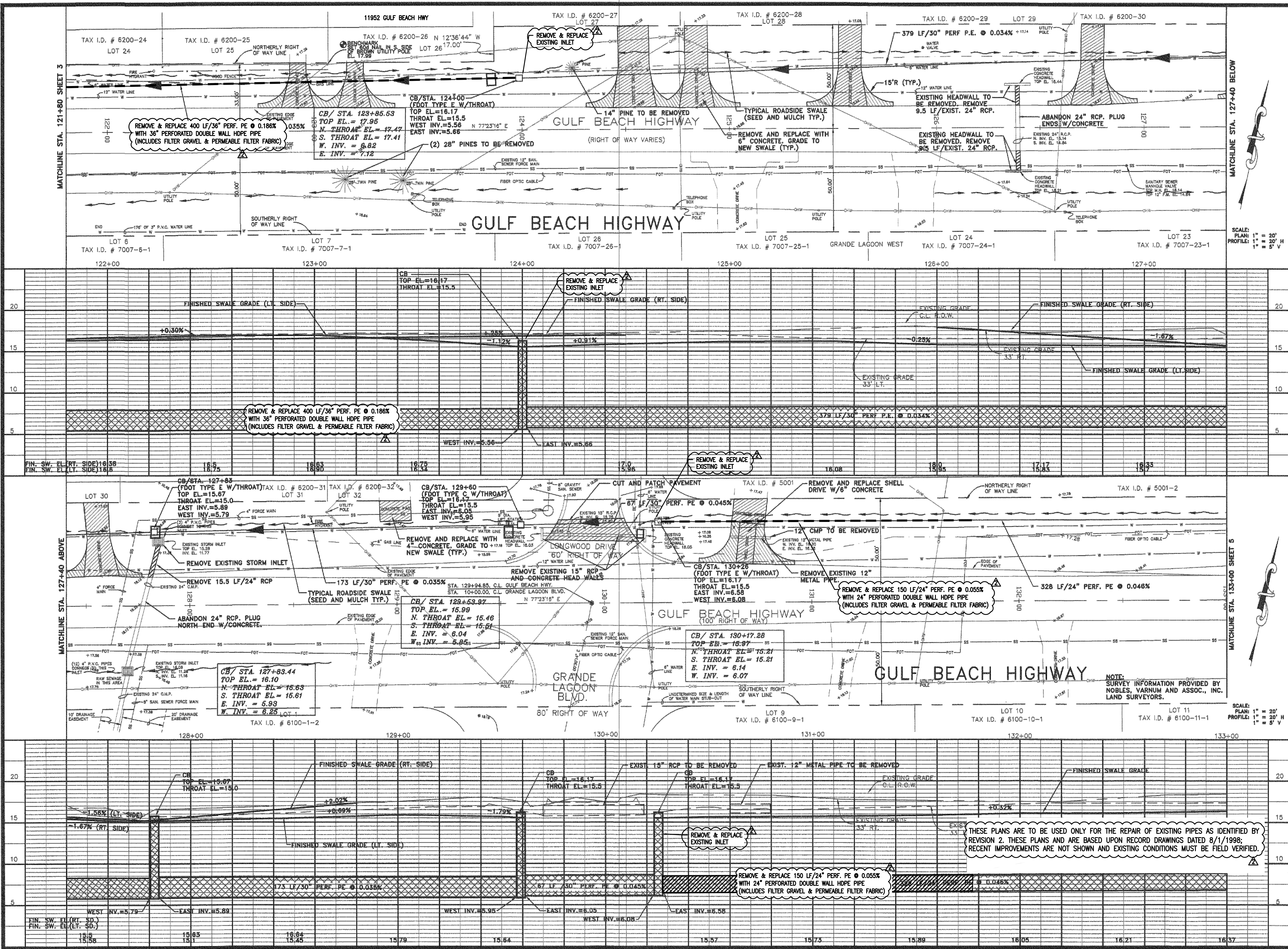

DATE	APPR.	5/3/96
REVISION	REVISED	4/19/16
NO.	DESCRIPTION	
1	GULF BEACH HWY PIPE REPAIRS	
2		
3		
4		
5		

GECI & ASSOCIATES, INC.
 ENGINEERS
 5 S. PALAFOX PLACE, PENSACOLA, FL 32501
 Phone: (850) 432-2929 - Fax: (850) 432-2875
 E-Mail: geci@geci.com

SCALE: PLAN: 1" = 20' H
 PROFILE: 1" = 5' V

THESE PLANS ARE TO BE USED ONLY FOR THE REPAIR OF EXISTING PIPES AS IDENTIFIED BY REVISION 2. THESE PLANS AND ARE BASED UPON RECORD DRAWINGS DATED 8/1/1998; RECENT IMPROVEMENTS ARE NOT SHOWN AND EXISTING CONDITIONS MUST BE FIELD VERIFIED.

PROJECT NO. 940401 SHEET NO. 4 OF 36

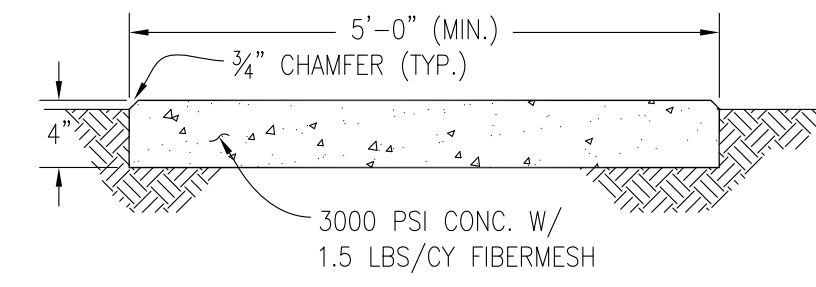
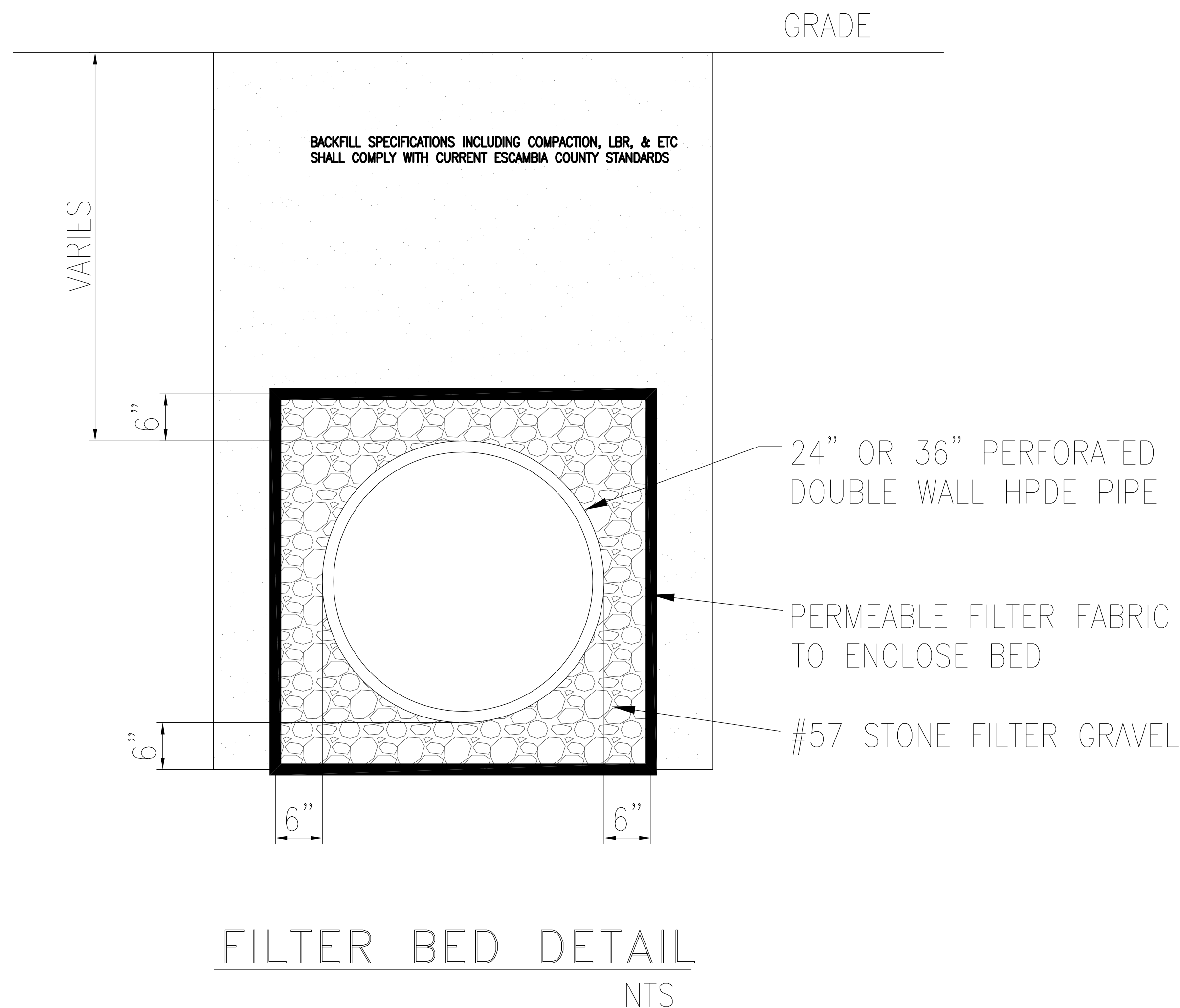

SIDEWALK NOTE :

ALL SIDEWALKS CONSTRUCTED IN ESCAMBIA COUNTY SHALL MEET THE FOLLOWING REQUIREMENTS:

- A. THE CONCRETE SHALL HAVE A MINIMUM STRENGTH OF TWO THOUSAND, FIVE HUNDRED (3,000) POUNDS PER SQUARE INCH (PSI).
- B. THE MINIMUM WIDTH OF SIDEWALKS SHALL NOT BE LESS THAN FIVE (5) FEET.
- C. THE SIDEWALK SHALL NOT BE LESS THAN FOUR (4) INCHES THICK. AT DRIVEWAYS A MINIMUM THICKNESS OF SIX (6) INCHES OR FOUR (4) INCHES WITH WOVEN WIRE FABRIC REINFORCEMENT SHALL BE REQUIRED.
- D. ALL SIDEWALKS SHALL BE CONSTRUCTED WITH A MAXIMUM 2.0% CROSS SLOPE
- E. ONE-HALF (1/2) INCH EXPANSION JOINTS SHALL BE AT THIRTY (30) FOOT INTERVALS OR LESS, WITH CONTROL JOINTS AT TEN (10) FOOT INTERVALS.
- F. LOCATION OF PROPOSED IMPROVEMENTS SUCH AS SIDEWALKS, BIKEWAYS, OR BRIDLE PATHS SHALL BE INCLUDED ON CONSTRUCTION PLANS.

SIDEWALK DETAIL
NOT TO SCALE

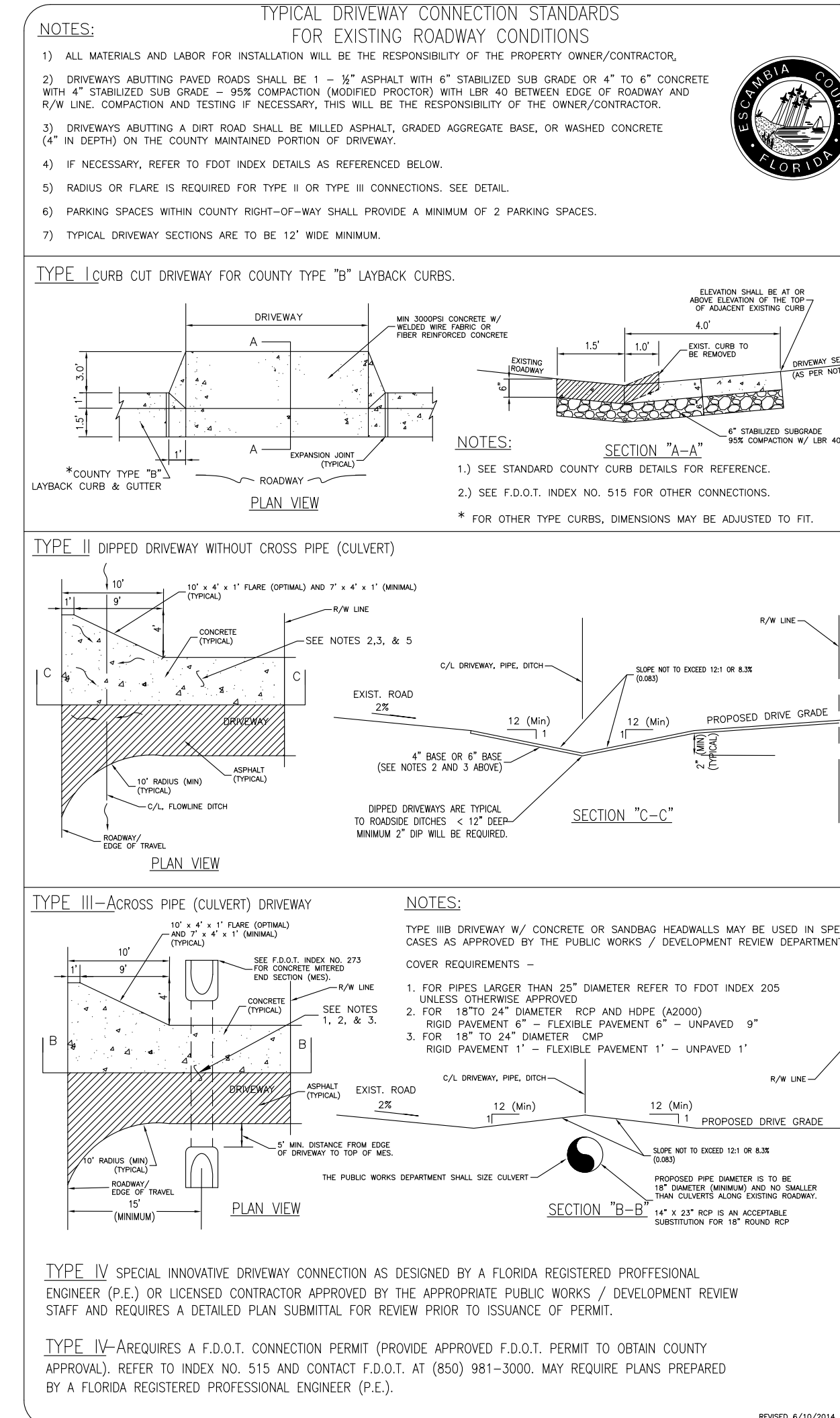

PROJECT NO. 940401 SHEET NO. 31 OF 36	GULF BEACH HIGHWAY SECTION 22-35-31W GULF BEACH HIGHWAY DRAINAGE PROJECT ESCAMBIA COUNT, FL	GECI & ASSOCIATES, INC. ENGINEERS 2950 N. 12th AVE. PENSACOLA, FL 32503 Phone (850) 432-2929 - Fax (850) 432-2875 CERTIFICATE OF REGISTRATION NUMBER 00005149 Email: geci@geciassociates.com	DATE 4/19/16	APPR.
			NO. 3	REVISION
			NO. 4	REVISION
			NO. 5	REVISION
			SCALE: AS SHOWN	DESIGNED: ELH

